

The 2009 RIZOMA catalogue: an extraordinary variety
of specific and individual solutions.



design
& *performance*



design

RIZOMA have constantly sought for a sound quality. Hence, the choice of an excellent raw material together with a considerable technological evolution, has always distinguished our high quality accessories on the market.

The concept Design is composed of Quality and a Unique Style; completed with the "Made in Italy" logo, it has become a synonym of a perceptive artistic imprint and ease of use. Design means "to project": an idea that turns into reality where shape and function meet their utmost implementation. Our accessories, behind their extremely elegant image, conceal a continuous studies of application, material and finishing.

The prototypes realized by our R&D Center, have been studied in order to find the best technical solutions, as well as to render our components reliable and effective. These tests are has been taken over by the professional pilots in extreme conditions in a race track. The 2009 catalogue contains an extraordinary variety of specific accessories, as well as a lot of news: Rizoma has always kept and will keep on looking for a unique quality style.

Have a pleasant view!
Rizoma Staff



enjoy the *racing*
experience



moto gp

RIZOMA is an official sponsor of the French pilot Randy De Puniet in the HONDA LCR Team. The LCR Team has been taking part, for several years already, in the world's most prestigious motorcycle race.

Its founder, Lucio Cecchinello, besides co-operation with high level pilots and excellent technical staff, has succeeded various times in three different categories.

We've decided to sponsor a winning team pilot due to our constant wish to succeed rendering our brand well-known and remarkable.

Rizoma confirm to be a company which always take care of the technological evolution in co-operation with those who base their own experience on the efficacy and innovation.

2009
new accessories



2009 new

"Elisse" mirror

"Senso" mirror

PROGUARD SYSTEM[®]

handlebar cap

engine oil filler caps

bike stand support

Ducati[®] 848

Honda[®] CBR 1000 RR

Honda[®] CB 1000R

Kawasaki[®] ZX-10R

Triumph[®] Speed Triple

Triumph[®] Street Triple

Yamaha[®] YZF-R6

Harley-Davidson[®] VRSC[™]

Harley-Davidson[®] Sportster[®]

custom grips

custom risers

2009 collection

indice	10	universal	mirrors
	44	universal	indicator lights
	52	universal	PROGUARD SYSTEM ®
	56	universal	grips
	60	universal	handlebar caps
	62	universal	risers
	64	universal	handlebars
	66	universal	brake/clutch levers
	70	universal	fluid tanks
	72	universal	brake/clutch fluid caps
	76	universal	engine oil filler caps
	78	universal	engine/fairings guards
	82	universal	license plate supports
	86	universal	rear set control kit
	90	universal	pegs for original rearsets
	92	universal	bike stand support
	94	sport bikes	BMW®
	96	sport bikes	Buell®
	102	sport bikes	Ducati®
	128	sport bikes	Honda®
	150	sport bikes	Kawasaki®
176	sport bikes	KTM®	
182	sport bikes	MV Agusta®	
186	sport bikes	Suzuki®	
198	sport bikes	Triumph®	
210	sport bikes	Yamaha®	
232	custom bikes	Harley-Davidson®	
246	custom bikes	accessories for custom only	
248	legal notice	legal notice and symbol keys	

MIRRORS WITH HOMOLOGATION



elisse
fresh appeal

elisse



BS171AB



BS171AB

BS171B

colors

POSITION	☾	●	€ (EACH)	ADAPTERS
LEFT	BS171AB	BS171B		PAGE 43
RIGHT	BS172AB	BS172B		PAGE 43

info



homologated



design registration # 524939



convex mirror-glass
amber glass*



adapters included

* The "Elisse" mirrors with an "amber" glass are antidazzle and particularly dark, thanks to their hydrophilic properties. In the course of time, in the atmosphere, the glass forms an even water film that improves its visibility. The functional hydrophilic layers are time resistant and light-activated.

MIRRORS WITH HOMOLOGATION



radial sport
racing attitude

radial sport



BS130A



BS130A



BS130B

colors

POSITION	○	●	€ (EACH)	ADAPTERS
BIPOSITION	BS130A	BS130B		PAGE 42

info

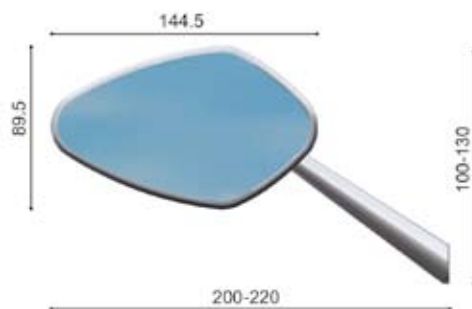

homologated



design registration # 524939



convex mirror-glass
blue mirror-glass



adapters page 42



radial naked
comfortable *feeling*

radial naked



BS134A



BS134A



BS134B



BS134BG

colors

POSITION	○	●	◐	€ (EACH)	ADAPTERS
BIPOSITION	BS134A	BS134B	BS134BG		PAGE 43

info

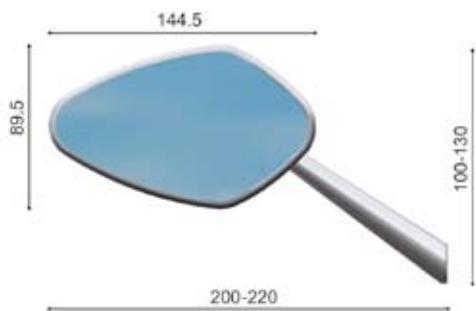

homologated



design registration # 524939



convex mirror-glass
blue mirror-glass



adapters page 43

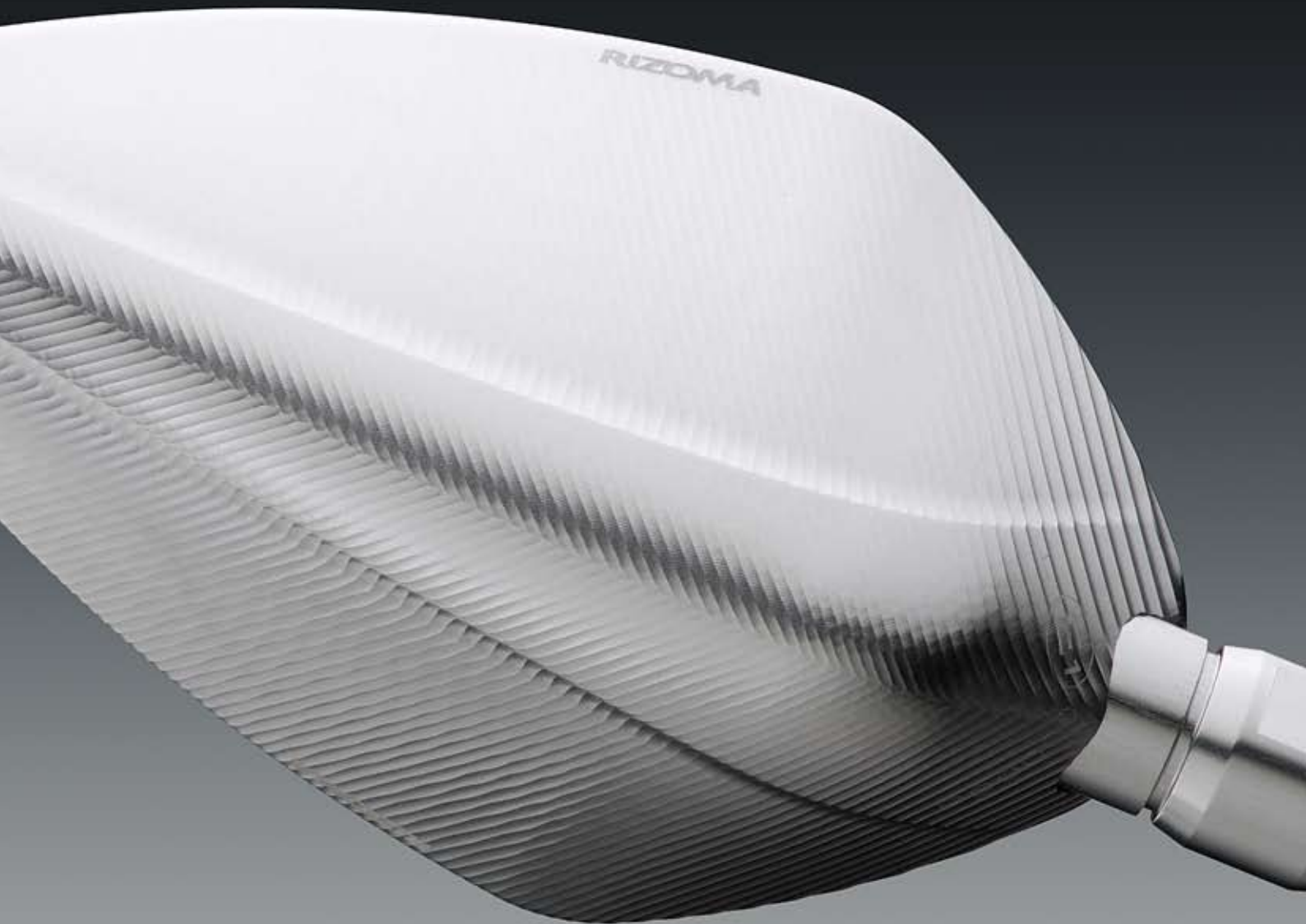

limit sport
tridimensional lines

limit sport



BS150A



BS150A



BS150B

colors

POSITION	○	●	€ (EACH)	ADAPTERS
BIPOSITION	BS150A	BS150B		PAGE 42

info

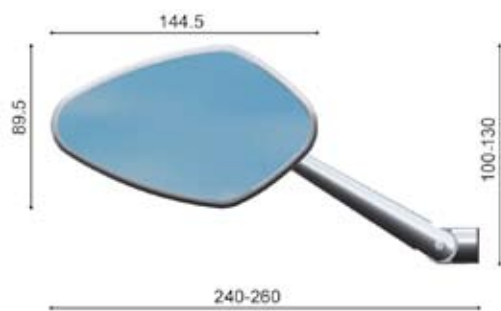

homologated



design registration # 524939



convex mirror-glass
blue mirror-glass



adapters page 42



limit naked
secure edge

limit naked



BS154A



BS154A

BS154B

colors

POSITION	○	●	€ (EACH)	ADAPTERS
BIPOSITION	BS154A	BS154B		PAGE 43

info

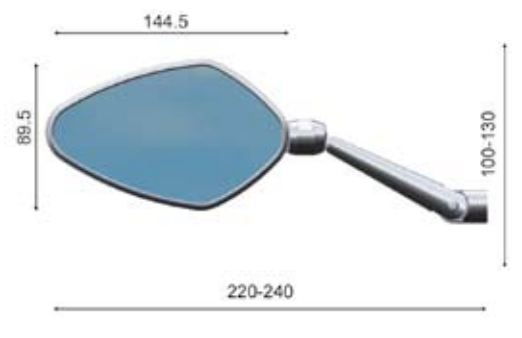

homologated



design registration # 524939



convex mirror-glass
blue mirror-glass



adapters page 43



impulsive
high-tech spirit

impulsive



BS105A



BS105A



BS105B

colors

POSITION	○	●	€ (EACH)	ADAPTERS
BIPOSITION	BS105A	BS105B		PAGE 42-43

info

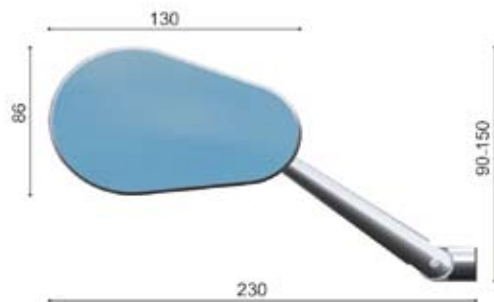

homologated



design registration # 524939



convex mirror-glass
blue mirror-glass



adapters page 42-43



class
elegant *appearance*

class



BS140A



BS140A



BS140B

colors

POSITION	○	●	€ (EACH)	ADAPTERS
BIPOSITION	BS140A	BS140B		PAGE 43

info

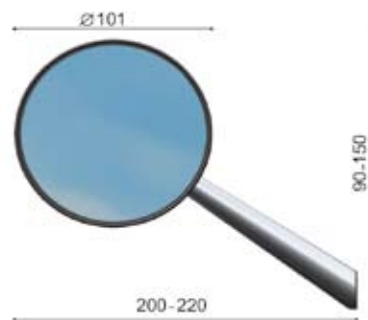

homologated



design registration # 524939



convex mirror-glass
blue mirror-glass



adapters page 43



class retro
timeless *innovation*

class retro



BS144A



BS144A

colors

POSITION	○	€ (EACH)
BIPOSITION	BS144A	

info

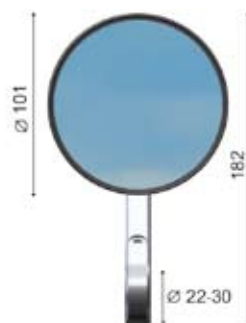

homologated



convex mirror-glass
blue mirror-glass



Use of RIZOMA handlebar
end caps is required.
RIZOMA handlebar end caps:
see page 60.

MIRRORS



senso
new emotion

senso



BS181BL/BS182BL



BS181B/BS182B

BS181BL/BS182BL

BS181EB/BS182EB

colors

POSITION	●	◐	◑	€ (EACH)	ADAPTERS
LEFT	BS181B	BS181BL	BS181EB		INCLUDED
EIGHT	BS182B	BS182BL	BS182EB		INCLUDED

info

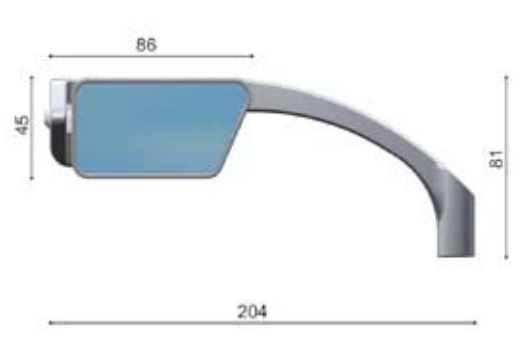

design registration # 524939



blue mirror-glass



adapters included



tomok
cult design

tomok®



BS160A/BS162A



BS160A/BS162A



BS160B/BS162B



BS160BG/BS162BG

colors

POSITION	○	●	◐	€ (EACH)	ADAPTERS
LEFT	BS160A	BS160B	BS160BG		PAGE 43
RIGHT	BS162A	BS162B	BS162BG		PAGE 43

info

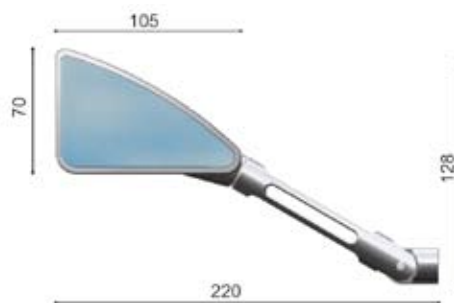

design registration # 524939



blue mirror-glass



adapters page 43



circuit 851
design masterpiece

circuit 851



BS010A/BS011A



BS010A/BS011A



BS010B/BS011B



BS010L/BS011L

colors

POSITION	○	●	●	€ (L'UNITÉ)	ADAPTATEURS
GAUCHE	BS010A	BS010B	BS010L	89,00	INCLUS
DROITE	BS011A	BS011B	BS011L	89,00	INCLUS

info

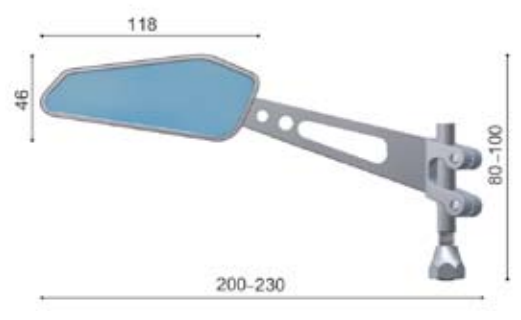

miroir bleu



- Adaptateurs inclus.
- Pour BMW® ancien modèle avec le réservoir d'huile de frein MAGURA® réservoir intégré utiliser BS756A ou BS756B

Ne montent pas avec:

- MV AGUSTA BRUTALE
- DUCATI 696

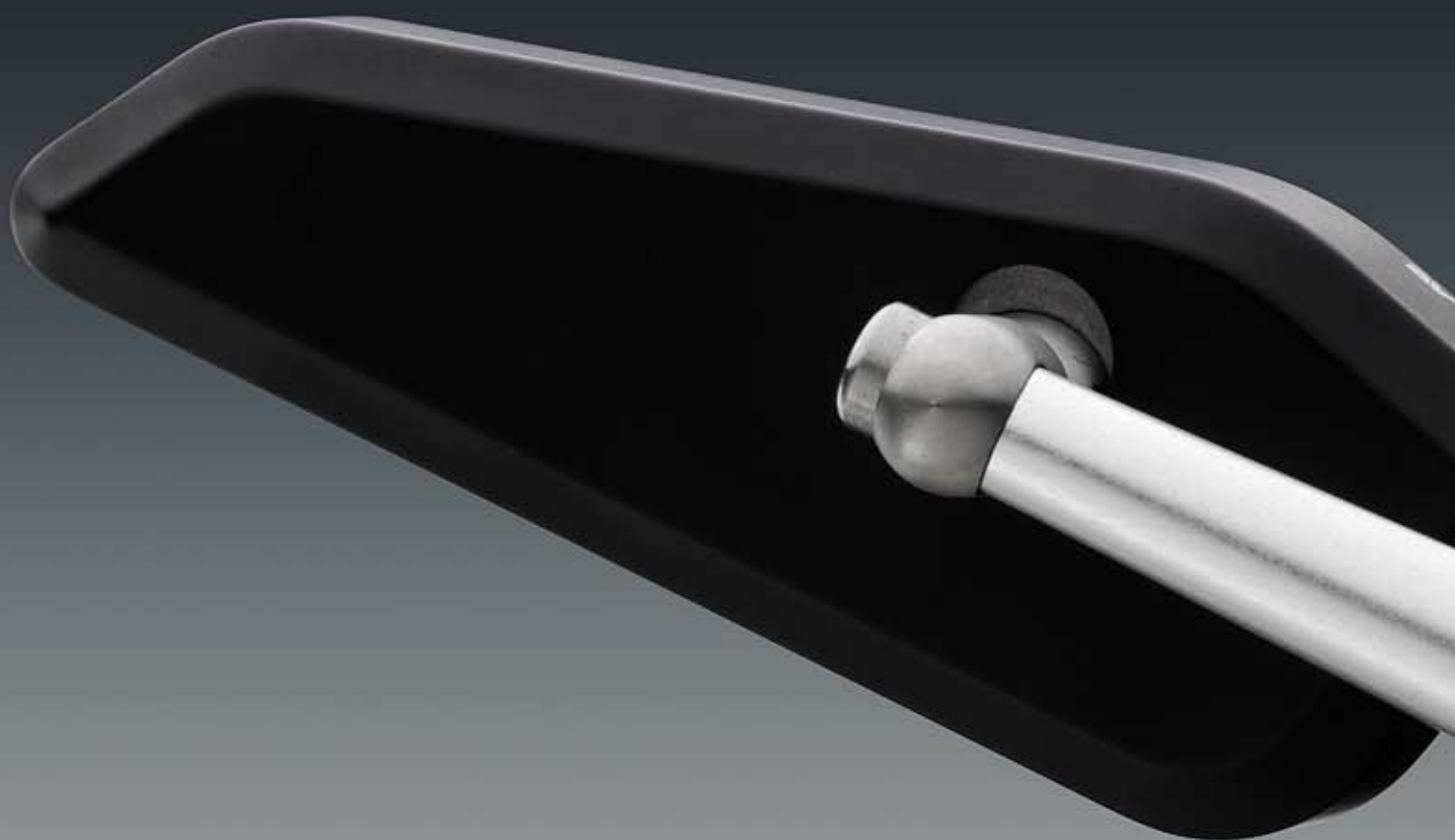

circuit 743
essential *vision*

circuit 743



BS020BA/BS022BA



BS020B/BS022B



BS020BA/BS022BA

colors

POSITION	●	◐	€ (EACH)	ADAPTERS
LEFT	BS020B	BS020BA		PAGE 43
RIGHT	BS022B	BS022 BA		PAGE 43

info

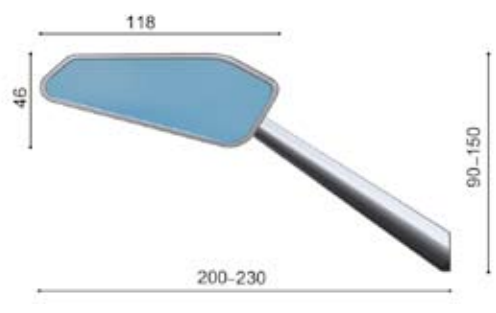

blue mirror-glass



adapters page 43



prototype sport
creative concept

prototype sport



BS110A/BS112A



BS110A/BS112A



BS110B/BS112B

colors

POSITION	○	●	€ (EACH)	ADAPTERS
LEFT	BS110A	BS110B		PAGE 42
RIGHT	BS112A	BS112B		PAGE 42

info

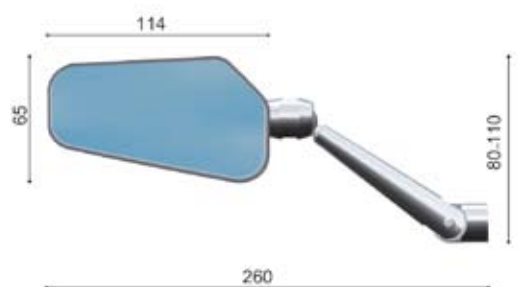

convex mirror-glass
blue mirror-glass



adapters page 42



prototype naked
artistic *model*

prototype naked



BS114A/BS116A

BS114B/BS116B

colors

POSITION	○	●	€ (EACH)	ADAPTERS
LEFT	BS114A	BS114B		PAGE 43
RIGHT	BS116A	BS116B		PAGE 43

info

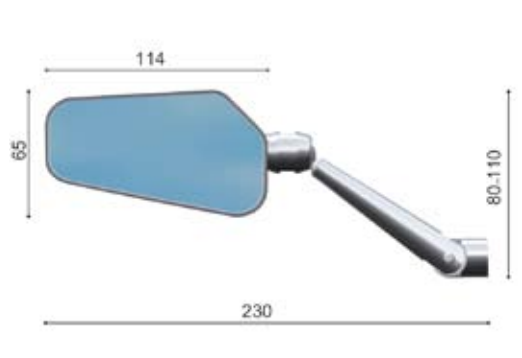

convex mirror-glass
blue mirror-glass



adapters page 43



dynamic
classic *style*

dynamic



BS080A



BS080A



BS080B



BS080L

colors

POSITION	○	●	●	€ (EACH)	ADAPTERS
BIPOSITION	BS080A	BS080B	BS080L		PAGE 43

info

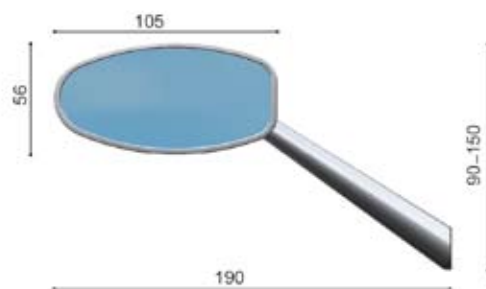

convex mirror-glass
blue mirror-glass



adapters page 43



reverse retro
changeless *beauty*

reverse retro



BS070A



BS070A

BS070B

BS070L

colors

POSITION	○	●	●	€ (EACH)
BIPOSITION	BS070A	BS070B	BS070L	

info



convex mirror-glass
blue mirror-glass



Use of RIZOMA handlebar end caps is required.
RIZOMA handlebar end caps: see page 60.

MIRROR ADAPTERS

info

- SOLD EACH
- SCREWS INCLUDED
- COLOR: BLACK



BIKES WITH FAIRING



HONDA®

MODEL	YEAR	CODE	€ (EACH)
CBR600RR	07>08	BS721B	
CBR600RR	03>06	BS721B	
CBR600F	99>06	BS720B	
CBR600FS	01>02	BS720B	
HORNET CB600S	02>04	BS720B	
CBR900RR	02>04	BS721B	
CBR1000RR	06>07	BS721B	
CBR1000RR	04>05	BS721B	

SUZUKI®

MODEL	YEAR	CODE	€ (EACH)
GSXR 600/750	06>07	BS728B	
GSXR 600/750	04>05	BS726B	
GSXR 600/750	01>03	BS726B	
GSF 600S BANDIT	03>04	BS726B	
SV650S	03>08	BS726B	
GSXR 1000	07>08	BS728B	
GSXR 1000	05>06	BS728B	
GSXR 1000	03>04	BS726B	
GSXR 1000	01>02	BS726B	
SV1000S	03>07	BS726B	
GSF1200 BANDIT	01>05	BS727B	
GSF1200S BANDIT	01>05	BS726B	

KAWASAKI®

MODEL	YEAR	CODE	€ (EACH)
ZX6R	05>06	BS721B	
ZX6R	03>04	BS723B	
ZX6R	02>03	BS722B	
ZX6R	01>02	BS722B	
ER6F	05>08	BS723B	
Z750S	05>06	BS723B	
ZX9R	99>03	BS722B	
ZX10R	06>07	BS721B	
ZX10R	04>05	BS721B	

YAMAHA®

MODEL	YEAR	CODE	€ (EACH)
YZF R6	08>	BS771B	
YZF R6	99>03	BS722B	
YZF R6	06>07	BS724B	
YZF R6	03>05	BS724B	
FZ1 FAZER	06>	BS734B	
YZF R1	07>08	BS724B	
YZF R1	04>06	BS724B	
YZF R1	02>03	BS724B	
YZF R1	00>01	BS722B	

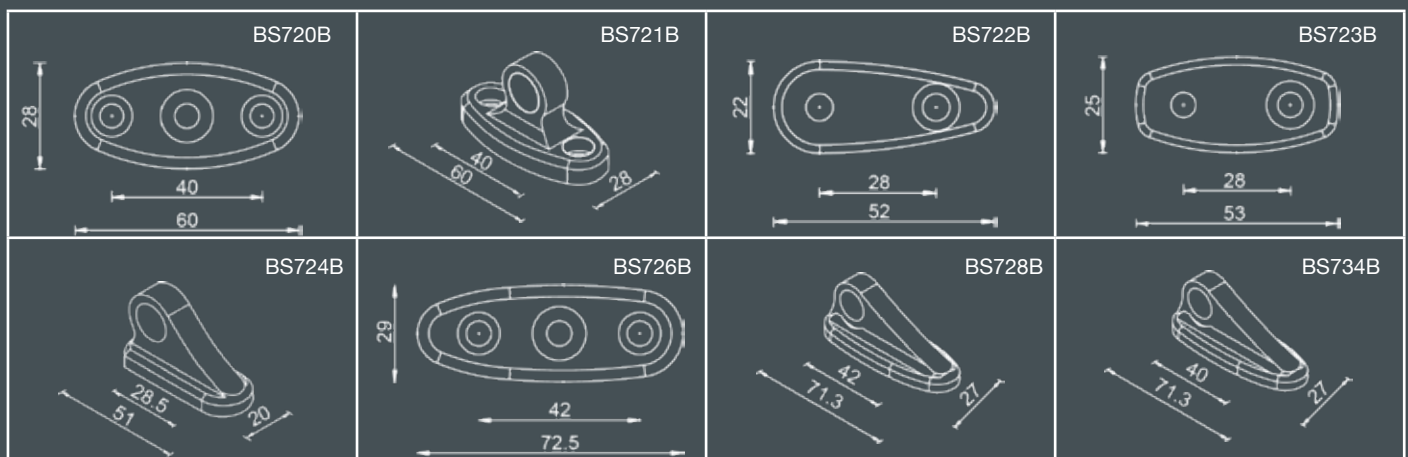

info

- SOLD SEPARATELY
- SCREWS INCLUDED: 10x1.25 - 10x1.25 sx - M8x50
- COLORS: NATURAL AND BLACK

NAKED BIKES



ADAPTERS FOR NAKED BIKES

MODEL	YEAR	○	●	€ (EACH)
ALL	ALL	BS711A	BS711B	

OTHER BIKES

MODELL	YEAR	ART.	€ (EACH)
HONDA CB1000R	08>	BS713B	
MV AGUSTA BRUTALE 750/910/989R/1078RR	03>	BS730B	
BMW K1200 R	05>	BS752B	
BMW R1150GS	99>06	BS750B	
BMW R1150R	00>07	BS750B *	
BMW R1200GS	04>	BS752B	
BMW R1200R	06>	BS752B **	

**BS752B: SCREW INCLUDED M10x20 - *BS750B: SCREW INCLUDED M8x75



avio 21
hi-power *led*

avio 21



FR021A FR021B FR021G FR021R

colors

MODEL "AVIO 21"

●	●	●	●	€ (EACH)
FR021A	FR021B	FR021G	FR021R	

info



Our indicator lights are complete with a LED protection kit and resistors to assure be compatibility with the 10/21 W power supply plants.



homologated



design registration # 524939





zero 11
hi-power *led*

zero 11



FR025A

FR025B

colors

MODEL "ZERO 11"

●	●	€ (EACH)
FR025A	FR025B	

info



homologated



design registration # 524939

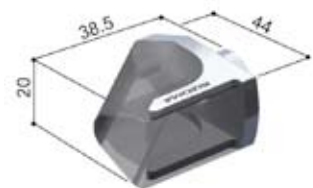

Our indicator lights are complete with a LED protection kit and resistors to assure be compatibility with the 10/21 W power supply plants.



track 77 hi-power *led*

track 77



FR023A

FR023B

colors

MODEL "ZERO 11"

○	●	€ (EACH)
FR023A	FR023B	

info



homologated



design registration # 524939



Our indicator lights are complete with a LED protection kit and resistors to assure be compatibility with the 10/21 W power supply plants.

INDICATOR LIGHT ADAPTERS

info

- The kit includes 4 pieces, which correspond to 2 adapters which are made of plastic.



HONDA®

MODEL	YEAR	●	€ (KIT)
ALL	ALL	FR216B	

KAWASAKI®

MODEL	YEAR	●	€ (KIT)
ALL	ALL	FR210B	

SUZUKI®

MODEL	YEAR	●	€ (KIT)
ALL	ALL	FR214B	

YAMAHA®

MODEL	YEAR	●	€ (KIT)
R1	02>	FR212B	
R6	02>	FR212B	
FZ-6 FAZER	02>	FR212B	
FZ-1 FAZER	02>	FR212B	
OTHER MODELS	ALL	FR210B	

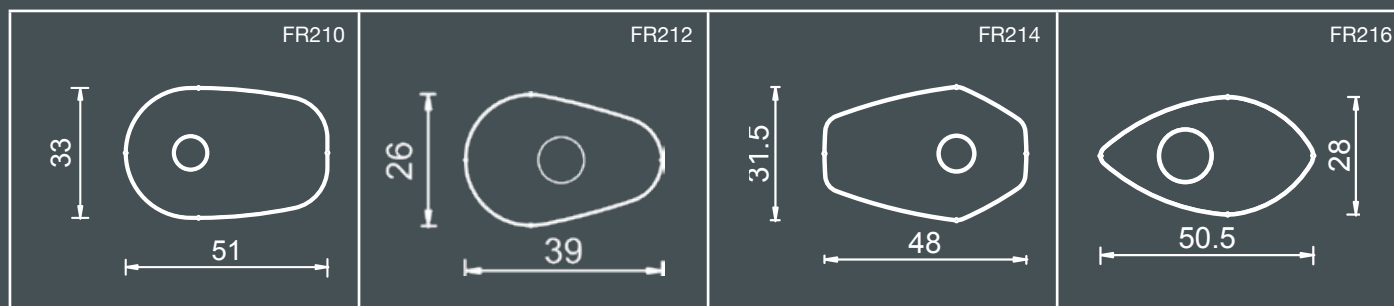

INDICATOR LIGHT SPACER (32 mm)

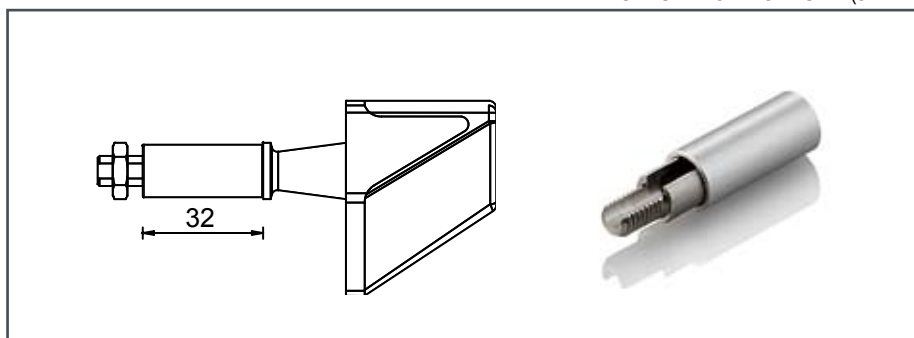

○	●	€ (CAD.)
FR300A	FR300B	

INDICATOR LIGHT ADAPTERS





safety first



PROGUARD SYSTEM®

After a long-term research, having used the latest hi-tech control systems, successfully employed in the Formula 1, our company have designed an absolutely exclusive product, meant to increase the safety degree of motorcyclists.

The product called PROGUARD SYSTEM®, prevents the fall caused by an accidental impact that involves the brake lever, as described above. The shock does not usually have grave consequences, but it is not excluded the possibility of tilting over.

PROGUARD SYSTEM® protects the brake lever from an involuntary pressure in a simple and effective way. Moreover, the system averts an unintentional actuation of the clutch lever, which in case of contact, could get detached causing a dangerous situation (traction/idle/traction of the wheel).



design registration / patent pending



Accidental contact

During a number of recent motorcycle races, there have been some accidents due to injurious falls caused by the contact of the front brake lever with a lateral or rear point of another bike.

An unexpected proximity to an obstacle, with the same ensuing consequence, may possibly happen outside the track, as well.

aerodynamics



The speed exerts negative influence on the aerodynamics? PROGUARD SYSTEM® solves the problem.

Analyzing the data obtained during the races, it's been shown up that once the a 180 km/h speed is exceeded, both brake and clutch levers are undergone a front pressure caused by the air resistance. This results in a value variation up to 0.7-0.8 bar in the hydraulic plant and lead to attrition between the brake pads and the disc, as well as to a sliding of the hydraulic clutch components.

To decrease these inconveniences and to avoid any possible efficiency loss, the outer parts of our present brake and clutch levers have been machined by milling in a specific way that allows to discharge the air flows. As a result, the problem has been significantly reduced, but it's obvious that the air pressure exerted on the front levers at high speed does not allow its complete elimination.

Another function of the PROGUARD SYSTEM® is removing the pressure caused by the air on the lever, so to avoid the formation of brake attrition and overheating consequences, as well as the clutch sliding and effectiveness losses. All this through its aerodynamic part.

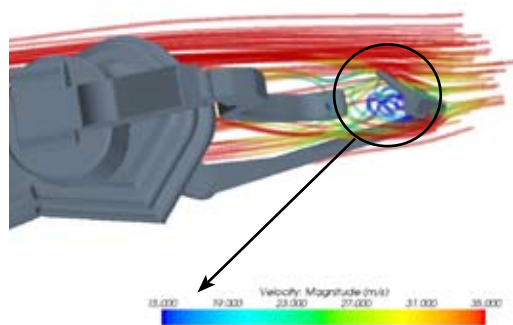

- PROGUARD SYSTEM® removed the pressure caused by the air on the lever

Wind tunnel

The CFD analysis of the PROGUARD SYSTEM® is a numeric type activity of the Computerized Hydrodynamics that represents the state of the numeric stimulations art in the Aerodynamic field. The computation code being used is STAR CCM+, produced by CD-ADAPCO, a world leading manufacturer of the CAE systems dedicated to the industry and, in particular, to the CFD application in particular.

CD-ADAPCO, with their products, is an official partner of the largest Teams, such as the America's Cup and Formula 1.

The calculation activities have been enlarged in co-operation with AT.I, the engineering department of ATOMO GROUP LTD.

Presently, RIZOMA is the only manufacturer of motorcycle components that employs these technologies for the development of its own product lines.

130 km/h

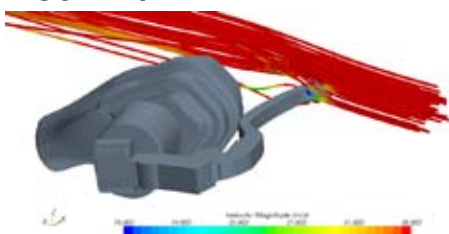

200 km/h

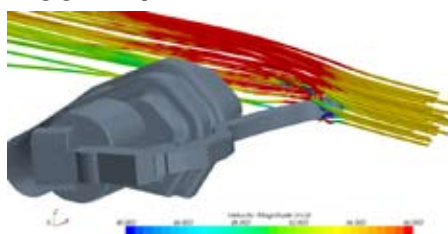

300 km/h

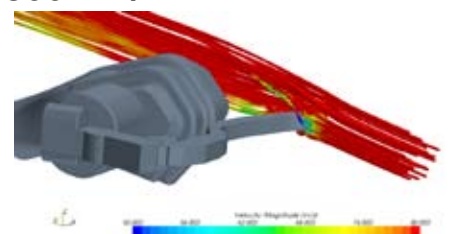

material

The PROGUARD SYSTEM® is a synthesis of resistance, durability and functionality. Its body is made of a fusion of aluminum–silicon–magnesium and manganese, which assure the necessary rigidness and at the same time a low fragility useful in event of fall not caused by an unexpected contact of the lever.

The AERODYNAMIC PART is made of a particular plastic material, resistant to the atmospheric exposures, which in case of impact, can bend toward the motorcyclist hand.



style

An extreme care about every small detail and using the most efficient materials distinguish this invention, as well. The typical style of all Rizoma products always puts into evidence an attentive consideration for the aesthetics and design. As a result, the emotional effect, the ability to arouse positive sensations together with the functional and hi-tech aspect.



PROGUARD SYSTEM®



LP011A/LP012A LP011B/LP012B LP011G/LP012G

RIGHT

○	●	●	€ (EACH)
LP011A	LP011B	LP011G	

LEFT

○	●	●	€ (EACH)
LP012A	LP012B	LP012G	

GRIPS



lux
extreme *action*

lux



GR213A

GR213B

GR213G

GR213R

GR213U

colors

MODEL LUX

○	●	●	●	●	€ (PAIR)
GR213A	GR213B	GR213G	GR213R	GR213U	

info



- Adapters for all bike models are included, except for MV AGUSTA®:
- GR414B grips adapters for ALL MV AGUSTA®



design registration # 524939





sport line
utmost *performance*

sport line



GR205A

GR205B

GR205G

GR205R

GR205U

colors

MODEL SPORT LINE

○	●	●	●	●	€ (PAIR)
GR205A	GR205B	GR205G	GR205R	GR205U	

info



- Adapters for all bike models are included, except for MV AGUSTA®:
- GR414B grips adapters for ALL MV AGUSTA®



functional assembly



○	●	●	●	●	€ (PAIR)
MA512A	MA512B	MA512G	MA512R	MA512U	

info

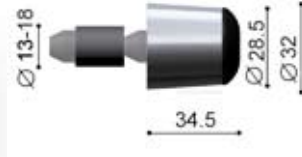

R design registration # 524939

- MA512 can't be used in combination with BS070 and BS144 mirrors.
- WEIGHT (each): 65 gr



○	●	●	●	●	€ (PAIR)
MA506A	MA506B	MA506G	MA506R	MA506U	

info

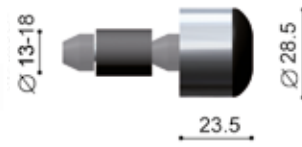

R design registration # 524939

- WEIGHT (each): 50 gr



○	●	●	●	●	€ (PAIR)
MA502A	MA502B	MA502G	MA502R	MA502U	

info



R design registration # 524939

- WEIGHT (each): 60 gr



○	●	●	●	●	€ (PAIR)
MA516A	MA516B	MA516G	MA516R	MA516U	

info

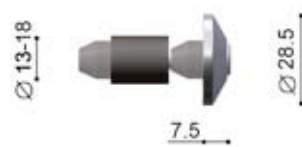

R design registration # 524939

- MA512 can't be used in combination with BS070 and BS144 mirrors.
- WEIGHT (each): 40 gr



functional assembly

CONICAL HANDLEBAR UNIVERSAL ADAPTERS

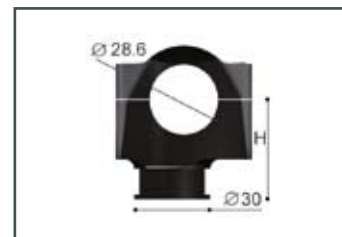

info

SCREWS INCLUDED:
 AZ402B:
 nr.02 M10x60
 nr.02 M10x80
 nr.02 M12x70
 AZ403B:
 nr.02 M10x60
 nr.02 M10x80
 nr.02 M10x100
 nr.02 M12x70

CODE	HEIGHT (H)	COLOR	€ (PAIR)
AZ402B	42 mm	●	
AZ403B	60 mm	●	

CONICAL HANDLEBAR UNIVERSAL ADAPTERS

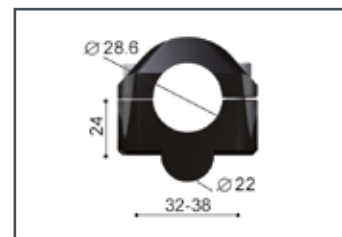

info

- SCREWS INCLUDED: nr.04 M8x25
- For mounting on other models, see the adjacent illustration with dimensions.
- The original handlebar clamp must be in one piece with the triple tree, with centres of between 32 and 38 mm.

BMW®	MODEL	YEAR	CODE	€ (PAIR)
	R850-R1150 R	ALL	AZ405B	

DUCATI®	MODEL	YEAR	CODE	€ (PAIR)
	MONSTER *	01>	AZ405B	
	MULTISTRADA 620	05>06	AZ405B	

*except MONSTER 696/S4

HONDA®	MODEL	YEAR	CODE	€ (PAIR)
	CB1000R	08>	AZ405B	
	HORNET CB600	ALL	AZ405B	
	HORNET CB900	ALL	AZ405B	

KAWASAKI®	MODEL	YEAR	CODE	€ (PAIR)
	ER-6N/F	05>08	AZ405B	

SUZUKI®	MODEL	YEAR	CODE	€ (PAIR)
	GSR 600	06>	AZ405B	

YAMAHA®	MODEL	YEAR	CODE	€ (PAIR)
	FZ6/FZ6 FAZER	06>	AZ405B	



functional assembly



VARIABLE SECTION HANDLEBAR Ø 22-29 mm



colors

○	●	●	●	●	€
MA005A	MA005B	MA005G	MA005R	MA005U	

info

- Variable section handlebar, the most elegant and effective means of vibration reducing
- WEIGHT: 0.56 kg

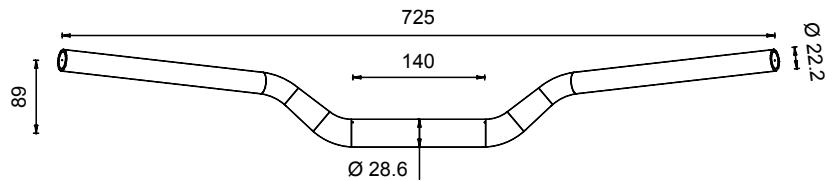

HANDLEBAR Ø 22 mm



colors

○	●	●	●	●	€
MA001A	MA001B	MA001G	MA001R	MA001U	

info

- WEIGHT: 0.46 kg

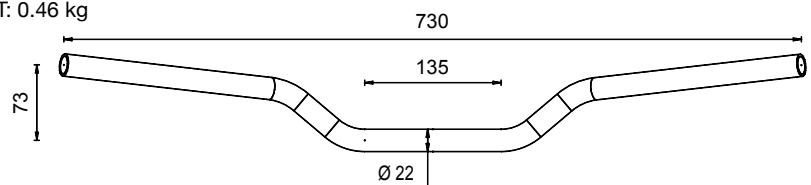

BRAKE/CLUTCH LEVERS



lightness & *motion*



design registration # 524939



colors

info

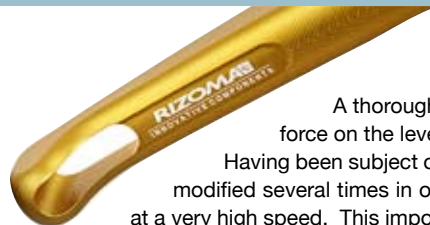

Aerodynamic properties and grip

A thorough research has proved that at high speed the air pressure force on the lever puts the circuit under pressure rendering it inactive.

Having been subject of a long-term studies in a wind tunnel, the lever has been modified several times in order to make it less sensible to air pressure action, even at a very high speed. This important achievement led the company to patent the original design.

The precise ultrathin front lines, as well as the shape, assure a better grip.

Articulated joint and adjustment

The levers are created in line with the latest technology: a broad range of adjustments, including movement on the bearings with return springs, makes it possible to improve their functioning, reliability and durability.

The articulated joint allows to fold up the lever in case of fall and thus to avoid its break.



Lightness

The lever is characterised by an ultralight weight thanks to its particular shape with hollow spaces left for this purpose.

BRAKE/CLUTCH LEVERS

BUELL®

MODEL	YEAR	BRAKE LEVER				CLUTCH LEVER			
		○	●	●	€	○	●	●	€
XB9R	ALL	LB550A	LB550B	LB550G		LC550A	LC550B	LC550G	
XB9S	ALL	LB550A	LB550B	LB550G		LC550A	LC550B	LC550G	
XB9SX	ALL	LB550A	LB550B	LB550G		LC550A	LC550B	LC550G	
XB12S	ALL	LB550A	LB550B	LB550G		LC550A	LC550B	LC550G	
XB12SS	ALL	LB550A	LB550B	LB550G		LC550A	LC550B	LC550G	
XB12STT	ALL	LB550A	LB550B	LB550G		LC550A	LC550B	LC550G	
XB12X	ALL	LB550A	LB550B	LB550G		LC550A	LC550B	LC550G	
XB12R	ALL	LB550A	LB550B	LB550G		LC550A	LC550B	LC550G	

DUCATI®

MODEL	YEAR	BRAKE LEVER				CLUTCH LEVER			
		○	●	●	€	○	●	●	€
749	03>07	LB500A	LB500B	LB500G		LC500A	LC500B	LC500G	
999	02>06	LB500A	LB500B	LB500G		LC500A	LC500B	LC500G	
1098	07>	LB500A	LB500B	LB500G		LC500A	LC500B	LC500G	
MONSTER 620	01>06	LB502A	LB502B	LB502G		LC502A	LC502B	LC502G	
MONSTER 695	06>08	LB502A	LB502B	LB502G		LC502A	LC502B	LC502G	
MONSTER 750	96>02	LB502A	LB502B	LB502G		LC502A	LC502B	LC502G	
MONSTER S2R	04>07	LB502A	LB502B	LB502G		LC502A	LC502B	LC502G	
MONSTER 1000	02>05	LB501A	LB501B	LB501G		LC501A	LC501B	LC501G	
MONSTER S2R 1000	05>07	LB501A	LB501B	LB501G		LC501A	LC501B	LC501G	
MONSTER S4R	07>08	LB500A	LB500B	LB500G		LC500A	LC500B	LC500G	
MONSTER S4R	03>06	LB501A	LB501B	LB501G		LC501A	LC501B	LC501G	
MONSTER S4RS T.S.	06>08	LB500A	LB500B	LB500G		LC500A	LC500B	LC500G	
MULTISTRADA 620	05>06	LB502A	LB502B	LB502G		LC502A	LC502B	LC502G	
MULTISTRADA 1100	07>	LB501A	LB501B	LB501G		LC501A	LC501B	LC501G	
HYPERMOTARD 1100	07>	LB201A	LB201B	LB201G		LC500A	LC500B	LC500G	
SPORT 1000	06>	LB501A	LB501B	LB501G		LC501A	LC501B	LC501G	
ST3	04>07	LB501A	LB501B	LB501G		LC501A	LC501B	LC501G	
ST4S	04>05	LB501A	LB501B	LB501G		LC501A	LC501B	LC501G	

HONDA®

MODEL	YEAR	BRAKE LEVER				CLUTCH LEVER			
		○	●	●	€	○	●	●	€
CBR600RR	07>08	LB104A	LB104B	LB104G		LC200A	LC200B	LC200G	
CBR600RR	03>06	LB102A	LB102B	LB102G		LC200A	LC200B	LC200G	
CBR900RR	02>04	LB102A	LB102B	LB102G		LC200A	LC200B	LC200G	
CBR1000RR	08>	LB104A	LB104B	LB104G		LC200A	LC200B	LC200G	
CBR1000RR	06>07	LB103A	LB103B	LB103G		LC101A	LC101B	LC101G	
CBR1000RR	04>05	LB103A	LB103B	LB103G		LC101A	LC101B	LC101G	
CB1000R	08>	LB103A	LB103B	LB103G		LC101A	LC101B	LC101G	
HORNET CB600	07>	LB100A	LB100B	LB100G		LC200A	LC200B	LC200G	
HORNET CB600	05>06	LB100A	LB100B	LB100G		LC100A	LC100B	LC100G	
HORNET CB600	03>04	LB100A	LB100B	LB100G		LC100A	LC100B	LC100G	
HORNET CB600S	02>04	LB100A	LB100B	LB100G		LC100A	LC100B	LC100G	

KAWASAKI®

MODEL	YEAR	BRAKE LEVER				CLUTCH LEVER			
		○	●	●	€	○	●	●	€
ZX6R	07>08	LB301A	LB301B	LB301G		LC301A	LC301B	LC301G	
ZX10R	08>	LB301A	LB301B	LB301G		LC301A	LC301B	LC301G	
ZX10R	06>07	LB301A	LB301B	LB301G		LC301A	LC301B	LC301G	
Z750	07>	LB550A	LB550B	LB550G		LC301A	LC301B	LC301G	
Z750/Z750S	03>06	LB100A	LB100B	LB100G		LC300A	LC300B	LC300G	
Z1000	03>06	LB100A	LB100B	LB100G		LC301A	LC301B	LC301G	
Z1000	07>	LB301A	LB301B	LB301G		LC301A	LC301B	LC301G	
ER6N/ER6F	05>08	LB100A	LB100B	LB100G		LC300A	LC300B	LC300G	

KTM®

MODEL	YEAR	BRAKE LEVER				CLUTCH LEVER			
		○	●	●	€	○	●	●	€
990 SUPERDUKE R	07>	LB500A	LB500B	LB500G		LC675A	LC675B	LC675G	
990 SUPER DUKE	05>	LB500A	LB500B	LB500G		LC675A	LC675B	LC675G	

SUZUKI®

MODEL	YEAR	BRAKE LEVER				CLUTCH LEVER			
		○	●	●	€	○	●	●	€
GSXR 600/GSXR 750	08>	LB400A	LB400B	LB400G		LC200A	LC200B	LC200G	
GSXR 600/GSXR 750	06>07	LB400A	LB400B	LB400G		LC200A	LC200B	LC200G	
GSXR 1000	07>08	LB400A	LB400B	LB400G		LC400A	LC400B	LC400G	
GSXR 1000	05>06	LB400A	LB400B	LB400G		LC200A	LC200B	LC200G	

TRIUMPH®

MODEL	YEAR	BRAKE LEVER				CLUTCH LEVER			
		○	●	●	€	○	●	●	€
STREET TRIPLE 675	07>	LB100A	LB100B	LB100G		LC801A	LC801B	LC801G	
SPEED TRIPLE	08>	LB400A	LB400B	LB400G		LC801A	LC801B	LC801G	
SPEED TRIPLE	05>07	LB100A	LB100B	LB100G		LC801A	LC801B	LC801G	
DAYTONA 675	06>08	LB400A	LB400B	LB400G		LC801A	LC801B	LC801G	

YAMAHA®

MODEL	YEAR	BRAKE LEVER				CLUTCH LEVER			
		○	●	●	€	○	●	●	€
YZF R6	08>	LB201A	LB201B	LB201G		LC200A	LC200B	LC200G	
YZF R6	06>07	LB201A	LB201B	LB201G		LC200A	LC200B	LC200G	
YZF R1	04>08	LB201A	LB201B	LB201G		LC200A	LC200B	LC200G	
FZ1/FZ1 FAZER	06>	LB200A	LB200B	LB200G		LC200A	LC200B	LC200G	
FZ6/FZ6 FAZER	04>	LB200A	LB200B	LB200G		LC200A	LC200B	LC200G	
FZS1000 FAZER	01>05	LB200A	LB200B	LB200G		LC200A	LC200B	LC200G	





useful design



design registration
524939



CHARACTERISTICS:

VOLUME.....20 cm³
HEIGHT42 mm
Ø.....31 mm

UTILIZZO CONSIGLIATO: POMPA FRENO POSTERIORE

CODE	COLOR	€
CT015A	○	
CT015B	●	
CT015G	●	
CT015R	●	
CT015T	●	
CT015U	●	



design registration
524939



CHARACTERISTICS:

VOLUME.....26 cm³
HEIGHT49 mm
Ø.....40 mm

UTILIZZO CONSIGLIATO: POMPA FRIZIONE

CODE	COLOR	€
CT017A	○	
CT017B	●	
CT017G	●	
CT017R	●	
CT017T	●	
CT017U	●	



design registration
524939



CHARACTERISTICS:

VOLUME.....27 cm³
HEIGHT49 mm
Ø.....40 mm

UTILIZZO CONSIGLIATO: POMPA FRIZIONE

CODE	COLOR	€
CT025A	○	
CT025B	●	
CT025G	●	
CT025R	●	
CT025T	●	
CT025U	●	

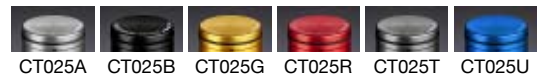

design registration
524939



CHARACTERISTICS:

VOLUME.....35 cm³
HEIGHT43 mm
Ø.....50 mm

UTILIZZO CONSIGLIATO: POMPA FRENO ANTERIORE

CODE	COLOR	€
CT027A	○	
CT027B	●	
CT027G	●	
CT027R	●	
CT027T	●	
CT027U	●	



CT025/CT027 FLUID TANK BRAKET

CODE	COLOR	€
CT450B	●	

NON COMPATIBILE CON CT015 E CT017



useful design

BRAKE/CLUTCH FLUID CAPS



CODE	A - DIAMETER	€
TP014	M51x4	
TP015	M35x4	
TP016	Ø 49 mm	
TP017	M34x4	

info

CODICI E MODELLI NELLE PAGINE SEGUENTI

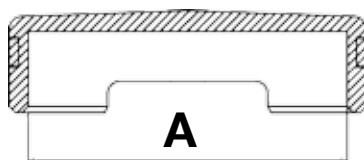

BRAKE/CLUTCH FLUID CAPS

FRONT BRAKE FLUID TANK

DUCATI®

MODEL	YEAR	○	●	●	●
ALL	ALL	TP016A	TP016B	TP016G	TP016R

HONDA®

MODEL	YEAR	○	●	●	●	●
CBR 1000RR	06>08	TP014A	TP014B	TP014G	TP014R	TP014U
CBR 600RR	07>08	TP014A	TP014B	TP014G	TP014R	TP014U
CB1000R	08>	TP014A	TP014B	TP014G	TP014R	TP014U

KAWASAKI®

MODEL	YEAR	○	●	●	●	●
Z750	07>	TP014A	TP014B	TP014G	TP014R	TP014U
Z1000	07>	TP014A	TP014B	TP014G	TP014R	TP014U
ZX10R	04>08	TP014A	TP014B	TP014G	TP014R	TP014U
ZX9R	99>03	TP014A	TP014B	TP014G	TP014R	TP014U
ZX6R	01>08	TP014A	TP014B	TP014G	TP014R	TP014U

KTM®

MODEL	YEAR	○	●	●	●
SUPERDUKE	05>	TP016A	TP016B	TP016G	TP016R
SUPERDUKE R	07>	TP016A	TP016B	TP016G	TP016R
690 PRESTIGE	07>	TP016A	TP016B	TP016G	TP016R

SUZUKI®

MODEL	YEAR	○	●	●	●	●
GSX-R 1000	01>08	TP014A	TP014B	TP014G	TP014R	TP014U
GSX-R 750	00>08	TP014A	TP014B	TP014G	TP014R	TP014U
GSX-R 600	01>08	TP014A	TP014B	TP014G	TP014R	TP014U
SV650	ALL	TP014A	TP014B	TP014G	TP014R	TP014U
SV1000	ALL	TP014A	TP014B	TP014G	TP014R	TP014U

TRIUMPH®

MODEL	YEAR	○	●	●	●	●
SPEED TRIPLE	02>08	TP014A	TP014B	TP014G	TP014R	TP014U
STREET TRIPLE	07>	TP014A	TP014B	TP014G	TP014R	TP014U
DAYTONA	06>08	TP014A	TP014B	TP014G	TP014R	TP014U

YAMAHA®

MODEL	YEAR	○	●	●	●	●
YZF-R1	00>08	TP014A	TP014B	TP014G	TP014R	TP014U
YZF-R6	03>08	TP014A	TP014B	TP014G	TP014R	TP014U

REAR BRAKE FLUID TANK

DUCATI®

MODEL	YEAR	○	●	●	●
ALL	ALL	TP017A	TP017B	TP017G	TP017R

HONDA®

MODEL	YEAR	○	●	●	●	●
CBR 1000RR	06>08	TP015A	TP015B	TP015G	TP015R	TP015U

KAWASAKI®

MODEL	YEAR	○	●	●	●	●
Z750	<06	TP014A	TP014B	TP014G	TP014R	TP014U
Z750	07>	TP015A	TP015B	TP015G	TP015R	TP015U
Z1000	<06	TP014A	TP014B	TP014G	TP014R	TP014U
Z1000	07>	TP015A	TP015B	TP015G	TP015R	TP015U
ZX10R	08>	TP015A	TP015B	TP015G	TP015R	TP015U
ZX10R	06>07	TP014A	TP014B	TP014G	TP014R	TP014U
ZX6R	07>08	TP015A	TP015B	TP015G	TP015R	TP015U
ER-6 N/F	05>08	TP014A	TP014B	TP014G	TP014R	TP014U

KTM®

MODEL	YEAR	○	●	●	●
SUPERDUKE	05>	TP017A	TP017B	TP017G	TP017R
SUPERDUKE R	07>	TP017A	TP017B	TP017G	TP017R
690 PRESTIGE	07>	TP017A	TP017B	TP017G	TP017R

TRIUMPH®

MODEL	YEAR	○	●	●	●	●
STREET TRIPLE	07>	TP015A	TP015B	TP015G	TP015R	TP015U
DAYTONA	06>08	TP015A	TP015B	TP015G	TP015R	TP015U

YAMAHA®

MODEL	YEAR	○	●	●	●	●
YZF-R6	06>08	TP015A	TP015B	TP015G	TP015R	TP015U

CLUTCH FLUID TANK

DUCATI®

MODEL	YEAR	○	●	●	●
ALL	ALL	TP017A	TP017B	TP017G	TP017R

HONDA®

MODEL	YEAR	○	●	●	●	●
CBR 1000RR	06>07	TP015A	TP015B	TP015G	TP015R	TP015U
CB1000R	08>	TP015A	TP015B	TP015G	TP015R	TP015U

KTM®

MODEL	YEAR	○	●	●	●	●
SUPERDUKE	05>	TP015A	TP015B	TP015G	TP015R	TP015U
SUPERDUKE R	07>	TP015A	TP015B	TP015G	TP015R	TP015U
690 PRESTIGE	07>	TP015A	TP015B	TP015G	TP015R	TP015U



2400C M3

useful design

ENGINE OIL FILLER CAPS



DUCATI® M22x1.5 (EXCEPT 848 / MONSTER 696)

○	●	●	●	●	€
TP010A	TP010B	TP010G	TP010R	TP010U	

DUCATI® 848 / MONSTER 696 M20x2.5

○	●	●	●	●	€
TP008A	TP008B	TP008G	TP008R	TP008U	

HONDA® M20x2.5 (EXCEPT: HONDA CBR1100XX / X-11 / VFR)

○	●	●	●	●	€
TP008A	TP008B	TP008G	TP008R	TP008U	

KAWASAKI® M30x1.5 (EXCEPT: KAWASAKI ER-6)

○	●	●	●	●	€
TP013A	TP013B	TP013G	TP013R	TP013U	

MV AGUSTA® M25x1.5

○	●	●	●	●	€
TP012A	TP012B	TP012G	TP012R	TP012U	

SUZUKI® M20x1.5

○	●	●	●	●	€
TP009A	TP009B	TP009G	TP009R	TP009U	

YAMAHA® M26x3 (EXCEPT YAMAHA T-MAX / MT-03 / XJR)

○	●	●	●	●	€
TP011A	TP011B	TP011G	TP011R	TP011U	

In the table above there are the most common bike models.

In each case, before ordering, please, check the dimensions of the original product (OEM).



It's a good practise to fasten the engine oil filler cap with a safety wire.

Rizoma engine oil filler caps come with with a removable bracket for the safety wire.



simple & *effective*



info

CODICI E MODELLI NELLE PAGINE SEGUENTI

Essential and indispensable fairing and engine guards. They limit the damage to the engine, fairings and frame in the event of a fall.

The part made of "derlyn®" combined with aluminium cushions the impact, protecting the engine from undesirable consequences.

ENGINE/FAIRING GUARDS

COMPLETE KIT

SPARE PART

DUCATI®

MODEL	YEAR	ART.	€
MONSTER (picture 1)	ALL	PM350B pair	
HYPERMOTARD1100/1100 (picture 2)	07>	PM500B pair	

DERLYN® SPARE PART	€
R247	each
PM500-01	each

HONDA®

MODEL	YEAR	ART.	€
CBR600RR (picture 1)	07>08	PM113B pair	
CBR600RR (picture 1)	03>06	PM108B pair	
CBR1000RR (picture 3)	08>	PM520A each	
CBR1000RR (picture 1)	06>07	PM112B pair	
CBR1000RR (picture 1)	04>05	PM110B pair	
CB1000R (picture 4)	08>	PM521B each	
CB1000R (picture 1)	08>	PM101B pair	
HORNET CB600 (picture 1)	07>	PM101B pair	
HORNET CB600 (picture 1)	05>06	PM100B pair	
HORNET CB600 (picture 1)	03>04	PM100B pair	
HORNET CB600 (picture 1)	00>02	PM100B pair	

DERLYN® SPARE PART	€
R247	each
R247	each
PM520-02	each
R247	each
R247	each
PM520-02	each
R247	each
R247	each
R247	each
R247	each
R247	each

KAWASAKI®

MODEL	YEAR	ART.	€
ZX6R (picture 1)	07>08	PM310B pair	
ZX10R (picture 1)	08>	PM313B pair	
Z750 (picture 1)	07>	PM312B pair	
Z750/Z750S (picture 1)	03>06	PM304B pair	
Z1000 (foto 1)	07>	PM312B pair	
Z1000 (picture 5)	07>	PM311A pair	
Z1000 (picture 5)	03>06	PM305B pair	
ER6N (picture 1)	05>08	PM308B pair	

DERLYN® SPARE PART	€
R247	each
R247	each
R247	each
R247	each
R247	each
PM311-02	each
PM305-02	each
R247	each

MV AGUSTA®

MODEL	YEAR	ART.	€
BRUTALE 750 (picture 1)	03>05	PM430B pair	
BRUTALE 910 (picture 1)	05>08	PM430B pair	

DERLYN® SPARE PART	€
R247	each
R247	each

SUZUKI®

MODEL	YEAR	ART.	€
GSXR 600/750 (picture 6)	06>	PM540A each	
GSXR 600/750 (picture 6)	06>	PM541A each	
GSXR 600/750 (picture 1)	06>	PM162B pair	
GSXR 600/750 (picture 1)	04>05	PM159B pair	
GSXR 600/750 (picture 1)	01>03	PM159B pair	
GSXR 1000 (picture 1)	07>08	PM164B pair	
GSXR 1000 (picture 1)	05>06	PM160B pair	
GSXR 1000 (picture 1)	03>04	PM159B pair	
GSXR 1000 (picture 1)	01>02	PM159B pair	
GSR 600 (picture 1)	06>	PM202B pair	
SV650/SV650S (picture 1)	03>08	PM151B pair	
SV1000/SV1000S (picture 1)	03>07	PM151B pair	
GSF1200 BANDIT (picture 1)	01>05	PM153B pair	

DERLYN® SPARE PART	€
PM520-02	each
PM520-02	each
R247	each
R247	each
R247	each
R247	each
R247	each
R247	each
R247	each
R247	each
R247	each
R247	each
R247	each

TRIUMPH®

MODEL	YEAR	ART.	€
SPEED TRIPLE (picture 1)	08>	PM250B pair	
SPEED TRIPLE (picture 7)	08>	PM530A each	
SPEED TRIPLE (picture 1)	05>07	PM250B pair	
SPEED TRIPLE (picture 1)	02>04	PM250B pair	
STREET TRIPLE (picture page 209)	07>	PM510B pair	

DERLYN® SPARE PART	€
R247	each
PM530-02	each
R247	each
R247	each
R247	each

YAMAHA®	COMPLETE KIT				SPARE PARTS	
	MODEL	YEAR	ART.		DERLYN® SPARE PART	€
	YZF R6	08>	PM210B	pair	R247	each
	YZF R6	06>07	PM207B	pair	R247	each
	YZF R6	03>05	PM205B	pair	R247	each
	YZF R1	07>08	PM209B	pair	R247	each
	YZF R1	04>06	PM206B	pair	R247	each
	YZF R1	02>03	PM205B	pair	R247	each
	FZ6/FZ6 FAZER	04>	PM202B	pair	R247	each
	FZ1/FZ1 FAZER	06>	PM208B	pair	R247	each



_1



_2



_3



_4



_5



_6



_7



SPARE PARTS

The code of the engine/airbox guard is indicated in the tables. The spare part, subject to wear in case of fall, is the one made of Derlyn®.



advanced application

LICENSE PLATE SUPPORT

design registration # 524939



adjustable inclination

In 2009 we introduced a completely new style of our license support plates which shall assure a better performance: a broad range of adjustments makes it possible to modify the support inclination, in the countries where allowed by the traffic regulations.



adjustable height

The license plate support can be moved along its axle to fix the required height.



indicator lights

The adjustable supports - included in the kit - make it possible to fix the necessary position of the indicators.



license plate support light

The high tech LED license plate support light is homologated in order to assure its effectiveness: in any case, one can prefer not to mount it without compromising the license plate support design.



sizes

The kit comprises three different sizes of license plate supports: (157x157 mm, 175x130 mm, 146x69.5 mm) fitting various license dimensions.

LICENSE PLATE SUPPORT

*BUELL®

MODEL	YEAR	ART.	€
XB9S	03>04	PT200B	
XB9SX	04>	PT200B	
XB12S	03>	PT200B	
XB12SS	05>	PT200B	
XB12STT	07>	PT200B	

* Mountable on ourtail unit ZZB013C page 100

DUCATI®

MODEL	YEAR	ART.	€
848	07>	PT503B	
1098	07>	PT503B	
HYPERMOTARD 1100/1100s	07>	PT504B	
MONSTER	96>08	PT500B	

HONDA®

MODEL	YEAR	ART.	€
CBR600RR	07>08	PT101B	
CBR600RR	03>06	PT100B	
CBR1000RR*	08>	PT102B	
CBR1000RR	06>07	PT100B	
CBR1000RR	04>05	PT100B	
CB1000R	08>	PT103B	

* Mountable on ourtail unit ZHH046K page 131

KAWASAKI®

MODEL	YEAR	ART.	€
ZX6R	07>08	PT305B	
ZX6R	05>06	PT302B	
ZX6R	03>04	PT300B	
ZX10R	08>	PT307B	
ZX10R	06>07	PT304B	
ZX10R	04>05	PT301B	
Z750	07>	PT306B	
Z750/Z750S	03>06	PT300B	
Z1000	07>	PT306B	
Z1000	03>06	PT300B	
ER6F/ER6N	05>08	PT301B	

KTM®

MODEL	YEAR	ART.	€
990 SUPERDUKE R	07>08	PT676B	
990 SUPER DUKE	05>07	PT675B	

MV AGUSTA®

MODEL	YEAR	ART.	€
BRUTALE 910	05>08	PT600B	
BRUTALE 750	03>05	PT600B	
BRUTALE 989R	08>	PT600B	
BRUTALE 1078RR	08>	PT600B	

SUZUKI®

MODEL	YEAR	ART.	€
GSXR 600/750	08>	PT405B	
GSXR 600/750	06>07	PT403B	
GSXR 1000	07>08	PT402B	
GSXR 1000	05>06	PT402B	
GSXR 1000	03>04	PT400B	

TRIUMPH®

MODEL	YEAR	ART.	€
SPEED TRIPLE*	08>	PT652B	
SPEED TRIPLE	05>07	PT650B	
STREET TRIPLE	07>	PT651B	

* Mountable on ourtail unit ZTH021K page 202

YAMAHA®

MODEL	YEAR	ART.	€
YZF R6	08>	PT204B	
YZF R6	06>07	PT204B	
YZF R6	03>05	PT200B	
YZF R1	07>08	PT207B	
YZF R1	04>06	PT207B	
YZF R1	02>03	PT200B	
FZ6/FZ6 FAZER	04>	PT202B	
FZ1	06>	PT205B	
FZ1 FAZER	06>	PT206B	

UNIVERSALI

ART.	€
PT010B	

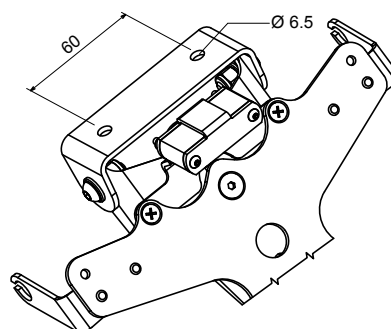

The universal license plate support is used in case there is no specific article, its dimensions are indicated in the drawing above.



R info

Our license plate support kit includes:

- license plate support
- license plate support light
- indicator light supports
- reflector kit

SPARE PARTS FOR LICENSE SUPPORT PLATES

Our license support plates are supplied complete with license plate support light and reflectors kit: these can also be ordered separately as spare parts.



homologated



LICENSE PLATE SUPPORT LIGHT (WITH BRACKET)

CODE	€
EE051B	



homologated



REFLECTOR KIT (WITH BRACKET)

ART.	€
EE045H	

REAR SET CONTROL KIT



best function



info

Our rear control kits, made of the finest billet aluminium alloy and especially designed for sports, are characterized by a unique lightness and resistance to breaking.

Various racing tests have revealed the necessity of their vertical and horizontal adjustment. The mechanisms mounted on the bearings assure a precise change and braking. The product quality and safety are assured by the TÜV certificate.



- Our rear set control kits are predisposed to the OEM stop switch positioning

BUELL®

MODEL	YEAR	ART.	€
XB9S	03>04	PE258B	
XB9SX	04>	PE258B	
XB9R	01>05	PE258B	
XB12STT	07>	PE258B	
XB12SS	05>	PE258B	
XB12S	03>	PE258B	
XB12R	03>07	PE258B	

DUCATI®

MODEL	YEAR	ART.	€
748	95>03	PE205B	
749	03>07	PE205B	
916	94>98	PE205B	
996	98>01	PE205B	
998	02>04	PE205B	
999	02>06	PE205B	
848/1098	07>	PE207B	
MONSTER 600	00>02	PE201B	
MONSTER 620	01>06	PE201B	
MONSTER 695	06>08	PE201B	
MONSTER 750	96>02	PE201B	
MONSTER 800	02>05	PE201B	
MONSTER 900	01>02	PE201B	
MONSTER 1000	02>05	PE201B	
MONSTER S2R	04>07	PE202B	
MONSTER S4	01>04	PE201B	
MONSTER S4R	03>07	PE202B	
HYPERMOTARD 1100	07>	PE208B	
HYPERMOTARD 1100S	07>	PE208B	

HONDA®

MODEL	YEAR	ART.	€
CBR600RR	07>08	PE071B	
CBR1000RR	08>	PE078B	
CBR1000RR	06>07	PE070B	
CBR1000RR	04>05	PE068B	
CB1000R	08>	PE080B	
HORNET CB600	07>	PE073B	
HORNET CB600	05>06	PE062B	
HORNET CB600	03>04	PE062B	
HORNET CB600	00>02	PE062B	
HORNET CB600S	02>04	PE062B	
HORNET CB900	02>06	PE062B	

KAWASAKI®

MODEL	YEAR	ART.	€
ZX6R	07>08	PE310B	
ZX6R	05>06	PE310B	
ZX10R	08>	PE313B	
ZX10R	06>07	PE306B	
ZX10R	04>05	PE305B	
Z750	07>	PE303B	
Z1000	07>	PE303B	
Z1000	03>06	PE300B	

KTM®

MODEL	YEAR	ART.	€
990 SUPERDUKE R	07>	PE470B	
990 SUPER DUKE	05>	PE470B	

MV AGUSTA®

MODEL	YEAR	ART.	€
BRUTALE 750	03>05	PE430B	
BRUTALE 910	05>08	PE430B	
BRUTALE 989R	08>	PE430B	
BRUTALE 1078RR	08>	PE430B	
F4 1000	04>	PE430B	
F4 750	99>03	PE430B	

SUZUKI®

MODEL	YEAR	ART.	€
GSXR 600/750	08>	PE165B	
GSXR 600/750	06>07	PE165B	
GSXR 1000	07>08	PE161B	
GSXR 1000	05>06	PE159B	
GSR 600	06>	PE164B	

TRIUMPH®

MODEL	YEAR	ART.	€
SPEED TRIPLE	08>	PE450B	
SPEED TRIPLE	05>07	PE450B	
SPEED TRIPLE	02>04	PE450B	

YAMAHA®

MODEL	YEAR	ART.	€
YZF R6	08>	PE123B	
YZF R6	06>07	PE123B	
YZF R1	07>08	PE113B	
YZF R1	04>06	PE111B	
FZ6/ FZ6 FAZER	04>	PE108B	
FZ1/FZ1 FAZER	06>	PE112B	



ACCESSORIES FOR OUR REAR SET CONTROL KITS



FOLDING PEGS KIT

○	€ (PAIR)
PE608A *	



RACING PEGS KIT

○	●	€ (PAIR)
PE616A	PE616B	

*this pegs kit is NOT mountable on PE205/PE207/PE208/PE430/PE470.



HEEL GUARD (PAIR)

CARBON FIBER	€ (PAIR)
TT003	



HEEL GUARD (PAIR)

SILVER CARBON FIBER	€ (PAIR)
TT002	

PEGS FOR ORIGINAL REARSETS



excellent *adaptability*

PEGS FOR ORIGINAL REARSETS



RIDER/PASSENGER PEGS FOR ORIGINAL REARSETS

○	●	●	●	●	€ (pair)
PE614A	PE614B	PE614G	PE614R	PE614U	

info

These pegs can be installed on various models with the adapters indicated

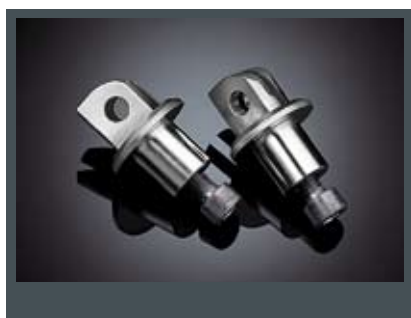

RIDER/PASSENGER PEGS ADAPTERS

CODE	COLOR	€ (PAIR)
VEDI TABELLE	○	

DUCATI®

MODEL	YEAR	RIDER	PASSENGER
MONSTER 600/750/800/900/1000	94>07		PE710A

HONDA®

MODEL	YEAR	RIDER	PASSENGER
CBR600RR	03>06	PE650A	
CBR900RR	02>04	PE650A	
CBR1000RR	08>	PE650A	PE655A
CBR1000RR	06>07	PE652A	PE655A
CB1000R	08>	PE656A	PE655A
HORNET CB600	07>	PE653A	PE654A
HORNET CB600	00>06	PE650A	PE651A

KAWASAKI®

MODEL	YEAR	RIDER	PASSENGER
ZX10R	08>	PE753A	PE754A
ZX10R	06>07		PE752A
Z750	07>	PE750A	PE752A
Z750	03>06	PE750A	
Z1000	03>	PE750A	PE752A

SUZUKI®

MODEL	YEAR	RIDER	PASSENGER
GSXR 600/750	08>	PE692A	PE693A
GSXR 600/750	01>05	PE690A	PE691A
GSXR 1000	01>04	PE690A	PE691A
SV650/SV650S	99>08	PE690A	PE691A
SV1000/SV1000S	03>07	PE690A	PE691A
GSF1200/GSF1200S BANDIT	01>05	PE690A	PE690A

TRIUMPH®

MODEL	YEAR	RIDER	PASSENGER
SPEED TRIPLE	08>	PE764A	PE762A
STREET TRIPLE 675	07>	PE760A	PE762A

YAMAHA®

MODEL	YEAR	RIDER	PASSENGER
YZF R6	03>05	PE672A	PE674A
YZF R1	02>03	PE672A	PE674A
FZ1/FZ1 FAZER	06>		PE676A



all purpose *design*



DUCATI® M8x35

○	●	●	●	●	€ (pair)
SC020A	SC020B	SC020G	SC020R	SC020U	

HONDA® M8x35

○	●	●	●	●	€ (pair)
SC020A	SC020B	SC020G	SC020R	SC020U	

KAWASAKI® M10x1.25x30

○	●	●	●	●	€ (pair)
SC030A	SC030B	SC030G	SC030R	SC030U	

SUZUKI® M8x35

○	●	●	●	●	€ (pair)
SC020A	SC020B	SC020G	SC020R	SC020U	

TRIUMPH® M6x35

○	●	●	●	●	€ (pair)
SC010A	SC010B	SC010G	SC010R	SC010U	

YAMAHA® M6x35

○	●	●	●	●	€ (pair)
SC010A	SC010B	SC010G	SC010R	SC010U	

In the table above there are the most common bike models.

In each case, before ordering, please, check the dimensions of the original product (OEM).

BMW® R1200 S



classic approach



info

Rizoma accessories for BMW models, are supplied by WUNDERLICH GmbH (Worldwide).
Tel.: +49 (0)2642 97980 or via email info@wunderlich.de - www.wunderlich.de





energetic style



APPLICATION LIST

CONICAL HANDLEBAR CLAMP	98
HANDLEBARS	64
BRAKE LEVER	98
CLUTCH LEVER	98
REAR SET CONTROL KIT	99
FRONT PULLEY COVER	99
BELT COVER	99
TAIL PIECE	100
LICENSE PLATE SUPPORT "FOX"	100
PULLEY 65 TEETH	100
PROGUARD SYSTEM® (UNIVERSAL)	52
INDICATOR LIGHTS (UNIVERSAL)	44
GRIPS Ø 22 mm (UNIVERSAL)	56
HANDLEBAR CAPS (UNIVERSAL)	60
MIRRORS (UNIVERSAL)	10



CONICAL HANDLEBAR CLAMP



MODEL	YEAR	CODE	COLOR	€
XB9S-XB9SX	ALL	AZ600B	●	
XB12S-XB12SS-XB12STT-XB12X	ALL	AZ600B	●	

CONICAL HANDLEBAR AT PAGE 64



BRAKE/CLUTCH LEVER

MODEL	YEAR	BRAKE LEVER				CLUTCH LEVER			
		○	●	●	€	○	●	●	€
XB9R-XB9S-XB9SX	ALL	LB550A	LB550B	LB550G		LC550A	LC550B	LC550G	
XB12S-XB12SS-XB12STT-XB12X-XB12R	ALL	LB550A	LB550B	LB550G		LC550A	LC550B	LC550G	



info

Upward adjustment	10>20mm
Backward adjustment	10>20mm
Diagonal adjustment	10>20mm
Compatibility with folding pegs PE608A	YES
Reversed gear change lever	NO



REAR SET CONTROL KIT

MODEL	YEAR	CODE	COLOR	€
XB9R -XB9S-XB9SX	ALL	PE258B	●	
XB12S-XB12SS	ALL	PE258B	●	
XB12STT-XB12R	ALL	PE258B	●	

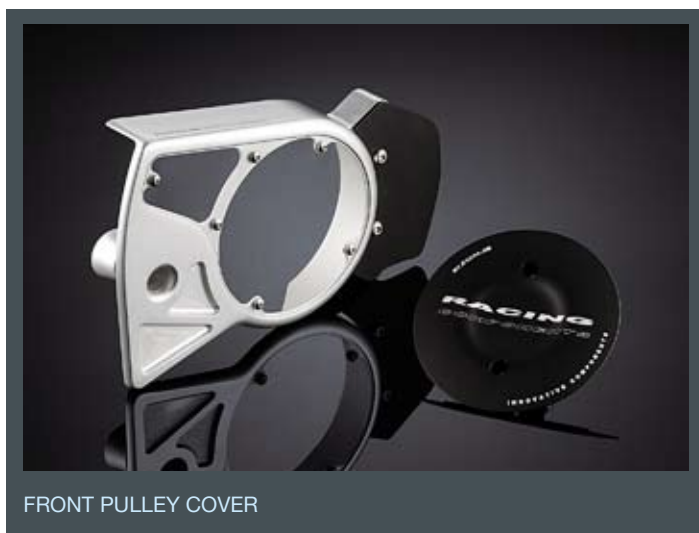

FRONT PULLEY COVER



design registration # 524939

MODEL	YEAR	CODE	COLOR	€
XB9R	01>05	ZZB020A	○	
XB9SX	04>	ZZB020A	○	
XB12R	03>07	ZZB020A	○	
XB12SS	05>	ZZB020A	○	
XB12S	03>	ZZB020A	○	
XB12STT	07>	ZZB020A	○	
XB12X	06>	ZZB020A	○	

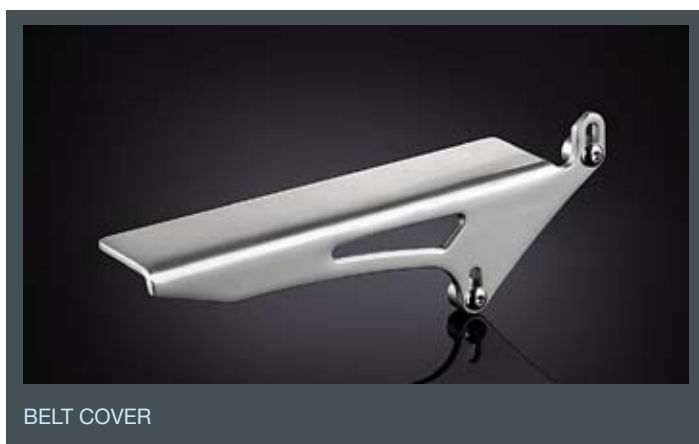

BELT COVER

MODEL	YEAR	CODE	COLOR	€
XB12S	03>05	ZZB015A	○	
XB12R	03>05	ZZB015A	○	
XB9SX	04>05	ZZB015A	○	
XB9S	03>04	ZZB015A	○	
XB9R	01>05	ZZB015A	○	
XB12SS	05>	ZZB015A	○	
XB12S	03>05	ZZB015A	○	

MODEL	YEAR	CODE	COLOR	€
XB12S	03>05	ZZB013C	SILVER MAT	
XB12S	03>	ZZB013C	SILVER MAT	
XB9S	03>04	ZZB013C	SILVER MAT	
XB9SX	04>	ZZB013C	SILVER MAT	
XB12SS	05>	ZZB013C	SILVER MAT	



REAR PCODE



design registration # 524939

LICENSE PLATE SUPPORT "FOX"

MODEL	YEAR	CODE	COLOR	€
XB9S-XB9SX	ALL	PT200B	●	
XB12S-XB12SS	ALL	PT200B	●	
X12STT	ALL	PT200B	●	

MOUNTABLE ON OURTAIL UNIT ZZB013C

MODEL	YEAR	CODE	COLOR	€
XB9SX	04>05	ZZB010B	●	
XB9S	03>04	ZZB010B	●	
XB9R	01>05	ZZB010B	●	
XB12X	06>	ZZB010B	●	
XB12STT	07>	ZZB010B	●	
XB12SS	05>	ZZB010B	●	
XB12S	03>05	ZZB010B	●	
XB12R	03>05	ZZB010B	●	



PULLEY 65 TEETH





just *racing*

APPLICATION LIST

REAR SET CONTROL KIT	104
REVERSED GEARCHANGE LEVER	104
BRAKE LEVER	104
CLUTCH LEVER	104
LICENSE PLATE SUPPORT "FOX"	105
PROGUARD SYSTEM®	127
TIMING COVER	105
REAR INDICATOR LIGHTS (UNIVERSAL)	44
GRIPS Ø 22 mm (UNIVERSAL)	56
HANDLEBAR CAPS (UNIVERSAL)	60
FRONT BRAKE FLUID TANK/CAP (UNIVERSAL)	70
CLUTCH FLUID TANK/CAP (UNIVERSAL)	70
REAR BRAKE FLUID TANK/CAP (UNIVERSAL)	70
SPROCKET COVER	126
ENGINE OIL FILLER CAP	126

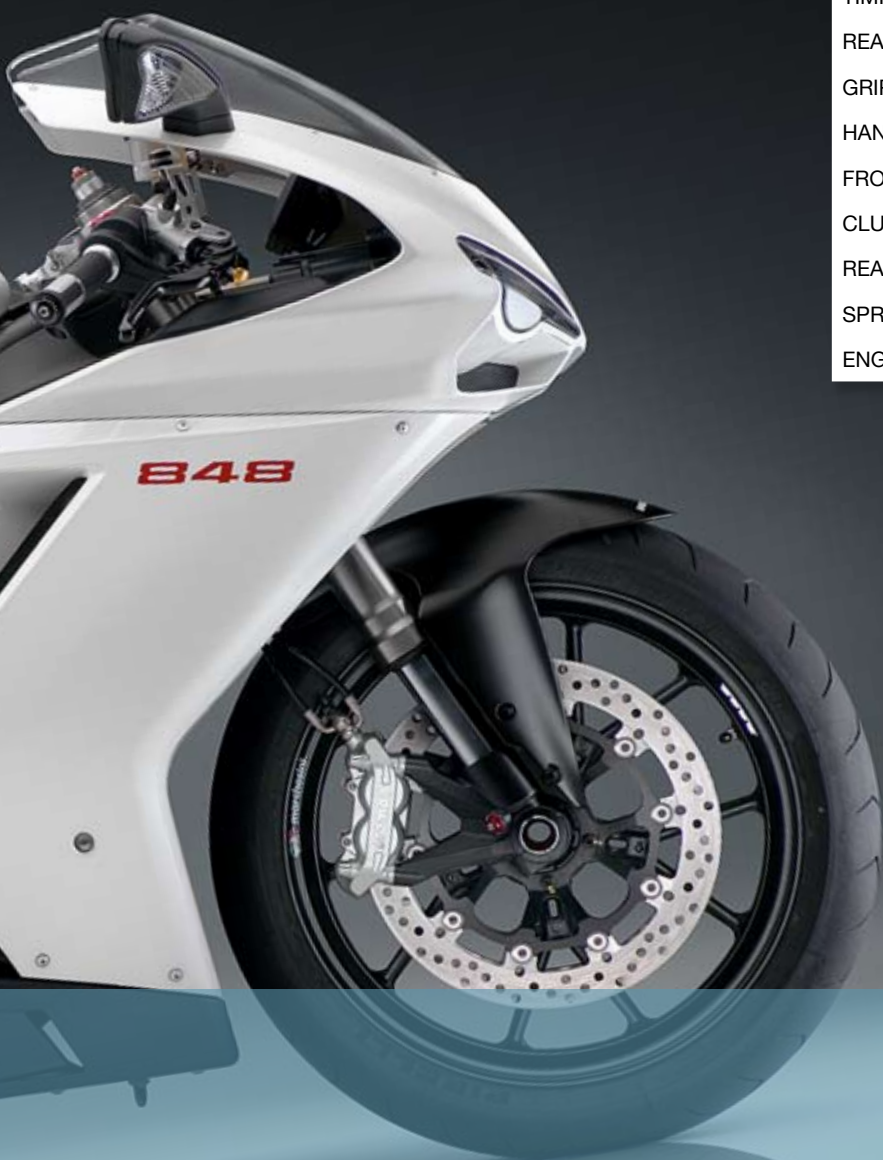

info

Upward adjustment	10>20mm
Backward adjustment	10>20mm
Diagonal adjustment	10>20mm
Compatibility with folding pegs PE608A:	NO
Reversed gear change lever: YES, using	PE206B



REAR SET CONTROL KIT

MODEL	YEAR	CODE	COLOR	€
848	08>	PE207B	●	



REVERSED GEARCHANGE LEVER

MODEL	YEAR	CODE	COLOR	€
848	08>	PE206B	●	



BRAKE LEVER

MODEL	YEAR	○	●	●	€
848	>08	LB500A	LB500B	LB500G	

CLUTCH LEVER

MODEL	YEAR	○	●	●	€
848	>08	LC500A	LC500B	LC500G	



LICENSE PLATE SUPPORT "FOX"



design registration # 524939

MODEL	YEAR	CODE	COLOR	€
848	08>	PT503B	●	



PROGUARD SYSTEM®

RIGHT

○	●	●	€
LP011A	LP011B	LP011G	

LEFT

○	●	●	€
LP012A	LP012B	LP012G	

MORE INFORMATIONS AT PAGE 52



TIMING COVER

MODEL	YEAR	CODE	COLOR	€
848	08>	ZDM066B	●	

LEXAN® SPARE PCODE ZDM066-02 € 18,00 (screws included)

DUCATI® 1098



racing DNA



APPLICATION LIST

REAR SET CONTROL KIT	108
REVERSED GEARCHANGE LEVER	108
BRAKE LEVER	108
CLUTCH LEVER	108
LICENSE PLATE SUPPORT "FOX"	109
TIMING BELT COVER	109
SPROCKET COVER	126
CLUTCH COVER	124
PRESSURE PLATE	125
ENGINE OIL FILLER CAP	126
PROGUARD SYSTEM®	127
REAR INDICATOR LIGHTS (UNIVERSAL)	44
GRIPS Ø 22 mm (UNIVERSAL)	56
HANDLEBAR CAPS (UNIVERSAL)	60
FRONT BRAKE FLUID CAP/TANK (UNIVERSAL)	70
CLUTCH FLUID CAP/TANK (UNIVERSAL)	70
REAR BRAKE FLUID CAP/TANK (UNIVERSAL)	70



REAR SET CONTROL KIT

info

Upward adjustment 10>20mm
 Backward adjustment 10>20mm
 Diagonal adjustment 10>20mm
 Compatibility with folding pegs PE608A: NO
 Reversed gear change lever: YES, using PE206B

MODEL	YEAR	CODE	COLOR	€
1098	07>	PE207B	●	



REVERSED GEARCHANGE LEVER

MODEL	YEAR	CODE	COLOR	€
1098	07>	PE206B	●	

BRAKE LEVER

MODEL	YEAR	○	●	●	€
1098	07>	LB500A	LB500B	LB500G	

CLUTCH LEVER

MODEL	YEAR	○	●	●	€
1098	07>	LC500A	LC500B	LC500G	



design registration # 524939

LICENSE PLATE SUPPORT "FOX"



design registration # 524939

MODEL	YEAR	CODE	COLOR	€
1098	07>	PT503B	●	

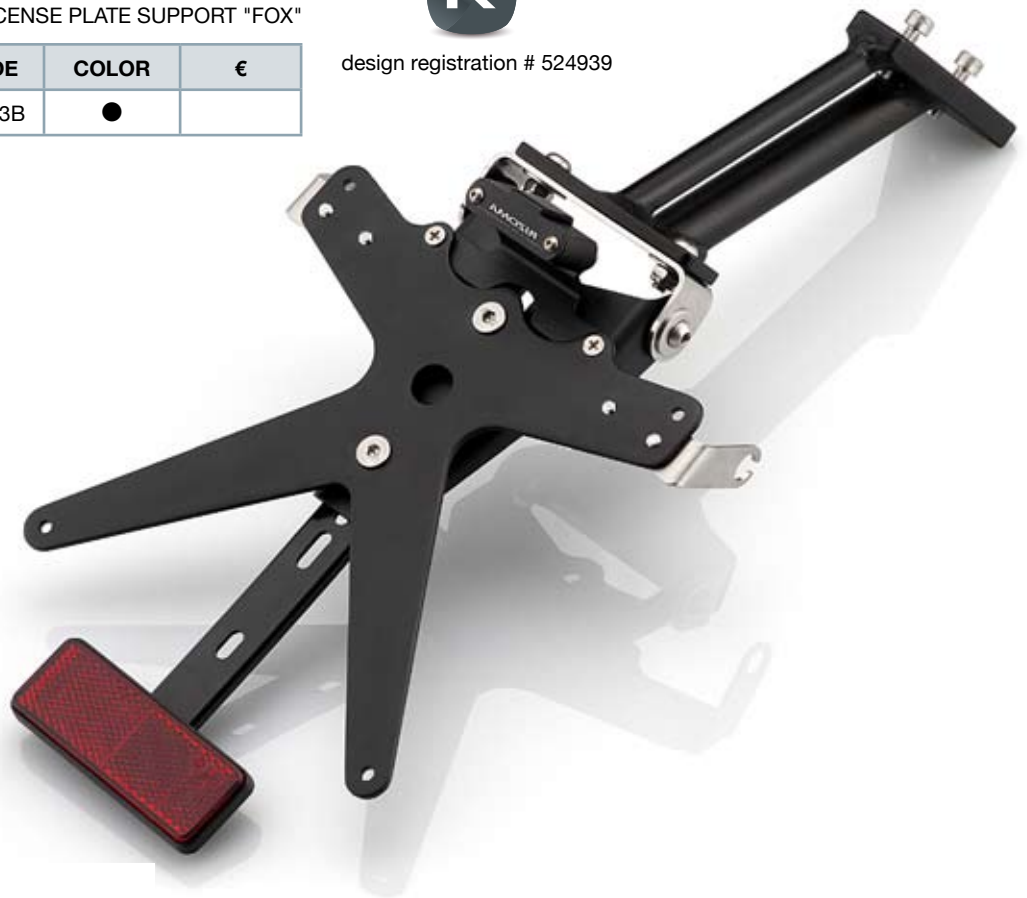

TIMING BELT COVER

MODEL	YEAR	CODE	COLOR	€
1098	07>	ZDM066B	●	

LEXAN® SPARE PCODE ZDM066-02 € 18,00 (screws included)



take a look

see p. 122-127



fearless look

APPLICATION LIST

CONICAL HANDLEBAR ADAPTER H.42mmx	112
BRAKE LEVER	112
CLUTCH LEVER	112
REAR SET CONTROL KIT	112
PASSENGER PEGS	113
LICENSE PPLATE SUPPORT "FOX"	113
SPROCKET COVER	113
TIMING BELT COVER	114
CABLE COVER	114
CHAIN GUARD	114
ENGINE GUARD (PAIR)	115
MIRROR ADAPTER 10x1.25	115
FRONT INDICATOR LIGHT ADAPTERS (PAIR)	115
PRESSURE PLATE	125
ENGINE OIL FILLER CAP	126
CRANKSHAFT COVER	127
CLUTCH COVER	124
HANDLEBARS (UNIVERSAL)	64
MIRRORS (UNIVERSAL)	10
PROGUARD SYSTEM® (UNIVERSAL)	52
GRIPS Ø 22 mm (UNIVERSAL)	56
HANDLEBAR CAPS (UNIVERSAL)	60
FRONT BRAKE FLUID TANK ADAPTER (UNIVERSAL)	70
FRONT BRAKE FLUID TANK/CAP (UNIVERSAL)	70
CLUTCH FLUID TANK/CAP (UNIVERSAL)	70
REAR BRAKE FLUID TANK/CAP (UNIVERSAL)	70
INDICATOR LIGHTS (UNIVERSAL)	44



info

- screws included
- conical handlebars at page 65



CONICAL HANDLEBAR CLAMPS

MODEL	YEAR	CODE	HEIGHT	COLOR	€ (PAIR)
1100/1100S	07>	AZ402B	42 mm	●	
1100/1100S	07>	AZ403B	60 mm	●	



BRAKE LEVER

MODEL	YEAR	○	●	●	€
1100/1100S	07>	LB201A*	LB201B*	LB201G*	

CLUTCH LEVER

MODEL	YEAR	○	●	●	€
1100/1100S	07>	LC500A*	LC500B*	LC500G*	

* Doesn't fit with stock PROGUARD SYSTEM®



design registration # 524939



info

Technical Information for PE208B

Upward adjustment	10>20mm
Backward adjustment	10>20mm
Diagonal adjustment	10>20mm
Compatibility with folding pegs PE608A:	NO
Reversed gear change lever: YES, using	PE210B

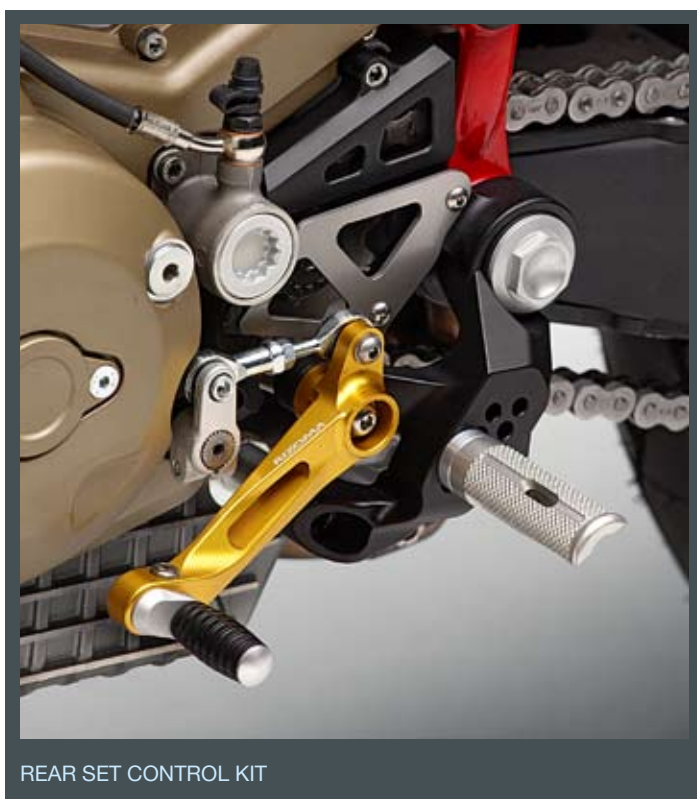

REAR SET CONTROL KIT

MODEL	YEAR	CODE	COLOR	€ (PAIR)
1100/1100S	07>	PE208B	●	



PASSENGER PEGS

MODEL	YEAR	CODE	COLOR	€ (PAIR)
1100/1100S	07>	PE573B	●	



LICENSE PLATE SUPPORT "FOX"

info

Our license plate support kit includes: license plate support, license plate support light, indicator lights support, reflector kit



design registration # 524939

MODEL	YEAR	CODE	COLOR	€
1100/1100S	07>	PT504B	●	



SPROCKET COVER

MODEL	YEAR	CODE	COLOR	€
1100/1100S	07>	ZDM084B	●	

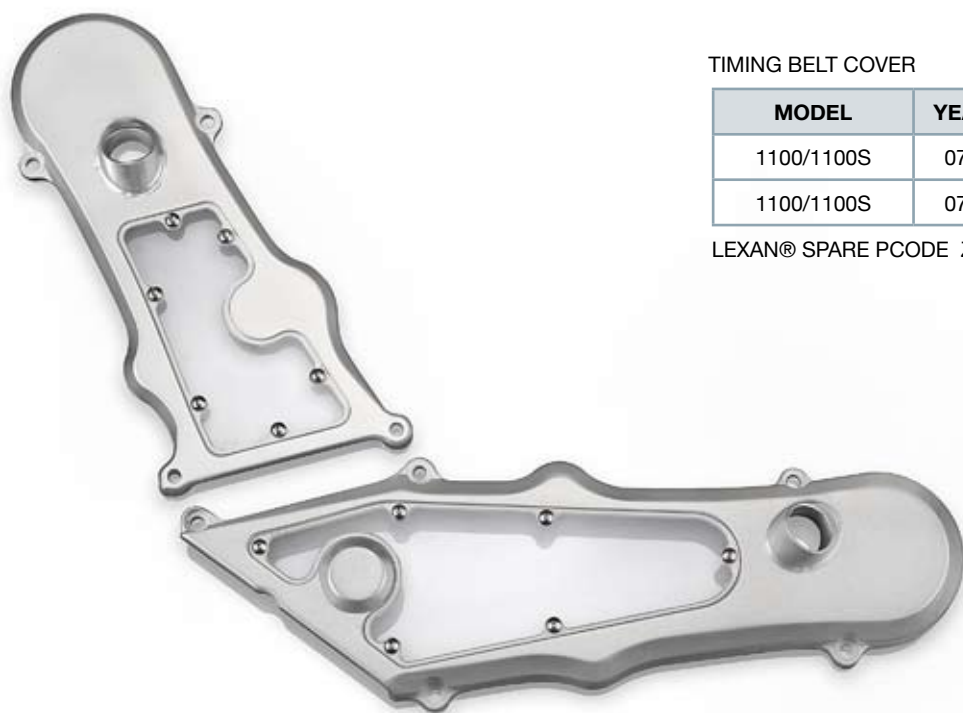

TIMING BELT COVER

MODEL	YEAR	CODE	COLOR	€
1100/1100S	07>	ZDM019A	○	
1100/1100S	07>	ZDM019B	●	

LEXAN® SPARE PCODE ZDM019-034 (screws included)

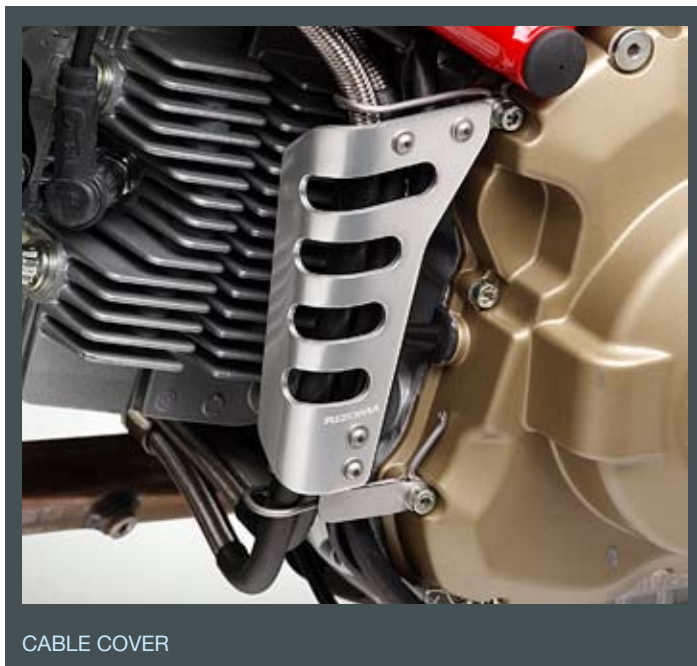

CABLE COVER

MODEL	YEAR	CODE	COLOR	€
1100/1100S	07>	ZDM081A	○	

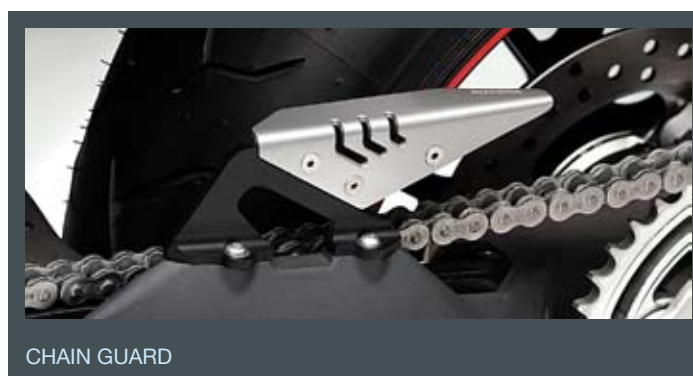

CHAIN GUARD

MODEL	YEAR	CODE	COLOR	€
1100/1100S	07>	ZDM082A	○	



ENGINE GUARD

MODEL	YEAR	CODE	€ (PAIR)
1100/1100S	07>	PM500B	



MIRROR ADAPTERS (10x1.25)



MODEL	YEAR	CODE	COLOR	€ (EACH)
1100 /1100S	07>	BS770B	●	

FRONT INDICATOR LIGHT ADAPTERS



MODEL	YEAR	CODE	COLOR	€ (PAIR)
1100 /1100S	07>	FR411B	●	

take a look

see p. 122-127



DUCATI® MONSTER



contemporary art

APPLICATION LIST

CONICAL HANDLEBAR ADAPTER H.42mmx	118
UPPER TRIPLE TREE WITH CLIP-ON BARS KIT	118
REAR SET CONTROL KIT	119
PASSENGER PEGS	119
TIMING BELT COVER	120
LICENSE PPLATE SUPPORT "FOX"	121
ENGINE GUARD	121
BRAKE LEVER	127
CLUTCH LEVER	127
PROGUARD SYSTEM®	127
SPROCKET COVER	125
CRANKSHAFT COVER	126
CLUTCH COVER	124
PRESSURE PLATE	125
ENGINE OIL FILLER CAP	126
HANDLEBARS	64
MIRRORS	10
GRIPS Ø 22 mm	56
HANDLEBAR CAPS	60
FRONT BRAKE FLUID TANK ADAPTER	70
FRONT BRAKE FLUID TANK/CAP	70
CLUTCH FLUID TANK/CAP	70
REAR BRAKE FLUID TANK/CAP	70
INDICATOR LIGHTS	44





CONICAL HANDLEBAR ADAPTERS

MODEL	YEAR	CODE	COLOR	€ (PAIR)
620/695/750/800/900/1000*	ALL	AZ405B	●	
MULTISTRADA 620	05>06	AZ405B	●	

*ECCEP TO MONSTER S4 E 696



UPPER TRIPLE TREE WITH CLIP-ON BARS KIT



design registration # 524939

MODEL	YEAR	CODE	€ (PAIR)
1000	02>05	PA202D	
620	01>06	PA202D	
695	06>08	PA202D	
800	02>05	PA202D	
S2R	04>07	PA202D	
S4	01>04	PA202D	
S4R	03>06	PA202D	

info

Technical Information for PE201B

Upward adjustment	10>20 mm
Backward adjustment	10>20 mm
Diagonal adjustment	10>20 mm
Compatibility with folding pegs PE608B:	YES
Reversed gear change lever:	NO



REAR SET CONTROL KIT

MODEL	YEAR	CODE	COLOR	€
600/620/695	ALL	PE201B	●	
750	96 >02	PE201B	●	
800/900/1000	ALL	PE201B	●	
S4	ALL	PE201B	●	

ADAPTER CODE PE 569B IS REQUIRED FOR MOUNTED IN HIGH POSITION
MUFFLERS €

PASSENGER PEGS KIT FOR RIZOMA REAR SET CONTROLS (EXCEPT MODELS S2R/S4R)

CODE	COLOR	€ (PAIR)
PE568B	●	



REAR SET CONTROL KIT



MODEL	YEAR	CODE	COLOR	€
S2R	04>07	PE202B	●	
S4R	01>04	PE202B	●	
S4RS T.S.	06>08	PE202B	●	



TIMING BELT COVER

MODEL	YEAR	CODE	COLOR	€
1000	02>05	ZDM019A	○	
1000	02>05	ZDM019B	●	
S2R 1000	06>08	ZDM019A	○	
S2R 1000	06>08	ZDM019B	●	

LEXAN® SPARE PCODE ZDM019-034 (screws included)

MODEL	YEAR	○	●	€
750	96>02	ZDM016A	ZDM016B	
S2R 800	04>07	ZDM016A	ZDM016B	
600	94>02	ZDM016A	ZDM016B	
800	02>05	ZDM016A	ZDM016B	
620	01>06	ZDM016A	ZDM016B	
900	93>02	ZDM018A		

LEXAN® SPARE PART CODE ZDM016-0345 (screws included)



TIMING BELT COVER



LICENSE PLATE SUPPORT "FOX"

MODEL	YEAR	CODE	COLOR	€
ALL	ALL	PT500B	●	



design registration # 524939

ENGINE GUARD

MODEL	YEAR	CODE	€ (PAIR)
ALL	ALL	PM350B	



take a look

p. 122-127



more...



info

The many versions and colors of our Clutch Cover and Pressure Plates can be installed on any dry clutch Ducati motorcycle. Models excluded are the 600, 620, 696, 750 and 800



CLUTCH COVER

MODEL	○	●	●	●	€
ALL	ZDM026A	ZDM026B	ZDM026G	ZDM026R	

LEXAN® SPARE CODE: CODE ZDM026-02



CLUTCH COVER

MODEL	○	●	●	€
ALL	ZDM025A	ZDM025B	ZDM025G	

LEXAN® SPARE CODE: CODE ZDM025-02



CLUTCH COVER

MODEL	○	●	●	●	€
ALL	ZDM024A	ZDM024B	ZDM024G	ZDM024R	

NATURAL AND BLACK CARBON PROTECTIONS INCLUDED



PRESSURE PLATE

MODEL	○	●	●	●	€
ALL	ZDM085A	ZDM085B	ZDM085G	ZDM085R	

- The many versions and colors of our Clutch Cover and Pressure Plates can be installed on any dry clutch Ducati motorcycle. Models excluded are the 600, 620, 696, 750 and 800.
- Not compatible with anti hopping (slipper) clutch

PRESSURE PLATE

MODEL	○	●	●	●	€
ALL	ZDM036A	ZDM036B	ZDM036G	ZDM036R	

- The many versions and colors of our Clutch Cover and Pressure Plates can be installed on any dry clutch Ducati motorcycle. Models excluded are the 600, 620, 696, 750 and 800.
- Not compatible with anti hopping (slipper) clutch



CRANKSHAFT COVER

MODEL	YEAR	●	●	€
MONSTER 1000	02>05	ZDM086B	ZDM086G	
MONSTER S2R	02>05	ZDM086B	ZDM086G	



ENGINE OIL FILLER CAP

MODEL	YEAR	○	●	●	●	●	€
ALL	ALL	TP010A	TP010B	TP010G	TP010R	TP010U	



FLUID TANK CAP DIA.49mm

MODEL	YEAR	○	●	●	●	€
ALL	ALL	TP016A	TP016B	TP016G	TP016R	

FLUID TANK CAP M32x4

MODEL	YEAR	○	●	●	●	€
ALL	ALL	TP017A	TP017B	TP017G	TP017R	

MODEL	YEAR	○	●	€
ALL	ALL	ZDM014A	ZDM014B	

Natural and black carbon protections included

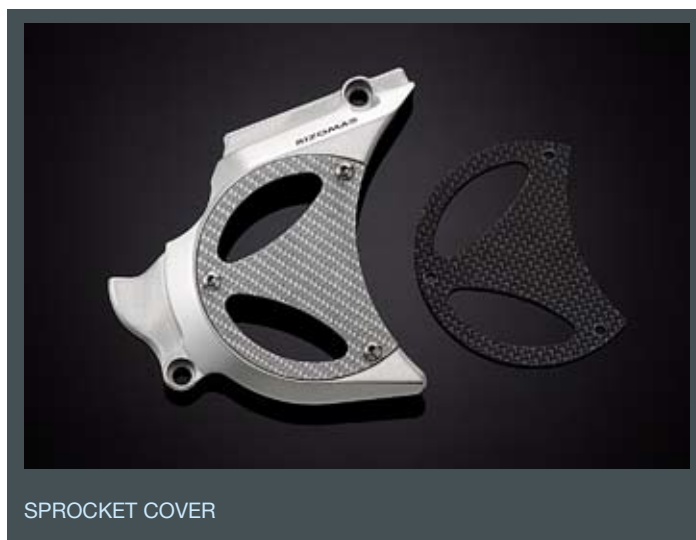

MODEL	YEAR	○	€
ALL	ALL	ZDM015A	





PROGUARD SYSTEM®

RIGHT

○	●	●	€
LP011A	LP011B	LP011G	

LEFT

○	●	●	€
LP012A	LP012B	LP012G	

MORE INFORMATION AT PAGE 52



design registration # 524939

BRAKE/CLUTCH LEVER

MODEL	YEAR	BRAKE LEVER				CLUTCH LEVER			
		○	●	●	€	○	●	●	€
749	03>07	LB500A	LB500B	LB500G		LC500A	LC500B	LC500G	
999	02>06	LB500A	LB500B	LB500G		LC500A	LC500B	LC500G	
1098	07>	LB500A	LB500B	LB500G		LC500A	LC500B	LC500G	
MONSTER 620	01>06	LB502A	LB502B	LB502G		LC502A	LC502B	LC502G	
MONSTER 695	06>08	LB502A	LB502B	LB502G		LC502A	LC502B	LC502G	
MONSTER 750	96>02	LB502A	LB502B	LB502G		LC502A	LC502B	LC502G	
MONSTER S2R	04>07	LB502A	LB502B	LB502G		LC502A	LC502B	LC502G	
MONSTER 1000	02>05	LB501A	LB501B	LB501G		LC501A	LC501B	LC501G	
MONSTER S2R 1000	05>07	LB501A	LB501B	LB501G		LC501A	LC501B	LC501G	
MONSTER S4R	07>08	LB500A	LB500B	LB500G		LC500A	LC500B	LC500G	
MONSTER S4R	03>06	LB501A	LB501B	LB501G		LC501A	LC501B	LC501G	
MONSTER S4RS T.S.	06>08	LB500A	LB500B	LB500G		LC500A	LC500B	LC500G	
MULTISTRADA 620	05>06	LB502A	LB502B	LB502G		LC502A	LC502B	LC502G	
MULTISTRADA 1100	07>	LB501A	LB501B	LB501G		LC501A	LC501B	LC501G	
HYPERMOTARD 1100	07>	LB201A	LB201B	LB201G		LC500A	LC500B	LC500G	
SPORT 1000	06>	LB501A	LB501B	LB501G		LC501A	LC501B	LC501G	
ST3	04>07	LB501A	LB501B	LB501G		LC501A	LC501B	LC501G	
ST4S	04>05	LB501A	LB501B	LB501G		LC501A	LC501B	LC501G	



dynamic & classic

APPLICATION LIST

UPPER TRIPLE TREE	130
REAR SET CONTROL KIT	130
UNDERTAIL	131
LICENSE PPLATE SUPPORT "FOX" (PER NS ZHH046K)	131
CHAIN GUARD	132
TOE GUARD	132
CHAIN ADJUSTER KIT	132
ENGINE GUARD - LEFT	133
CRANKCASE	133
FAIRING GUARD	133
PROGUARD SYSTEM®	134
BRAKE LEVER	134
CLUTCH LEVER	134
ENGINE OIL FILLER CAP	134
MIRRORS (UNIVERSAL)	10
INDICATOR LIGHTS (UNIVERSAL)	44
GRIPS D.22 mm (UNIVERSAL)	56
HANDLEBAR CAPS (UNIVERSAL)	60
FRONT BRAKE FLUID TANK/CAP (UNIVERSAL)	70
REAR BRAKE FLUID TANK/CAP (UNIVERSAL)	70
BIKE STAND SUPPORT (PAIR) (UNIVERSAL)	92





UPPER TRIPLE TREE

MODEL	YEAR	CODE	COLOR	€
CBR 1000 RR	08>	PA360A	○	
CBR 1000 RR	08>	PA360B	●	

Technical information for PA360A/PA360B

- weight 480 gr (180 gr lighter than the original one)
- less bending while braking and in the max fold
- more sensitive contact with the front tyre



info

Technical Information for PE078B

Upward adjustment	10>20mm
Backward adjustment	10>20mm
Diagonal adjustment	10>20mm
Reversed gear change lever for PE078B	YES
Reversed gear change lever for PE070B	NO
Reversed gear change lever for PE098B	NO



REAR SET CONTROL KIT

MODEL	YEAR	CODE	COLOR	€
CBR 1000 RR	08>	PE078B	●	
CBR 1000 RR	06>07	PE070B	●	
CBR 1000 RR	04>05	PE068B	●	



MODEL	YEAR	CODE	COLOR	€
CBR 1000 RR	08>	ZHH046K		

take a look

see universal accessories 44-51



LICENSE PLATE SUPPORT "FOX"

MODEL	YEAR	CODE	COLOR	€
CBR 1000 RR	08>	PT102B*	●	
CBR 1000 RR	06>07	PT100B	●	
CBR 1000 RR	04>05	PT100B	●	

* THE SUPPORT PLATE CAN BE MOUNTED JUST WITH THE UNDERTAIL ZHH046K



design registration # 524939

HONDA® CBR 1000 RR



CHAIN GUARD

MODEL	YEAR	CODE	COLOR	€
CBR 1000 RR	08>	ZHH041A	○	



TOE PROTECTION

MODEL	YEAR	CODE	COLOR	€
CBR 1000 RR	08>	FG030B	●	
CBR 1000 RR	06>07	FG030B	●	
CBR 1000 RR	04>05	FG030B	●	



CHAIN ADJUSTER

MODEL	YEAR	CODE	COLOR	€
CBR 1000 RR	08>	TC020G	●	
CBR 1000 RR	06>07	TC020G	●	
CBR 1000 RR	04>05	TC020G	●	



ENGINE PROTECTION (LEFT SIDE)

MODEL	YEAR	CODE	COLOR	€
CBR 1000 RR	08>	PM520A	○	



CRANKCASE

MODEL	YEAR	○	●	●	●	●	€
CBR 1000 RR	08>	ZHH052A	ZHH052B	ZHH052G	ZHH052R	ZHH052U	
CBR 1000 RR	06>07	ZHH052A	ZHH052B	ZHH052G	ZHH052R	ZHH052U	



ENGINE GUARD

MODEL	YEAR	CODE	COLOR	€
CBR 1000 RR	06>07	PM112B	●	
CBR 1000 RR	04>05	PM110B	●	



PROGUARD SYSTEM®

RIGHT

○	●	●	€
LP011A	LP011B	LP011G	

LEFT

○	●	●	€
LP012A	LP012B	LP012G	

MORE INFORMATIONS AT PAGE 52



design registration # 524939

BRAKE/CLUTCH LEVER

MODEL	YEAR	BRAKE LEVER				CLUTCH LEVER			
		○	●	●	€	○	●	●	€
CBR 1000 RR	08>	LB104A	LB104B	LB104G		LC200A	LC200B	LC200G	
CBR 1000 RR	06>07	LB103A	LB103B	LB103G		LC101A	LC101B	LC101G	
CBR 1000 RR	04>05	LB103A	LB103B	LB103G		LC101A	LC101B	LC101G	



ENGINE OIL FILLER CAP

MODEL	YEAR	○	●	●	●	●	€
ALL	ALL	TP008A	TP008B	TP008G	TP008R	TP008U	

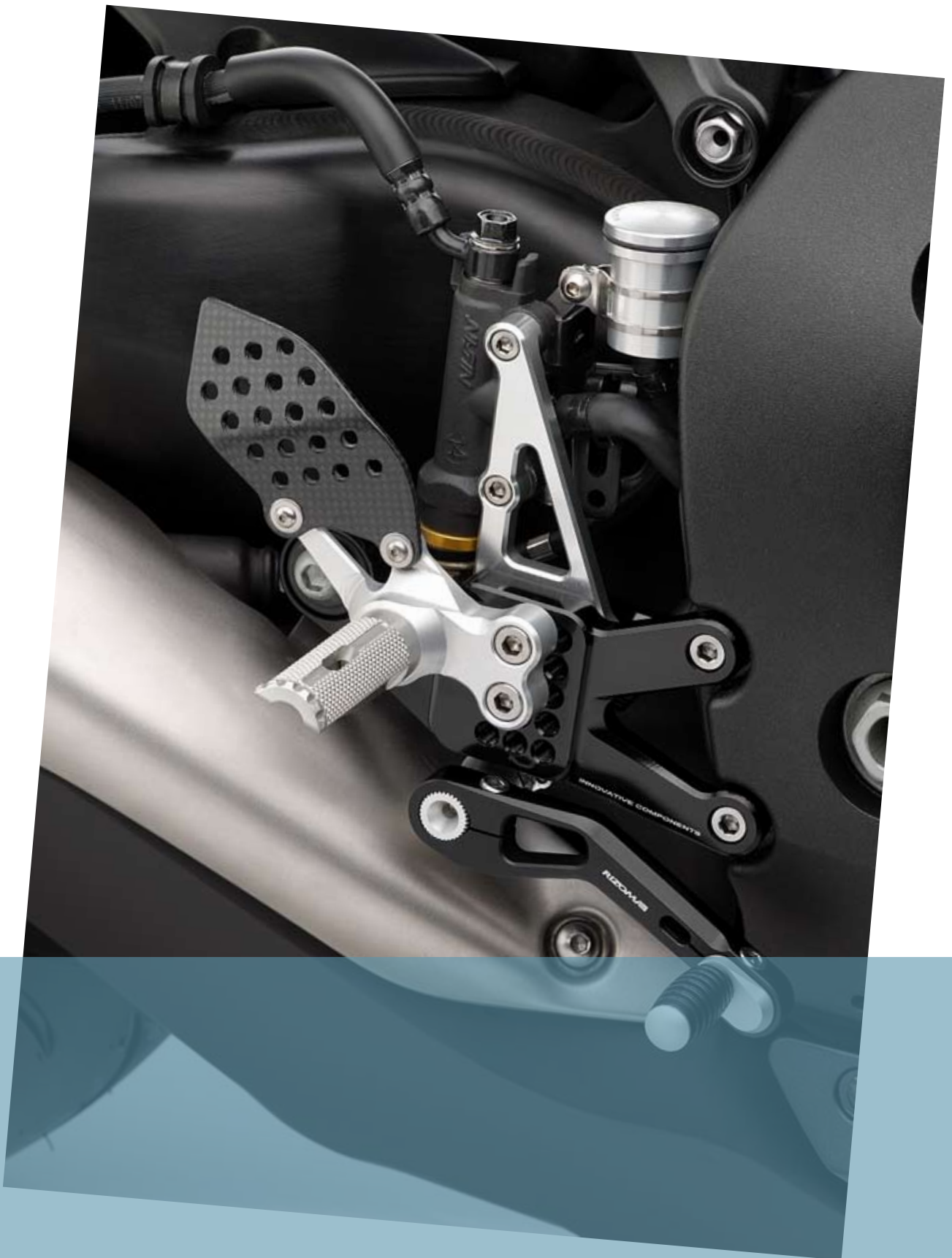



lively character

APPLICATION LIST

REAR SET CONTROL KIT	138
FAIRING GUARD	138
BRAKE LEVER	139
CLUTCH LEVER	139
LICENSE PPLATE SUPPORT "FOX"	139
CRANKCASE	139
PROGUARD SYSTEM®	52
RIDER/ PASSENGER RACING PEGS	90
MIRRORS (UNIVERSAL)	10
INDICATOR LIGHTS (UNIVERSAL)	44
GRIPS Ø 22 mm (UNIVERSAL)	56
HANDLEBAR CAPS(UNIVERSAL)	60
FRONT BRAKE FLUID TANK/CAP. (UNIVERSAL)	70
ENGINE OLI FILLER CAP (UNIVERSAL)	76
BIKE STAND SUPPORT (PAIR) (UNIVERSAL)	92



info

Technical Information for PE071B

Upward adjustment	10>20mm
Backward adjustment	10>20mm
Diagonal adjustment	10>20mm
Compatibility with folding pegs PE608A:	YES
Reversed gear change lever:	YES using PE072B



take a look

see universal accessories p. 70



REAR SET CONTROL KIT

MODEL	YEAR	CODE	COLOR	€
CBR 600 RR	07>08	PE071B	●	



FAIRING GUARD

MODEL	YEAR	CODE	COLOR	€
CBR 600 RR	07>08	PM113B	●	
CBR 600 RR	03>06	PM108B	●	



design registration # 524939

BRAKE/CLUTCH LEVER

MODEL	YEAR	BRAKE LEVER				CLUTCH LEVER			
		○	●	●	€	○	●	●	€
CBR 600 RR	07>08	LB104A	LB104B	LB104G		LC200A	LC200B	LC200G	
CBR 600 RR	03>06	LB102A	LB102B	LB102G		LC200A	LC200B	LC200G	

LICENSE PLATE SUPPORT "FOX"

MODEL	YEAR	CODE	COLOR	€
CBR 600 RR	07>08	PT101B	●	
CBR 600 RR	03>06	PT100B	●	



design registration # 524939



CRANKCASE

MODEL	YEAR	○	●	●	●	●	€
CBR 600 RR	07>08	ZHH052A	ZHH052B	ZHH052G	ZHH052R	ZHH052U	
CBR 600 RR	03>06	ZHH052A	ZHH052B	ZHH052G	ZHH052R	ZHH052U	



futuristic proposal

APPLICATION LIST

CLIP-ON BARS KIT	142
CONICAL HANDLEBAR ADAPTERS	142
BRAKE LEVER	142
CLUTCH LEVER	142
PROGUARD SYSTEM®	143
REAR SET CONTROL KIT	143
FAIRING GUARD	143
CHAIN GUARD	144
TOE PROTECTION	144
HUB SAFETY COVER (PAIR)	144
LICENSE PLATE SUPPORT "FOX"	145
ENGINE PROTECTION, LEFT	145
CRANKCASE	145
RIDER/PASSENGER PEGS	90
MIRRORS (UNIVERSAL)	10
INDICATOR LIGHTS (UNIVERSAL)	44
GRIPS Ø 22 mm (UNIVERSAL)	56
HANDLEBAR CAPS (UNIVERSAL)	60
FRONT BRAKE FLUID TANK/CAP (UNIVERSAL)	70
ENGINE OIL FILLER CAPS (UNIVERSAL)	76
BIKE STAND SUPPORT (UNIVERSAL)	92





CLIP-ON BARS KIT

MODEL	YEAR	CODE	COLOR	€
CB1000R	08>	MA206B	●	



take a look

see universal accessories p. 64

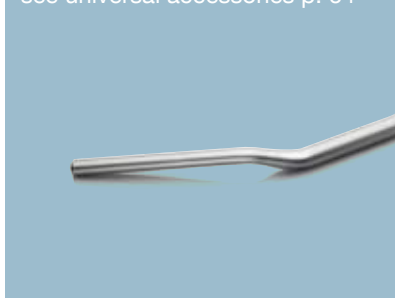

CONICAL HANDLEBAR CLAMPS

MODEL	YEAR	CODE.	COLOR	€ (PAIR)
CB1000R	08>	AZ405B	●	



BRAKE/CLUTCH LEVERS

MODEL	YEAR	BRAKE LEVER			€
		○	●	●	
CB1000R	08>	LB103A	LB103B	LB103G	

MODEL	YEAR	CLUTCH LEVER			€
		○	●	●	
CB1000R	08>	LC101A	LC101B	LC101G	



design registration # 524939



PROGUARD SYSTEM®

RIGHT

○	●	●	€
LP011A	LP011B	LP011G	

LEFT

○	●	●	€
LP012A	LP012B	LP012G	

MORE INFORMATIONS AT PAGE 52



PROGUARD SYSTEM®



REAR SET CONTROL KIT

info

Technical information PE080B

Upwards	10>20 mm
Backwards	10>20 mm
Diagonal	10>20 mm
Compatibilità con Pedana snodata PE608A: (utilizzando V08X20BC al posto della vite fornita e utilizzando rondella fornita)	YES
Reversed gearchange Lever:	YES with PE079B



MODEL	YEAR	CODE	COLOR	€
CB1000R	08>	PE080B	●	

ENGINE GUARD

MODEL	YEAR	CODE.	COLOR	€
CB1000R	08>	PM101B	●	





CHAIN GUARD

MODEL	YEAR	CODE	COLOR	€
CB1000R	08>	ZHH053A	○	



TOE PROTECTION

MODEL	YEAR	CODE	COLOR	€
CB1000R	08>	FG031A	○	



HUB SAFETY COVER (PAIR)

MODEL	YEAR	CODE	COLOR	€
CB1000R	08>	ZHH054A	○	



LICENSE PLATE SUPPORT "FOX"

MODEL	YEAR	CODE	COLOR	€
CB1000R	08>	PT103B	●	



ENGINE PROTECTION LEFT

MODEL	YEAR	CODE	COLOR	€
CB1000R	08>	PM521A	○	



CRANKCASE

MODEL	YEAR	CODE	COLOR	€
CB1000R	08>	ZHH052A	○	
CB1000R	08>	ZHH052B	●	
CB1000R	08>	ZHH052G	●	
CB1000R	08>	ZHH052R	●	
CB1000R	08>	ZHH052U	●	

HONDA® HORNET



fast & flexible

APPLICATION LIST

CONICAL HANDLEBAR ADAPTERS Ø 22-29 mm	148
REAR SET CONTROL KIT	148
CRANKCASE	148
ENGINE GUARD	149
CHAIN GUARD	149
FAIRING HOLE CAPS	149
RIDER/PASSENGER PEGS	90
HANDLEBARS (UNIVERSAL)	64
GRIPS Ø 22 mm	56
HANDLEBAR CAPS(UNIVERSAL)	60
MIRRORS (UNIVERSAL)	10
INDICATOR LIGHTS (UNIVERSAL)	44
ENGINE OIL FILLER CAP (UNIVERSAL)	76
BIKE STAND SUPPORT (PAIR) (UNIVERSAL)	92



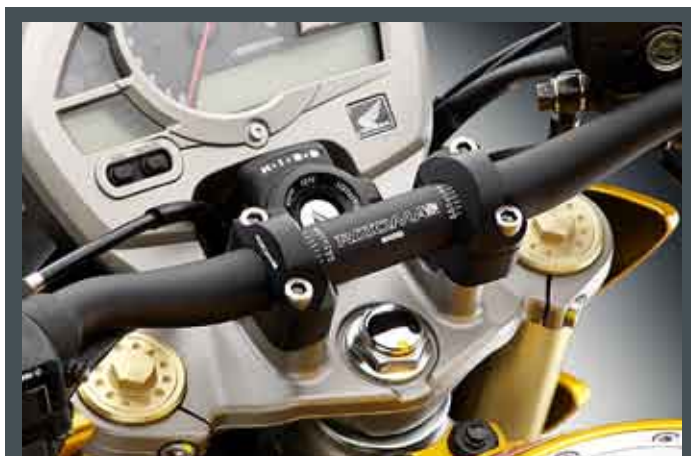
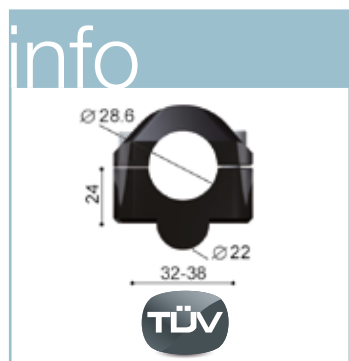

CONICAL HANDLEBAR CLAMPS

MODEL	YEAR	CODE	€ (PAIR)
HORNET	03>	AZ405B	



REAR SET CONTROL KIT

info

Technical Information for PE073B/PE062B

Upward adjustment	10>20mm
Backward adjustment	10>20mm
Diagonal adjustment	10>20mm
Reversed gear change lever:	NO
Compatibility with folding pegs PE608A:	YES
Passenger pegs for Rizoma rearset controls: PE575B (07> models) - PE565B (00>06 models)	



MODEL	YEAR	CODE	COLOR	€
HORNET	07>	PE073B	●	
HORNET	00>06	PE062B	●	



CRANKCASE

MODEL	YEAR	○	●	●	●	●	€
HORNET	00>	ZHH052A	ZHH052B	ZHH052G	ZHH052R	ZHH052U	



ENGINE GUARD

MODEL	YEAR	CODE	COLOR	€ (PAIR)
HORNET	07>	PM101B	●	
HORNET	05>06	PM100B	●	
HORNET	03>04	PM100B	●	
HORNET	00>02	PM100B	●	



CHAIN GUARD

MODEL	YEAR	CODE	COLOR	€
HORNET	07>	ZHH034A	○	



TAPPI FORI MANIGLIA

MODEL	YEAR	CODE	COLOR	€ (PAIR)
HORNET	05>06	ZHH032A	○	
HORNET	03>04	ZHH032A	○	



racing quality

APPLICATION LIST

REAR SET CONTROL KIT	152
RIDER/ PASSENGER RACING PEGS	152
BRAKE LEVER	152
CLUTCH LEVER	152
PROGUARD SYSTEM®	153
LICENSE PPLATE SUPPORT "FOX"	153
FAIRING GUARD	153
CHAIN GUARD	154
TOE PROTECTION	154
CHAIN ADJUSTER KIT	154
MIRRORS PER MODELLI 04>07 (UNIVERSAL)	10
INDICATOR LIGHTS (UNIVERSAL)	44
GRIPS Ø 22 mm (UNIVERSAL)	56
HANDLEBAR CAPS(UNIVERSAL)	60
FRONT BRAKE FLUID TANK/CAPE. (UNIVERSAL)	70
REAR BRAKE FLUID TANK/CAP (UNIVERSAL)	70
ENGINE OLI FILLER CAP (UNIVERSAL)	76
BIKE STAND SUPPORT (PAIR) (UNIVERSAL)	92



info

Technical Information for PE305B/PE306B/PE313B

Upward adjustment	10>20mm
Backward adjustment 1	0>20mm
Diagonal adjustment	10>20mm
Compatibility with folding pegs PE608A:	YES
Reversed gear change lever:	NO



MODEL	YEAR	CODE	COLOR	€
ZX-10R	08>	PE313B	●	
ZX-10R	06>07	PE306B	●	
ZX-10R	04>05	PE305B	●	



REAR SET CONTROL KIT



PASSENGER PEGS KIT

MODEL	YEAR	○	●	●	●	●	€
ZX-10R	06>	PE614A	PE614B	PE614G	PE614R	PE614U	

Adapters are required

PASSENGER PEGS ADAPTERS

MODEL	YEAR	CODE	COLOR	€
ZX-10R	08>	PE754A	○	
ZX-10R	06>07	PE752A	○	

BRAKE/CLUTCH LEVERS

BRAKE LEVER					
MODEL	YEAR	○	●	●	€
ZX-10R	08>	LB301A	LB301B	LB301G	
ZX-10R	06>07	LB301A	LB301B	LB301G	

CLUTCH LEVER					
MODEL	YEAR	○	●	●	€
ZX-10R	08>	LC301A	LC301B	LC301G	
ZX-10R	06>07	LC301A	LC301B	LC301G	



design registration # 524939



PROGUARD SYSTEM®

RIGHT

○	●	●	€
LP011A	LP011B	LP011G	

LEFT

○	●	●	€
LP012A	LP012B	LP012G	

MORE INFORMATIONS AT PAGE 52



design registration # 524939

LICENSE PLATE SUPPORT "FOX"

MODEL	YEAR	CODE	COLOR	€
ZX-10R	08>	PT307B	●	
ZX-10R	06>07	PT304B	●	
ZX-10R	04>05	PT301B	●	

take a look

see universal accessories p. 44-51



FAIRING GUARD

MODEL	YEAR	CODE	COLOR	€ (PAIR)
ZX-10R	08>	PM313B	●	



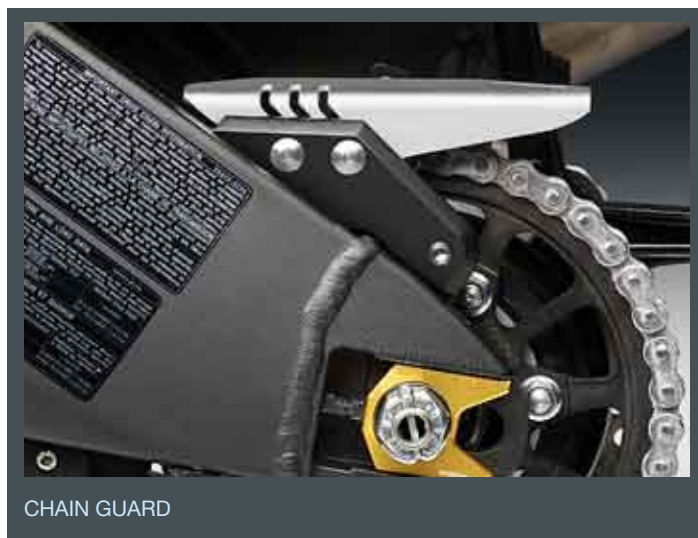

CHAIN GUARD

MODEL	YEAR	CODE	COLOR	€
ZX-10R	08>	ZKW006A	○E	

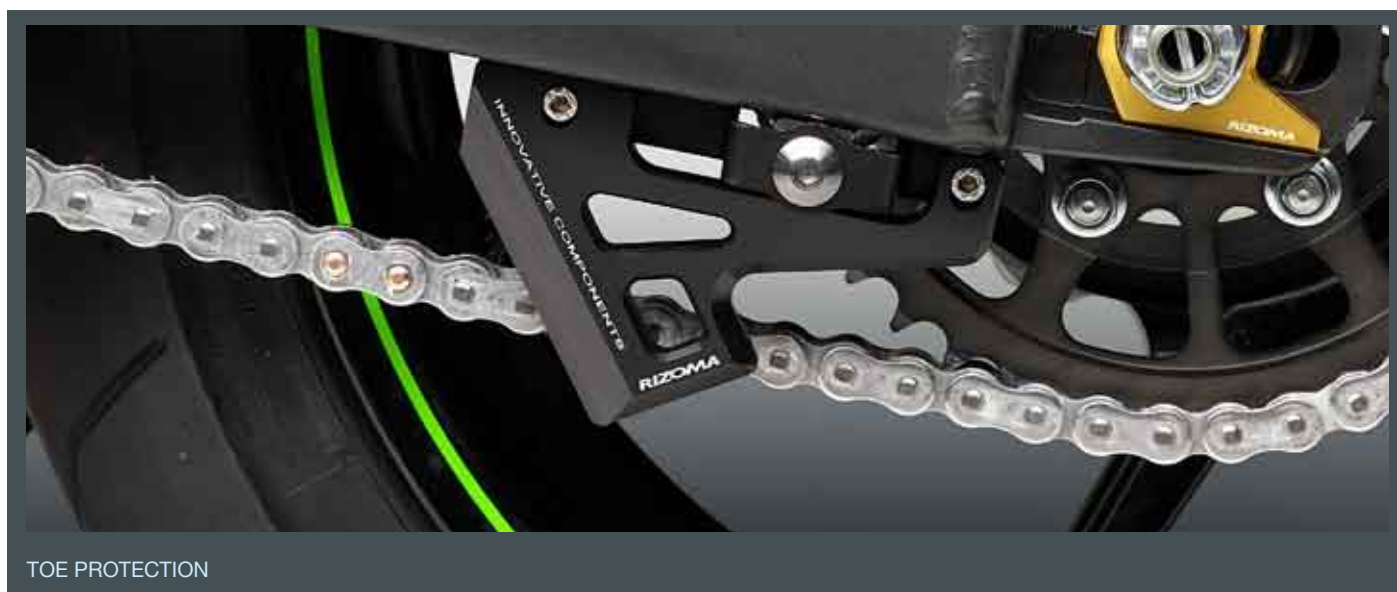

TOE PROTECTION

MODEL	YEAR	CODE	COLOR	€
ZX-10R	08>	FG040B	●	



CHAIN ADJUSTER

MODEL	YEAR	CODE	COLOR	€ (PAIR)
ZX-10R	08>	TC030G	●	





contemporary progress

APPLICATION LIST

REAR SET CONTROL KIT	158
LICENSE PPLATE SUPPORT "FOX"	158
BRAKE LEVER	159
CLUTCH LEVER	159
PROGUARD SYSTEM®	159
FAIRING GUARD	159
MIRRORS PER MODELLI 04>07 (UNIVERSAL)	10
INDICATOR LIGHTS (UNIVERSAL)	44
GRIPS Ø 22 mm (UNIVERSAL)	56
HANDLEBAR CAPS(UNIVERSAL)	60
FRONT BRAKE FLUID TANK/CAP. (UNIVERSAL)	70
REAR BRAKE FLUID TANK/CAP (UNIVERSAL)	70
ENGINE OIL FILLER CAP (UNIVERSAL)	76
BIKE STAND SUPPORT (PAIR) (UNIVERSAL)	92



info

Technical Information for PE310B

Upward adjustment	10>20mm
Backward adjustment	10>20mm
Diagonal adjustment	10>20mm
Compatibility with folding pegs PE608A	YES
Reversed gear change lever:	NO



MODEL	YEAR	CODE	COLOR	€
ZX-6R	07>08	PE310B	●	
ZX-6R	05>06	PE310B	●	



REAR SET CONTROL KIT



LICENSE PLATE SUPPORT "FOX"



Design registration # 524939

MODEL	YEAR	CODE	COLOR	€
ZX-6R	07>08	PT305B	●	
ZX-6R	05>06	PT302B	●	
ZX-6R	03>04	PT300B	●	



BRAKE/CLUTCH LEVERS



design registration # 524939

BRAKE/CLUTCH LEVERS

MODEL	YEAR	BRAKE LEVER				CLUTCH LEVER			
		○	●	●	€	○	●	●	€
ZX-6R	07>08	LB301A	LB301B	LB301G		LC301A	LC301B	LC301G	
ZX-6R	06>07	LB301A	LB301B	LB301G		LC301A	LC301B	LC301G	



PROGUARD SYSTEM®

RIGHT

○	●	●	€
LP011A	LP011B	LP011G	

LEFT

○	●	●	€
LP012A	LP012B	LP012G	

MORE INFORMATIONS AT PAGE 52



FAIRING GUARD

MODEL	YEAR	CODE	COLOR	€ (PAIR)
ZX-6R	07>08	PM310B	●	

KAWASAKI® Z1000



aggressive sincerity

APPLICATION LIST

CONICAL HANDLEBAR ADAPTERS	162
BRAKE LEVER	162
CLUTCH LEVER	162
PROGUARD SYSTEM®	163
LICENSE PPLATE SUPPORT "FOX"	163
REAR SET CONTROL KIT	164
EXHSAUST SYSTEM SUPPORT	164
PASSENGER PEGS KIT	164
SPROCKET COVER	165
ENGINE GUARD	165
HANDLEBARS (UNIVERSAL)	64
GRIPS Ø 22 mm (UNIVERSAL)	56
HANDLEBAR CAPS(UNIVERSAL)	60
PEDIVELLE PILOTA/PASSEGGERO (PAIR)	90
MIRRORS (UNIVERSAL)	10
INDICATOR LIGHTS (UNIVERSAL)	44
ENGINE OIL FILLER CAP (UNIVERSAL)	76
BIKE STAND SUPPORT (PAIR) (UNIVERSAL)	92





CONICAL HANDLEBAR CLAMPS

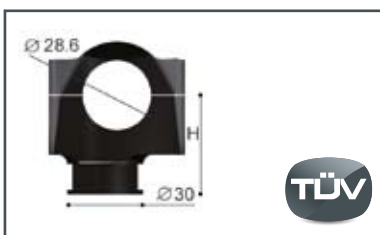

MODEL	YEAR	CODE	ALTEZZA	COLOR	€ (PAIR)
Z1000	07>	AZ402B	42 mm	●	
Z1000	03>06	AZ402B	42 mm	●	
Z1000	07>	AZ403B	60 mm	●	
Z1000	03>06	AZ403B	60 mm	●	

Conical handlebars at page 65



design registration # 524939

BRAKE LEVER

MODEL	YEAR	BRAKE LEVER			€
		○	●	●	
Z1000	07>	LB301A	LB301B	LB301G	
Z1000	03>06	LB100A	LB100B	LB100G	

CLUTCH LEVER

MODEL	YEAR	CLUTCH LEVER			€
		○	●	●	
Z1000	07>	LC301A	LC301B	LC301G	
Z1000	03>06	LC301A	LC301B	LC301G	



PROGUARD SYSTEM®

RIGHT

○	●	●	€
LP011A	LP011B	LP011G	

LEFT

○	●	●	€
LP012A	LP012B	LP012G	

MORE INFORMATIONS AT PAGE 52



LICENSE PLATE SUPPORT "FOX"

MODEL	YEAR	CODE	COLOR	€
Z1000	07>	PT306B	●	
Z1000	03>06	PT300B	●	



design registration # 524939

take a look

see universal accessories p. 56-59



info

Technical Information for PE303B

Upward adjustment	10>20mm
Backward adjustment	10>20mm
Diagonal adjustment	10>20mm
Compatibility with folding pegs PE608A	YES
Reversed gear change lever:	NO



MODEL	YEAR	CODE	COLOR	€
Z1000	07>	PE303B	●	
Z1000	03>06	PE300B	●	



REAR SET CONTROL KIT

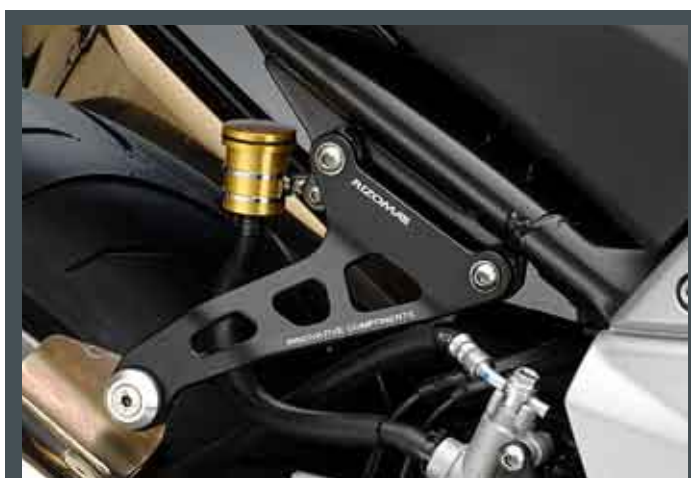

EXHAUST SYSTEM SUPPORT

MODEL	YEAR	CODE	POSIZ.	COLOR	€
Z1000	07>	ZKZ002B	SX	●	
Z1000	07>	ZKZ003B	DX	●	



PASSENGER PEGS FOR RIZOMA REAR SET CONTROLS

MODEL	YEAR	CODE	COLOR	€
Z1000	03>06	PE566B	●	



SPROCKET COVER

MODEL	YEAR	CODE	COLOR	€
Z1000	07>	ZKZ001A	●	



ENGINE GUARD

MODEL	YEAR	CODE	COLOR	€
Z1000	07>	PM311A	●	

FAIRING GUARD

MODEL	YEAR	CODE	€ (PAIR)
Z1000	03>06	PM305A	





agile design

APPLICATION LIST

REAR SET CONTROL KIT	168
EXHAUST SYSTEM SUPPORT - RIGHT SIDE	168
CONICAL HANDLEBAR ADAPTERS	169
BRAKE LEVER	169
CLUTCH LEVER	169
PROGUARD SYSTEM®	169
CHAIN GUARD	170
ENGINE GUARD	170
SPROCKET COVER	171
LICENSE PLATE SUPPORT "FOX"	171
HANDLEBARS (UNIVERSAL)	64
GRIPS Ø 22 mm (UNIVERSAL)	56
HANDLEBAR CAPS (UNIVERSAL)	60
RIDER/PASSENGER PEGS KIT	90
MIRRORS (UNIVERSAL)	10
INDICATOR LIGHTS (UNIVERSAL)	44
ENGINE OIL FILLER CAPS (UNIVERSAL)	76
BIKE STAND SUPPORT (PAIR)	92





REAR SET CONTROL KIT

info

Technical Information for PE303B

Upward adjustment	10>20mm
Backward adjustment	10>20mm
Diagonal adjustment	10>20mm
Compatibility with folding pegs PE608A:	YES
Reversed gear change lever:	NO



MODEL	YEAR	CODE	COLOR	€
Z750	07>	PE303B	●	

MODEL	YEAR	CODE	POSIZ.	COLOR	€
Z750	07>	ZKZ003B	RH	●	



EXHAUST SYSTEM SUPPORT - RIGHT SIDE

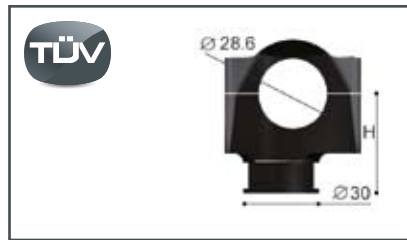

CONICAL HANDLEBAR CLAMPS

MODEL	YEAR	CODE	ALTEZZA	COLOR	€ (PAIR)
Z750	03>	AZ402B	42 mm	●	
Z750	03>	AZ403B	60 mm	●	

Conical handlebars at page 65



BRAKE LEVER

MODEL	YEAR	BRAKE LEVER			€
		○	●	●	
Z750	07>	LB550A	LB550B	LB550G	
Z750/Z750S	03>06	LB100A	LB100B	LB100G	

CLUTCH LEVER

MODEL	YEAR	CLUTCH LEVER			€
		○	●	●	
Z750	07>	LC301A	LC301B	LC301G	
Z750/Z750S	03>06	LC300A	LC300B	LC300G	



design registration # 524939



PROGUARD SYSTEM®

RIGHT

○	●	●	€
LP011A	LP011B	LP011G	

LEFT

○	●	●	€
LP012A	LP012B	LP012G	

MORE INFORMATIONS AT PAGE 52





CCODEER CATENA

MODEL	YEAR	CODE	COLOR	€
Z750	07>	ZKZ005A	○	

MODEL	YEAR	CODE	COLOR	€ (PAIR)
Z750	07>	PM312B	●	
Z750/Z750S	03>06	PM304B	●	



ENGINE GUARD



SPROCKET COVER

take a look

see universal accessories p. 10-43



MODEL	YEAR	CODE	COLOR	€
Z750	07>	ZKZ001A	●	



design registration # 524939

LICENSE PLATE SUPPORT "FOX"

MODEL	YEAR	CODE	COLOR	€
Z750	07>	PT306B	●	
Z750	03>06	PT300B	●	



Urban *power*

APPLICATION LIST

CONICAL HANDLEBAR ADAPTERS	174
BRAKE LEVER	174
CLUTCH LEVER	174
PROGUARD SYSTEM®	175
LICENSE PLATE SUPPORT "FOX"	175
ENGINE GUARD	175
HANDLEBARS (UNIVERSAL)	64
GRIPS Ø 22 mm (UNIVERSAL)	56
HANDLEBAR CAPS (UNIVERSAL)	60
RIDER/PASSENGER PEGS KIT	90
MIRRORS (UNIVERSAL)	10
INDICATOR LIGHTS (UNIVERSAL)	44
ENGINE OIL FILLER CAPS (UNIVERSAL)	76
BIKE STAND SUPPORT (PAIR)	92





CONICAL HANDLEBAR CLAMPS



MODEL	YEAR	CODE	COLOR	€ (PAIR)
ER6N / ER6F	05>08	AZ405B	●	

Conical handlebars at page 65

take a look

see universal accessories p. 60



design registration # 524939

MODEL	YEAR	BRAKE LEVER				CLUTCH LEVER			
		○	●	●	€	○	●	●	€
ER6N / ER6F	05>08	LB100A	LB100B	LB100G		LC300A	LC300B	LC300G	



PROGUARD SYSTEM®

RIGHT

○	●	●	€
LP011A	LP011B	LP011G	

LEFT

○	●	●	€
LP012A	LP012B	LP012G	

MORE INFORMATIONS AT PAGE 52



LICENSE PLATE SUPPORT "FOX"

MODEL	YEAR	CODE	COLOR	€
ER6N / ER6F	05>08	PT301B	●	



design registration # 524939

ENGINE GUARD

MODEL	YEAR	CODE	COLOR	€ (PAIR)
ER6N / ER6F	05>08	PM308B	●	



take a look

see universal accessories p. 56-59



KTM® 990 SUPER DUKE



power

APPLICATION LIST

CONICAL HANDLEBAR ADAPTERS	178
PROGUARD SYSTEM®	178
BRAKE LEVER	178
CLUTCH LEVER	178
REAR SET CONTROL KIT	179
LICENSE PLATE SUPPORT "FOX"	179
CLUTCH COVER	180
LEFT SIDE COVER	180
SPROCKET COVER	180
HANDLEBARS (UNIVERSAL)	64
GRIPS Ø 22 mm (UNIVERSAL)	56
HANDLEBAR CAPS (UNIVERSAL)	60
RIDER/PASSENGER PEGS KIT	90
MIRRORS (UNIVERSAL)	10
INDICATOR LIGHTS (UNIVERSAL)	44
ENGINE OIL FILLER CAPS (UNIVERSAL)	73
BIKE STAND SUPPORT (PAIR)	92



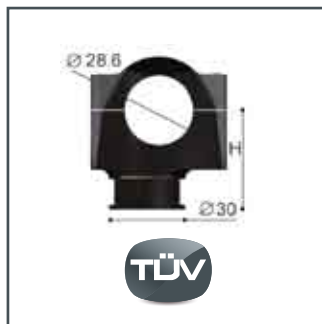

CONICAL HANDLEBAR CLAMPS

MODEL	YEAR	CODE	ALTEZZA	COLOR	€ (PAIR)
990 SUPER DUKE R	07>	AZ402B	42mm	●	
990 SUPER DUKE	05>	AZ402B	42mm	●	
990 SUPER DUKE R	07>	AZ403B	60mm	●	
990 SUPER DUKE	05>	AZ403B	60mm	●	

Conical handlebars at page 65



PROGUARD SYSTEM®

RIGHT

○	●	●	€
LP011A	LP011B	LP011G	

LEFT

○	●	●	€
LP012A	LP012B	LP012G	

MORE INFORMATIONS AT PAGE 52



design registration # 524939

BRAKE/CLUTCH LEVERS

MODEL	YEAR	BRAKE LEVER				CLUTCH LEVER			
		○	●	●	€	○	●	●	€
990 SUPER DUKE R	07>	LB500A	LB500B	LB500G		LC675A	LC675B	LC675G	
990 SUPER DUKE	05>	LB500A	LB500B	LB500G		LC675A	LC675B	LC675G	

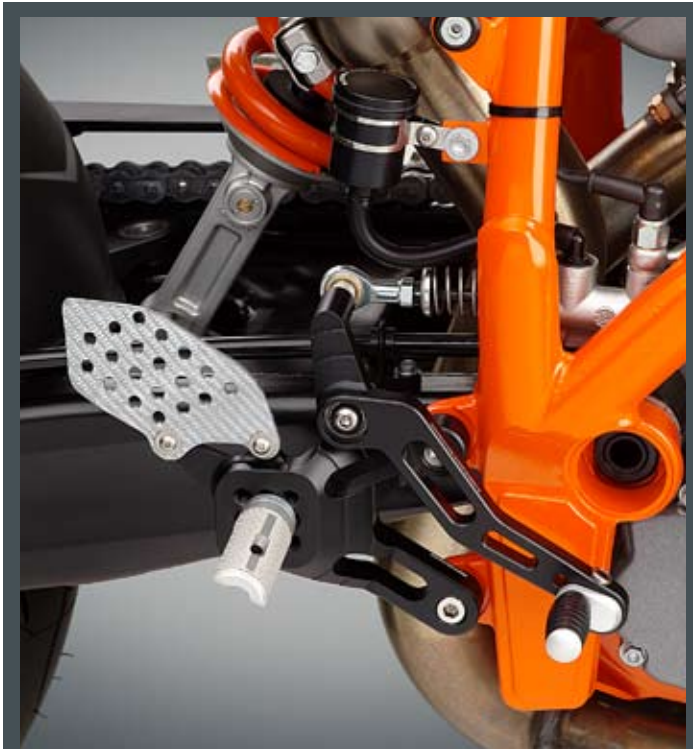

REAR SET CONTROL KIT

info

Technical Information for PE470B

Upward adjustment	10>20mm
Backward adjustment	10>20mm
Diagonal adjustment	10>20mm
Compatibility with folding pegs PE608A	NO
Reversed gear change lever:	NO



MODEL	YEAR	CODE	COLOR	€
990 SUPER DUKE R	07>	PE470B	●	
990 SUPER DUKE	05>	PE470B	●	



LICENSE PLATE SUPPORT "FOX"

MODEL	YEAR	CODE	COLOR	€
990 SUPER DUKE	05>07	PT675B	●	
990 SUPER DUKE R	07>08	PT676B	●	



design registration # 524939

KTM® 990 SUPER DUKE

MODEL	YEAR	CODE	COLOR	€
990 SUPER DUKE R	07>	ZMD001A	○	
990 SUPER DUKE	05>	ZMD001A	○	



CLUTCH COVER

MODEL	YEAR	CODE	COLOR	€
990 SUPER DUKE R	07>	ZMD003B	○	
990 SUPER DUKE	05>	ZMD003B	○	



LEFT SIDE COVER

MODEL	YEAR	CODE	COLOR	€
990 SUPER DUKE R	07>	ZMD005B	○	
990 SUPER DUKE	05>	ZMD005B	○	



SPROCKET COVER





unlimited passion

APPLICATION LIST

REAR SET CONTROL KIT	184
PROGUARD SYSTEM®	185
LICENSE PLATE SUPPORT "FOX"	185
HANDLEBARS (UNIVERSAL)	64
GRIPS Ø 22 mm (UNIVERSAL)	56
HANDLEBAR CAPS (UNIVERSAL)	60
RIDER/PASSENGER PEGS KIT	90
ENGINE GUARD	78
MIRRORS (UNIVERSAL)	10
INDICATOR LIGHTS (UNIVERSAL)	44
ENGINE OIL FILLER CAPS (UNIVERSAL)	76
BIKE STAND SUPPORT (PAIR)	92





REAR SET CONTROL KIT

MODEL	YEAR	CODE	COLOR	€
BRUTALE 750	03>05	PE430B	●	
BRUTALE 910	05>08	PE430B	●	
BRUTALE 989R	08>	PE430B	●	
BRUTALE 1078R	08>	PE430B	●	
F4 750	99>03	PE430B	●	
F4 1000	04>	PE430B	●	



PROGUARD SYSTEM®

RIGHT

○	●	●	€
LP011A	LP011B	LP011G	

LEFT

○	●	●	€
LP012A	LP012B	LP012G	

MORE INFORMATIONS AT PAGE 52



LICENSE PLATE SUPPORT "FOX"

MODEL	YEAR	CODE	COLOR	€
BRUTALE 750	03>05	PT600B	●	
BRUTALE 910	05>08	PT600B	●	
BRUTALE 989R	08>	PT600B	●	
BRUTALE 1078R	08>	PT600B	●	



design registration # 524939

ENGINE GUARD

MODEL	YEAR	CODE	COLOR	€ (PAIR)
BRUTALE 750	03>05	PM430B	●	
BRUTALE 910	05>08	PM430B	●	





compact power

APPLICATION LIST

REAR SET CONTROL KIT	188
BRAKE LEVER	188
CLUTCH LEVER	188
PROGUARD SYSTEM®	189
LICENSE PLATE SUPPORT "FOX"	189
CLUTCH REGISTER COVER WITH SAFETY GUARD	190
CHAIN ADJUSTER	190
TOE GUARD	190
ENGINE GUARDS	191
INDICATOR LIGHT ADAPTERS	192
RIDER/ PASSENGER RACING PEGS	90
GRIPS Ø 22 mm (UNIVERSAL)	56
HANDLEBAR CAPS (UNIVERSAL)	60
MIRRORS MOD. SENZA FRECCIA NELLO SPECCHIO	10
FRONT BRAKE FLUID TANK/CAP (UNIVERSAL)	70
REAR BRAKE FLUID TANK/CAP (UNIVERSAL)	70
ENGINE OIL FILLER CAPS (UNIVERSAL)	76
BIKE STAND SUPPORT (PAIR)	92



info

Technical Information for PE165B

Upward adjustment	10>20mm
Backward adjustment	10>20mm
Diagonal adjustment	10>20mm
Compatibility with folding pegs PE608A	YES
Reversed gear change lever:	*YES

* Use the OEM lever – See mounting instructions



MODEL	YEAR	CODE	COLOR	€
GSX R600/750	08>	PE165B	●	
GSX R600/750	06>07	PE165B	●	



REAR SET CONTROL KIT

take a look

see p. 44-51



design registration # 524939



BRAKE LEVER

MODEL	YEAR	BRAKE LEVER			€
		○	●	●	
GSX R600/750	08>	LB400A	LB400B	LB400G	
GSX R600/750	06>07	LB400A	LB400B	LB400G	

CLUTCH LEVER

MODEL	YEAR	CLUTCH LEVER			€
		○	●	●	
GSX R600/750	08>	LC200A	LC200B	LC200G	
GSX R600/750	06>07	LC200A	LC200B	LC200G	



PROGUARD SYSTEM®

RIGHT

○	●	●	€
LP011A	LP011B	LP011G	

LEFT

○	●	●	€
LP012A	LP012B	LP012G	

MORE INFORMATIONS AT PAGE 52



LICENSE PLATE SUPPORT "FOX"

MODEL	YEAR	CODE	COLOR	€
GSX R600/750	08>	PT405B	●	
GSX R600/750	06>07	PT403B	●	



design registration # 524939

MODEL	YEAR	CODE	COLOR	€
GSX R600/750	08>	ZSS008A	○	
GSX R600/750	08>	ZSS008B	●	
GSX R600/750	08>	ZSS008G	●	
GSX R600/750	08>	ZSS008R	●	
GSX R600/750	08>	ZSS008U	●	

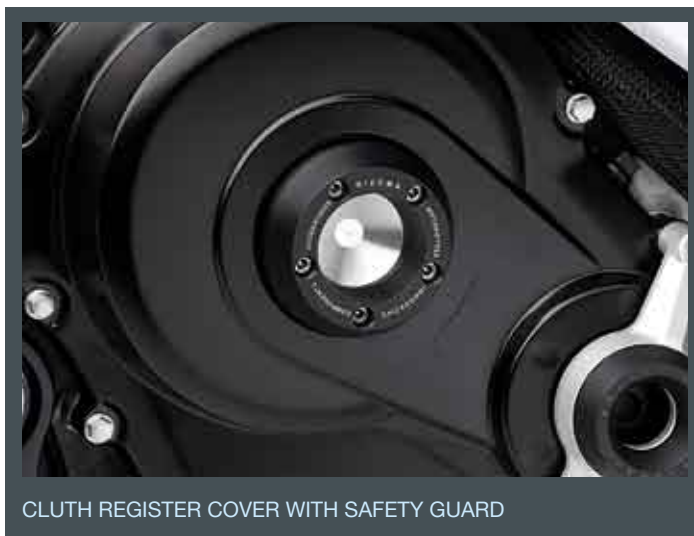

CLUTH REGISTER COVER WITH SAFETY GUARD

MODEL	YEAR	CODE	COLOR	€ (PAIR)
GSX R600/750	08>	TC040G	●	

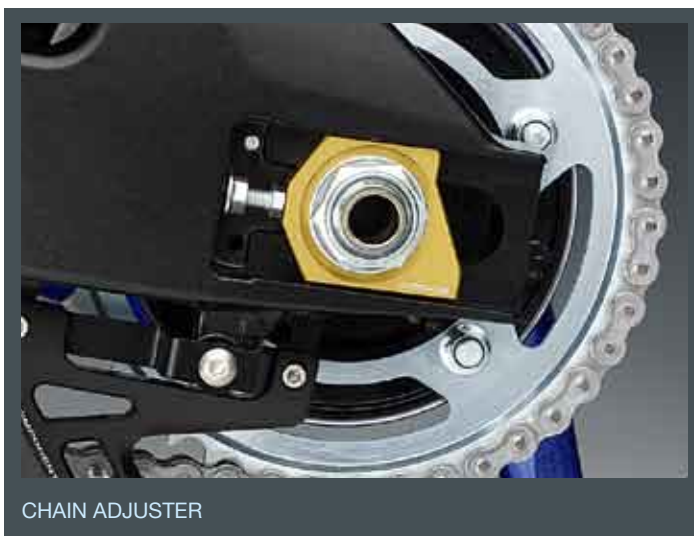

CHAIN ADJUSTER

MODEL	YEAR	CODE	COLOR	€
GSX R600/750	08>	FG050B	●	



TOE PROTECTION



ENGINE PROTECTION (RIGHT SIDE)

MODEL	YEAR	CODE	COLOR	€
GSX R600/750	06>	PM541A	○	



ENGINE PROTECTION (LEFT SIDE)

MODEL	YEAR	CODE	COLOR	€
GSX R600/750	06 >	PM540A	○	

FAIRING GUARD

MODEL	YEAR	CODE	COLOR	€ (PAIR)
GSX R600/750	08>	PM162B	●	
GSX R600/750	06>07	PM162B	●	
GSX R600/750	04>05	PM159B	●	
GSX R600/750	01>03	PM159B	●	



INDICATOR LIGHT ADAPTERS

MODEL	YEAR	CODE	MATERIALE	€ (PAIR)
GSX R600/750	06>07	FR260H	INOX	

ENGINE OIL FILLER CAP M20x1.5

○	●	●	●	●	€
TP009A	TP009B	TP009G	TP009R	TP009U	



BIKE STAND SUPPORT M8x35

○	●	●	●	●	€ (PAIR)
SC020A	SC020B	SC020G	SC020R	SC020U	





SUZUKI® GSX R1000



legendary class

APPLICATION LIST

REAR SET CONTROL KIT	196
LICENSE PLATE SUPPORT "FOX"	196
BRAKE LEVER	197
CLUTCH LEVER	197
PROGUARD SYSTEM®	197
FAIRING GUARD	197
INDICATOR LIGHT ADAPTERS	197
HANDLEBAR CAPS (UNIVERSAL)	60
MIRRORS	10
GRIPS Ø 22 mm (UNIVERSAL)	56
FRONT BRAKE FLUID TANK/CAP (UNIVERSAL)	70
REAR BRAKE FLUID TANK/CAP (UNIVERSAL)	70
ENGINE OIL FILLER CAPS (UNIVERSAL)	76
BIKE STAND SUPPORT (PAIR) (UNIVERSAL)	92



info

Technical Information for PE161B/PE159B

Upward adjustment	10>20mm
Backward adjustment	10>20mm
Diagonal adjustment	10>20mm
Compatibility with folding pegs PE608A	YES
Reversed gear change lever:	NO



MODEL	YEAR	CODE	COLOR	€
GSX R1000	07>08	PE161B	●	
GSX R1000	05>06	PE159B	●	



REAR SET CONTROL KIT



LICENSE PLATE SUPPORT "FOX"

MODEL	YEAR	CODE	COLOR	€
GSX R1000	07>08	PT402B	●	
GSX R1000	05>06	PT402B	●	
GSX R1000	03>04	PT400B	●	



design registration # 524939

BRAKE LEVER

MODEL	YEAR	BRAKE LEVER			
		○	●	●	€
GSX R1000	07>08	LB400A	LB400B	LB400G	
GSX R1000	05>06	LB400A	LB400B	LB400G	

CLUTCH LEVER

MODEL	YEAR	CLUTCH LEVER			
		○	●	●	€
GSX R1000	07>08	LC400A	LC400B	LC400G	
GSX R1000	05>06	LC200A	LC200B	LC200G	



design registration # 524939



LC400



LC200



PROGUARD SYSTEM®

RIGHT

○	●	●	€
LP011A	LP011B	LP011G	

LEFT

○	●	●	€
LP012A	LP012B	LP012G	

MORE INFORMATIONS AT PAGE 52

FAIRING GUARD

MODEL	YEAR	CODE	COLOR	€ (PAIR)
GSX R1000	07>08	PM164B	●	
GSX R1000	05>06	PM160B	●	
GSX R1000	03>04	PM159B	●	
GSX R1000	01>02	PM159B	●	

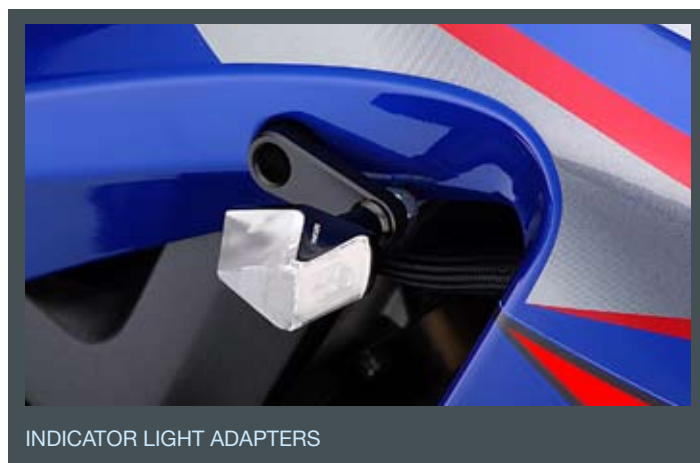

INDICATOR LIGHT ADAPTERS

MODEL	YEAR	CODE	COLOR	€ (PAIR)
GSX R1000	07>08	FR262B	●	



design registration # 524939



BRAKE LEVER

MODEL	YEAR	BRAKE LEVER			
		○	●	●	€
GSX R1000	07>08	LB400A	LB400B	LB400G	
GSX R1000	05>06	LB400A	LB400B	LB400G	

CLUTCH LEVER

MODEL	YEAR	CLUTCH LEVER			
		○	●	●	€
GSX R1000	07>08	LC400A	LC400B	LC400G	
GSX R1000	05>06	LC200A	LC200B	LC200G	



PROGUARD SYSTEM®

RIGHT

○	●	●	€
LP011A	LP011B	LP011G	

LEFT

○	●	●	€
LP012A	LP012B	LP012G	

MORE INFORMATIONS AT PAGE 52

FAIRING GUARD

MODEL	YEAR	CODE	COLOR	€ (PAIR)
GSX R1000	07>08	PM164B	●	
GSX R1000	05>06	PM160B	●	
GSX R1000	03>04	PM159B	●	
GSX R1000	01>02	PM159B	●	

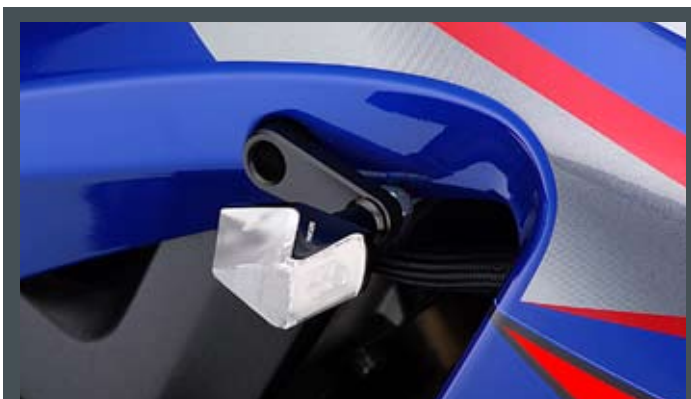

INDICATOR LIGHT ADAPTERS

MODEL	YEAR	CODE	COLOR	€ (PAIR)
GSX R1000	07>08	FR262B	●	

TRIUMPH® SPEED TRIPLE



power & aesthetics

TRIUMPH® SPEED TRIPLE

APPLICATION LIST

CLIP-ON BARS KIT	200
CONICAL HANDLEBAR ADAPTERS	200
BRAKE LEVER	201
CLUTCH LEVER	201
PROGUARD SYSTEM®	201
REAR SET CONTROL KIT	201
UNDERTAIL	202
LICENSE PLATE SUPPORT "FOX"	202
SPROCKET COVER	203
HUB SAFETY COVER (PAIR)	203
ENGINE GUARDS	204
CRANKCASE	204
HANDLEBARS (UNIVERSAL)	64
GRIPS Ø 22 mm (UNIVERSAL)	56
HANDLEBAR CAPS (UNIVERSAL)	60
RIDER/PASSENGER PEGS KIT	90
MIRRORS (UNIVERSAL)	10
INDICATOR LIGHTS (UNIVERSAL)	44
ENGINE OIL FILLER CAPS (UNIVERSAL)	76
BIKE STAND SUPPORT (PAIR) (UNIVERSAL)	92



TRIUMPH® SPEED TRIPLE



CLIP-ON BARS KIT

MODEL	YEAR	CODE	COLOR	€
SPEED TRIPLE	05>	MA202B	●	

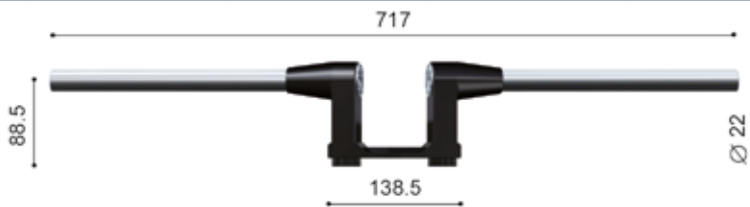

CONICAL HANDLEBAR ADAPTERS

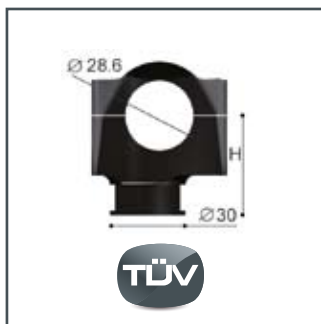

MODEL	YEAR	CODE	HEIGHT	COLOR	€ (PAIR)
SPEED TRIPLE	02>	AZ402B	42mm	●	
SPEED TRIPLE	02>	AZ403B	60mm	●	

Conical handlebars at page 65



design registration # 524939



take a look

see p. 56-59



BRAKE LEVER

MODEL	YEAR	BRAKE LEVER			
		○	●	●	€
SPEED TRIPLE	08>	LB400A	LB400B	LB400G	
SPEED TRIPLE	05>07	LB100A	LB100B	LB100G	

CLUTCH LEVER

MODEL	YEAR	CLUTCH LEVER			
		○	●	●	€
SPEED TRIPLE	08>	LC801A	LC801B	LC801G	
SPEED TRIPLE	05>07	LC801A	LC801B	LC801G	



PROGUARD SYSTEM®

RIGHT

○	●	●	€
LP011A	LP011B	LP011G	

LEFT

○	●	●	€
LP012A	LP012B	LP012G	

MORE INFORMATIONS AT PAGE 52

info

Technical Information for PE450B

Upward adjustment	10>20mm
Backward adjustment	10>20mm
Diagonal adjustment	10>20mm
Compatibility with folding pegs PE608A	YES
Reversed gear change lever:	NO



MODEL	YEAR	CODE	COLOR	€
SPEED TRIPLE	08>	PE450B	●	
SPEED TRIPLE	05>07	PE450B	●	
SPEED TRIPLE	02>04	PE450B	●	

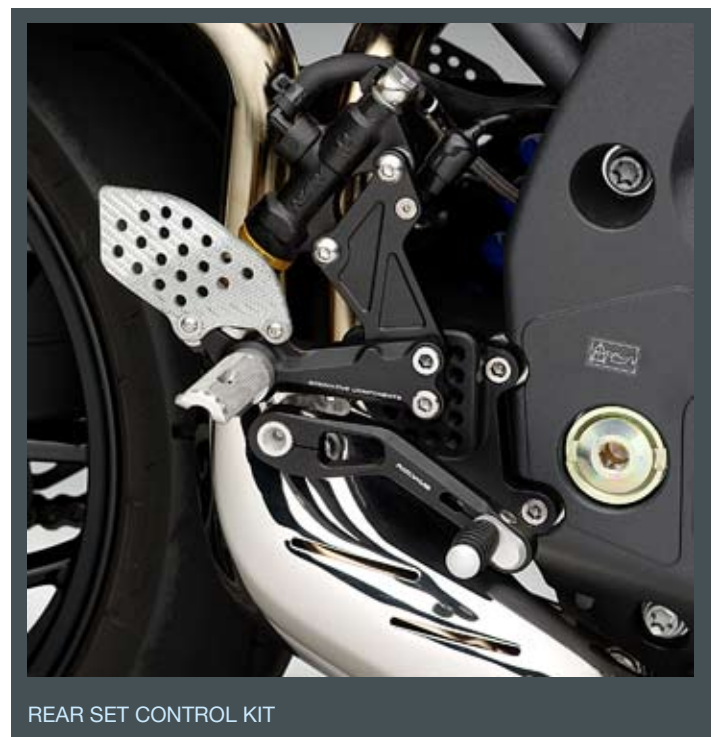

REAR SET CONTROL KIT

TRIUMPH® SPEED TRIPLE



UNDERTAIL

MODEL	YEAR	CODE	€
SPEED TRIPLE	08>	ZTH021K	

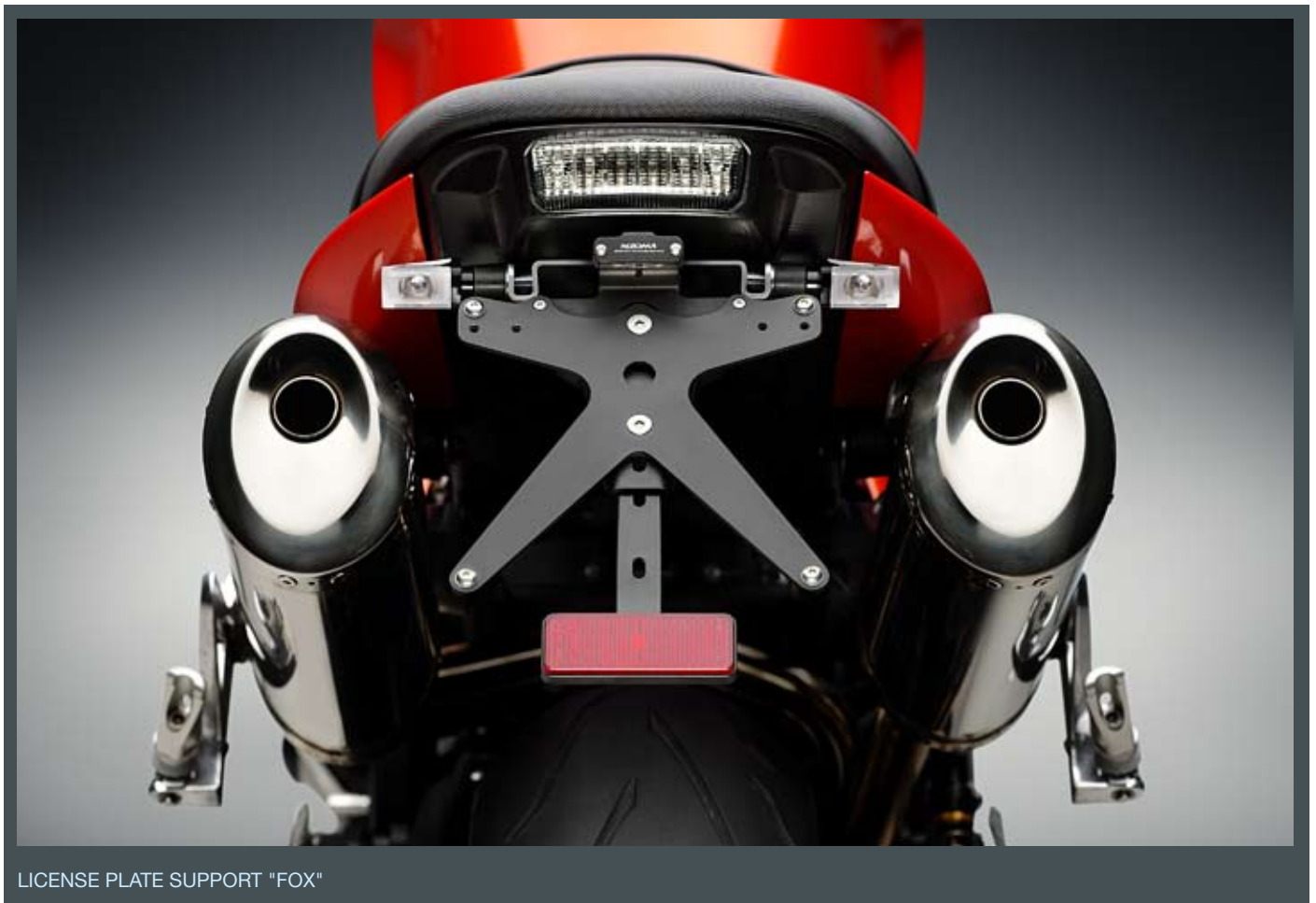

LICENSE PLATE SUPPORT "FOX"

MODEL	YEAR	CODE	COLOR	€
SPEED TRIPLE	08>	PT652B*	●	
SPEED TRIPLE	05>07	PT650B	●	



design registration # 524939

*MOUNTABLE ON OURTAIL UNIT ZTH021K



SPROCKET COVER

MODEL	YEAR	CODE	COLOR	€
SPEED TRIPLE	08>	ZTH011A	○	
SPEED TRIPLE	05>07	ZTH011A	○	
SPEED TRIPLE	02>04	ZTH011A	○	



HUB SAFETY COVER (KIT)



MODEL	YEAR	CODE	COLOR	€ (PAIR)
SPEED TRIPLE	08>	ZTH020A	○	
SPEED TRIPLE	05>07	ZTH020A	○	

TRIUMPH® SPEED TRIPLE

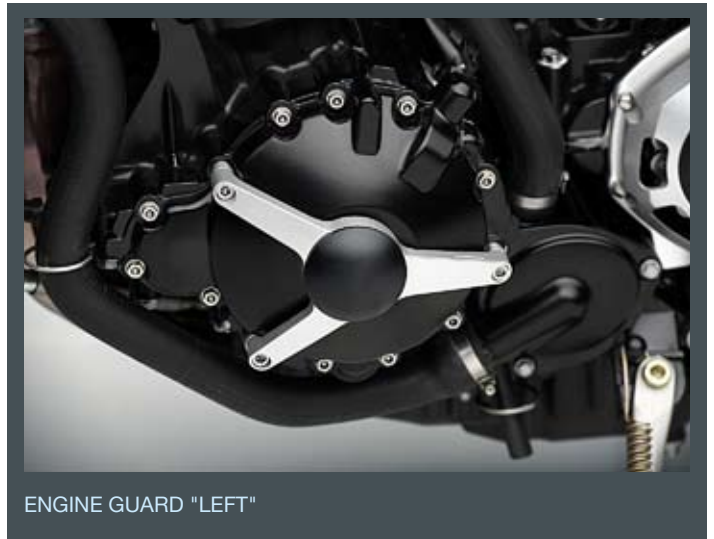

ENGINE GUARD "LEFT"

MODEL	YEAR	CODE	COLOR	€
SPEED TRIPLE	08>	PM530A	●	



ENGINE GUARD

MODEL	YEAR	CODE	COLOR	€ (PAIR)
SPEED TRIPLE	02>	PM250B	●	



MODEL	YEAR	CODE	COLOR	€
SPEED TRIPLE	05>	ZHH052A	○	
SPEED TRIPLE	05>	ZHH052B	●	
SPEED TRIPLE	05>	ZHH052G	●	
SPEED TRIPLE	05>	ZHH052R	●	
SPEED TRIPLE	05>	ZHH052U	●	

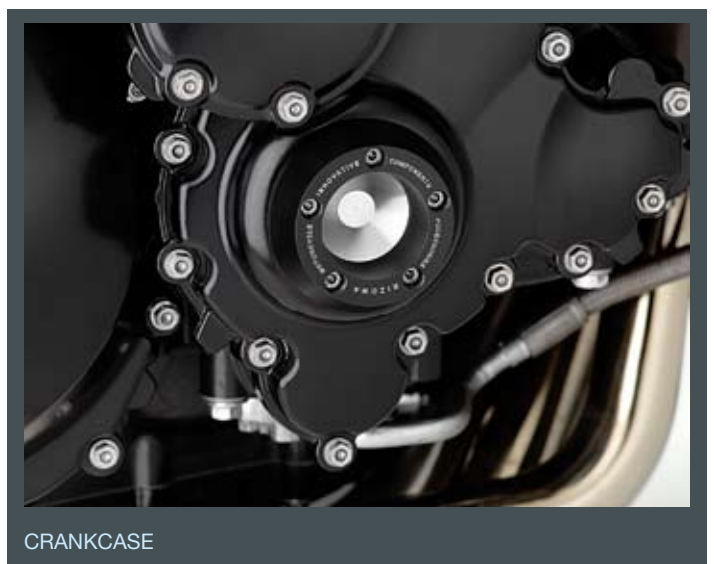

CRANKCASE



TRIUMPH® STREET TRIPLE



modern & stylish

TRIUMPH® STREET TRIPLE

APPLICATION LIST

CONICAL HANDLEBAR CLAMPS	208
BRAKE LEVER	208
CLUTCH LEVER	208
PROGUARD SYSTEM®	208
LICENSE PLATE SUPPORT "FOX"	209
FAIRING GUARD	209
RIDER/PASSENGER PEGS	209
HANDLEBARS (UNIVERSAL)	64
GRIPS D.22 MM (UNIVERSAL)	56
HANDLEBAR CAPS (UNIVERSAL)	60
MIRRORS	10
INDICATOR LIGHTS (UNIVERSAL)	44
REAR BRAKE FLUID TANK/CAP (UNIVERSAL)	70
ENGINE OIL FILLER CAPS (UNIVERSAL)	76
BIKE STAND SUPPORT (PAIR) (UNIVERSAL)	92



TRIUMPH® STREET TRIPLE



CONICAL HANDLEBAR ADAPTERS

MODEL	YEAR	CODE	HEIGHT	COLOR	€ (PAIR)
STREET TRIPLE	07>	AZ402B	42mm	●	
STREET TRIPLE	07>	AZ403B	60mm	●	



Conical handlebars at page 65

BRAKE LEVER

MODEL	YEAR	BRAKE LEVER			€
		○	●	●	
STREET TRIPLE	07>	LB100A	LB100B	LB100G	

CLUTCH LEVER

MODEL	YEAR	CLUTCH LEVER			€
		○	●	●	
STREET TRIPLE	07>	LC801A	LC801B	LC801G	



design registration # 524939



PROGUARD SYSTEM®

RIGHT

○	●	●	€
LP011A	LP011B	LP011G	

LEFT

○	●	●	€
LP012A	LP012B	LP012G	



MORE INFORMATIONS AT PAGE 52



LICENSE PLATE SUPPORT "FOX"

MODEL	YEAR	CODE	COLOR	€
STREET TRIPLE	07>	PT651B	●	



design registration # 524939



ENGINE GUARD

MODEL	YEAR	CODE	COLOR	€ (PAIR)
STREET TRIPLE	07>	PM510B	●	

RIDER/PASSENGER PEGS

MODEL	YEAR	○	●	●	●	●	€
STREET TRIPLE	ALL	PE614A	PE614B	PE614G	PE614R	PE614U	

Adapters are required
RIDER PEG ADAPTERS

MODEL	YEAR	CODE	COLOR	€
STREET TRIPLE	07>	PE760A	○	

PASSENGER PEG ADAPTERS

MODEL	YEAR	CODE	COLOR	€
STREET TRIPLE	07>	PE762A	○	





sophisticated sense



APPLICATION LIST

REAR SET CONTROL KIT	212
LICENSE PLATE SUPPORT "FOX"	212
BRAKE LEVER	213
CLUTCH LEVER	213
PROGUARD SYSTEM®	213
FAIRING GUARD	214
TOE GUARD	214
CHAIN ADJUSTER	214
INDICATOR LIGHT ADAPTERS	214
RIDER/ PASSENGER RACING PEGS	90
GRIPS D.22 MM (UNIVERSAL)	56
HANDLEBAR CAPS (UNIVERSAL)	60
MIRRORS (UNIVERSAL)	10
INDICATOR LIGHTS (UNIVERSAL)	44
FRONT BRAKE FLUID TANK/CAP (UNIVERSAL)	70
CLUTCH FLUID TANK/CAP (UNIVERSAL)	70
ENGINE OIL FILLER CAPS (UNIVERSAL)	76
BIKE STAND SUPPORT (PAIR) (UNIVERSAL)	92



design registration # 524939



BRAKE LEVER

MODEL	YEAR	BRAKE LEVER			€
		○	●	●	
YZF-R6	06>	LB201A	LB201B	LB201G	

CLUTCH LEVER

MODEL	YEAR	CLUTCH LEVER			€
		○	●	●	
YZF-R6	06>	LC200A	LC200B	LC200G	

take a look



see p. 10-95



PROGUARD SYSTEM®

RIGHT

○	●	●	€
LP011A	LP011B	LP011G	

LEFT

○	●	●	€
LP012A	LP012B	LP012G	

MORE INFORMATIONS AT PAGE 52



design registration # 524939



BRAKE LEVER

MODEL	YEAR	BRAKE LEVER			€
		○	●	●	
YZF-R6	06>	LB201A	LB201B	LB201G	

CLUTCH LEVER

MODEL	YEAR	CLUTCH LEVER			€
		○	●	●	
YZF-R6	06>	LC200A	LC200B	LC200G	

take a look



see p. 10-95



PROGUARD SYSTEM®

RIGHT

○	●	●	€
LP011A	LP011B	LP011G	

LEFT

○	●	●	€
LP012A	LP012B	LP012G	

MORE INFORMATIONS AT PAGE 52

MODEL	YEAR	CODE	COLOR	€ (PAIR)
YZF-R6	08>	PM210B	●	
YZF-R6	06>07	PM207B	●	
YZF-R6	03>05	PM205B	●	

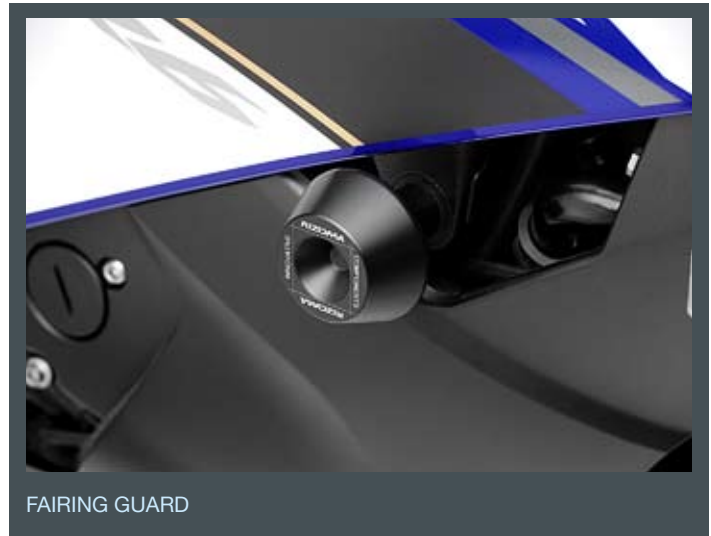

MODEL	YEAR	CODE	COLOR	€
YZF-R6	06>	FG020B	●	



MODEL	YEAR	CODE	COLOR	€ (PAIR)
YZF-R6	06>	TC010G	●	

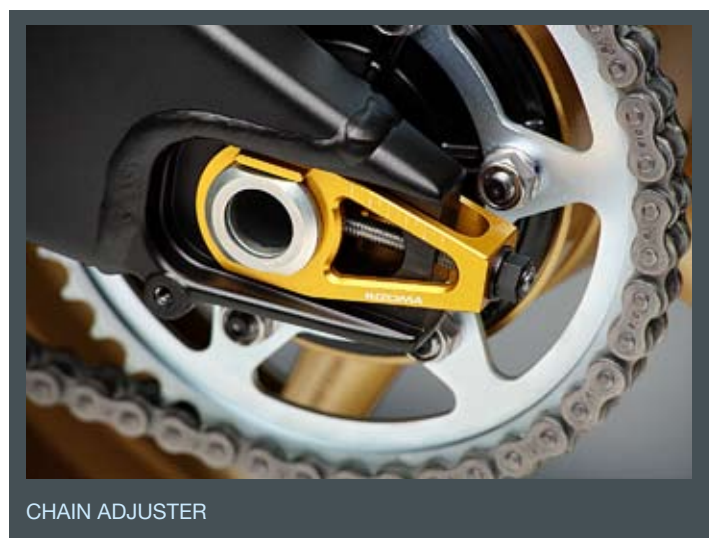

LICENSE PLATE SUPPORT "FOX" INDICATOR LIGHT ADAPTERS

MODEL	YEAR	CODE	COLOR	€ (PAIR)
YZF-R6	06>07	FR270H	●	







absolute power

APPLICATION LIST

REAR SET CONTROL KIT	218
LICENSE PLATE SUPPORT "FOX"	218
BRAKE LEVER	219
CLUTCH LEVER	219
PROGUARD SYSTEM®	219
FAIRING GUARD	219
GRIPS Ø 22 mm (UNIVERSALI)	56
HANDLEBAR CAPS (UNIVERSALI)	60
RIDER/ PASSENGER RACING PEGS	90
MIRRORS (UNIVERSALI)	10
FRONT INDICATOR LIGHTS(UNIVERSALI)	44
ENGINE OIL CAPS (UNIVERSALI)	76
BIKE STAND SUPPORT (PAIR) (UNIVERSALI)	92





design registration # 524939

take a look

see universal accessories p. 55-59



BRAKE LEVER

MODEL	YEAR	BRAKE LEVER			
		○	●	●	€
YZF-R1	07>08	LB201A	LB201B	LB201G	
YZF-R1	04>06	LB201A	LB201B	LB201G	

CLUTCH LEVER

MODEL	YEAR	CLUTCH LEVER			
		○	●	●	€
YZF-R1	07>08	LC200A	LC200B	LC200G	
YZF-R1	04>06	LC200A	LC200B	LC200G	



PROGUARD SYSTEM®

RIGHT

○	●	●	€
LP011A	LP011B	LP011G	

LEFT

○	●	●	€
LP012A	LP012B	LP012G	

MORE INFORMATIONS AT PAGE 52



FAIRING GUARD

MODEL	YEAR	CODE	COLOR	€ (PAIR)
YZF-R1	07>08	PM209B	●	
YZF-R1	04>06	PM206B	●	
YZF-R1	02>03	PM205B	●	



design registration # 524939

take a look

see universal accessories p. 55-59



BRAKE LEVER

MODEL	YEAR	BRAKE LEVER			
		○	●	●	€
YZF-R1	07>08	LB201A	LB201B	LB201G	
YZF-R1	04>06	LB201A	LB201B	LB201G	

CLUTCH LEVER

MODEL	YEAR	CLUTCH LEVER			
		○	●	●	€
YZF-R1	07>08	LC200A	LC200B	LC200G	
YZF-R1	04>06	LC200A	LC200B	LC200G	



PROGUARD SYSTEM®

RIGHT

○	●	●	€
LP011A	LP011B	LP011G	

LEFT

○	●	●	€
LP012A	LP012B	LP012G	

MORE INFORMATIONS AT PAGE 52



FAIRING GUARD

MODEL	YEAR	CODE	COLOR	€ (PAIR)
YZF-R1	07>08	PM209B	●	
YZF-R1	04>06	PM206B	●	
YZF-R1	02>03	PM205B	●	

YAMAHA® FZ1/FZ1 FAZER



original mind

YAMAHA® FZ1/FZ1 FAZER



CONICAL HANDLEBAR CLAMPS

MODEL	YEAR	CODE	HEIGHT	COLOR	€ (PAIR)
FZ1/FZ1 FAZER	06>	AZ402B	42mm	●	
FZ1/FZ1 FAZER	06>	AZ403B	60mm	●	

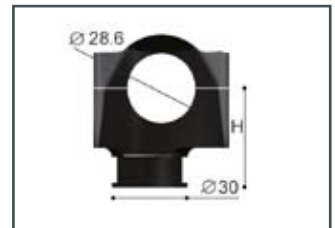

Conical handlebars at page 65



design registration # 524939



BRAKE LEVER

MODEL	YEAR	BRAKE LEVER			€
		○	●	●	
FZ1/FZ1 FAZER	06>	LB200A	LB200B	LB200G	

CLUTCH LEVER

MODEL	YEAR	CLUTCH LEVER			€
		○	●	●	
FZ1/FZ1 FAZER	06>	LC200A	LC200B	LC200G	



PROGUARD SYSTEM®

RIGHT

○	●	●	€
LP011A	LP011B	LP011G	

LEFT

○	●	●	€
LP012A	LP012B	LP012G	



MORE INFORMATIONS AT PAGE 52

YAMAHA® FZ1/FZ1 FAZER



CONICAL HANDLEBAR CLAMPS

MODEL	YEAR	CODE	HEIGHT	COLOR	€ (PAIR)
FZ1/FZ1 FAZER	06>	AZ402B	42mm	●	
FZ1/FZ1 FAZER	06>	AZ403B	60mm	●	

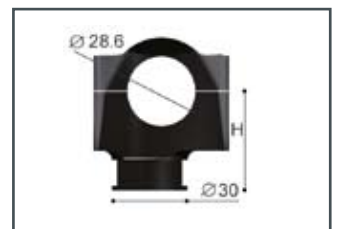

Conical handlebars at page 65



design registration # 524939



BRAKE LEVER

MODEL	YEAR	BRAKE LEVER			€
		○	●	●	
FZ1/FZ1 FAZER	06>	LB200A	LB200B	LB200G	

CLUTCH LEVER

MODEL	YEAR	CLUTCH LEVER			€
		○	●	●	
FZ1/FZ1 FAZER	06>	LC200A	LC200B	LC200G	



PROGUARD SYSTEM®

RIGHT

○	●	●	€
LP011A	LP011B	LP011G	

LEFT

○	●	●	€
LP012A	LP012B	LP012G	



MORE INFORMATIONS AT PAGE 52

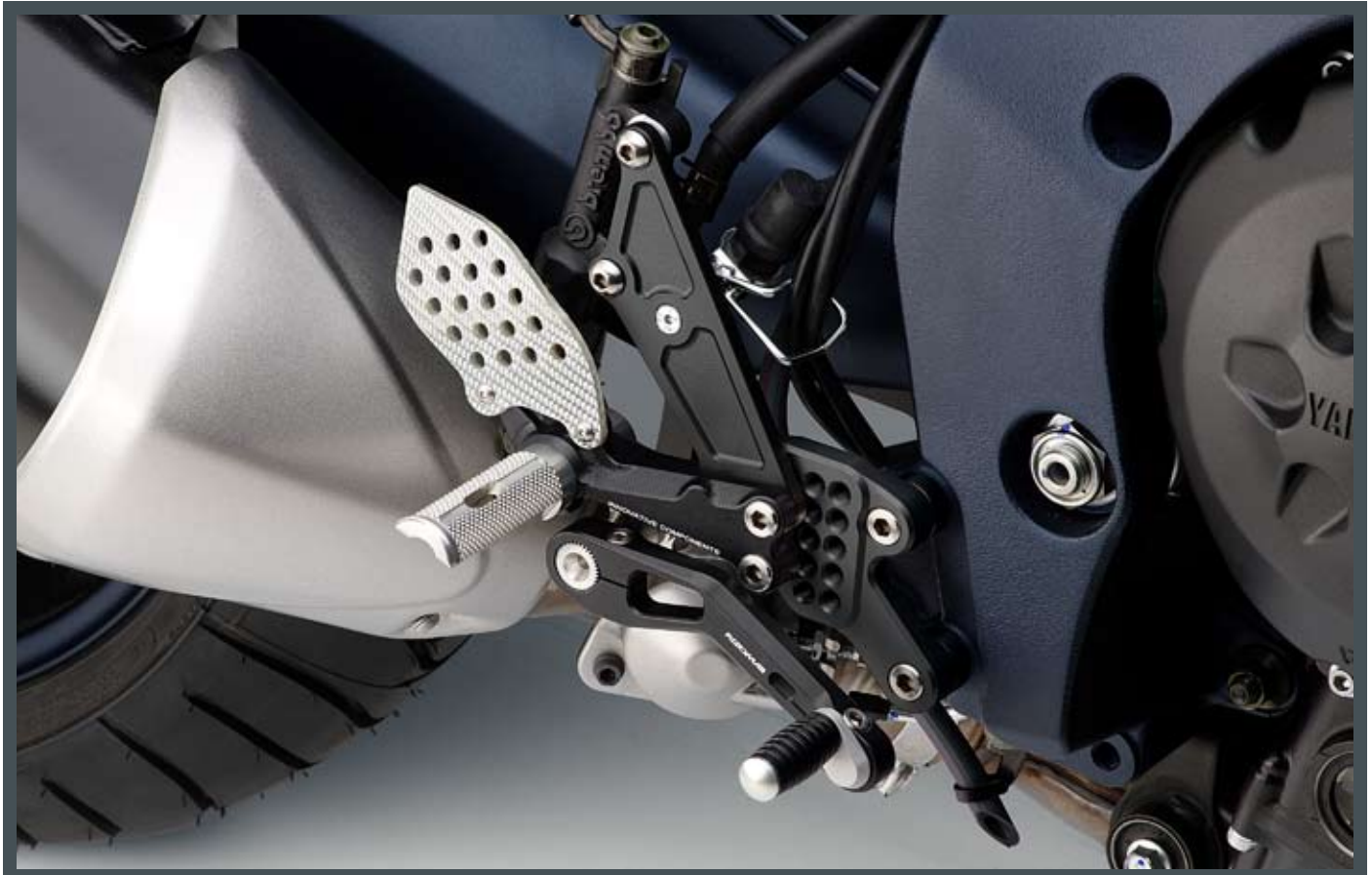

REAR SET CONTROL KIT

MODEL	YEAR	CODE	COLOR	€
FZ1/FZ1 FAZER	06>	PE112B	●	



LICENSE PLATE SUPPORT "FOX"

MODEL	YEAR	CODE	COLOR	€
FZ1	06>	PT205B	●	
FZ1 FAZER	06>	PT206B	●	



design registration # 524939

YAMAHA® FZ1/FZ1 FAZER



ENGINE GUARD

MODEL	YEAR	CODE	COLOR	€ (PAIR)
FZ1/FZ1 FAZER	06>	PM208B	●	



SIDE PANELS (RH, LH)

MODEL	YEAR	CODE	COLOR	€ (PAIR)
FZ1/FZ1 FAZER	06>	ZYF002A	○	



SPROCKET COVER

MODEL	YEAR	CODE	COLOR	€
FZ1/FZ1 FAZER	06>	ZYF001A	○	



CHAIN GUARD

MODEL	YEAR	CODE	COLOR	€
FZ1/FZ1 FAZER	06>	ZYF003A	○	



LICENSE PLATE SUPPORT "FOX"
STOCK INDICATOR LIGHT ADAPTERS (PAIR)

MODEL	YEAR	CODE	€ (PAIR)
FZ1/FZ1 FAZER	06>	FR270H	



active run

take a look

see p. 56-59

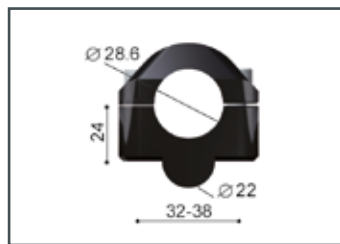

info

VITI INCLUSE: nr .04 M8x25



CONICAL HANDLEBAR ADAPTERS

MODEL	YEAR	CODE	HEIGHT	COLOR	€ (PAIR)
FZ6/FZ6 FAZER	06>	AZ405B	42mm	●	
FZ6/FZ6 FAZER	04>05	AZ405B	42mm	●	

Conical handlebars at page 65



design registration # 524939

BRAKE LEVER

MODEL	YEAR	BRAKE LEVER			€
		○	●	●	
FZ6/FZ6 FAZER	04>	LB200A	LB200B	LB200G	

CLUTCH LEVER

MODEL	YEAR	CLUTCH LEVER			€
		○	●	●	
FZ6/FZ6 FAZER	04>	LC200A	LC200B	LC200G	



PROGUARD SYSTEM®

RIGHT

○	●	●	€
LP011A	LP011B	LP011G	

LEFT

○	●	●	€
LP012A	LP012B	LP012G	

MORE INFORMATIONS AT PAGE 52

take a look

see p. 56-59

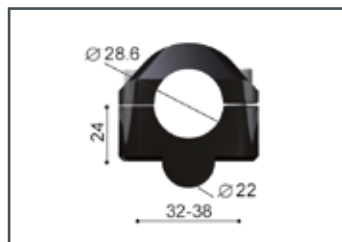

info

VITI INCLUSE: nr .04 M8x25



CONICAL HANDLEBAR ADAPTERS

MODEL	YEAR	CODE	HEIGHT	COLOR	€ (PAIR)
FZ6/FZ6 FAZER	06>	AZ405B	42mm	●	
FZ6/FZ6 FAZER	04>05	AZ405B	42mm	●	

Conical handlebars at page 65



design registration # 524939

BRAKE LEVER

MODEL	YEAR	BRAKE LEVER			€
		○	●	●	
FZ6/FZ6 FAZER	04>	LB200A	LB200B	LB200G	

CLUTCH LEVER

MODEL	YEAR	CLUTCH LEVER			€
		○	●	●	
FZ6/FZ6 FAZER	04>	LC200A	LC200B	LC200G	



PROGUARD SYSTEM®

RIGHT

○	●	●	€
LP011A	LP011B	LP011G	

LEFT

○	●	●	€
LP012A	LP012B	LP012G	

MORE INFORMATIONS AT PAGE 52



REAR SET CONTROL KIT

info

Technical Information for PE108B

Upward adjustment	10>20mm
Backward adjustment	10>20mm
Diagonal adjustment	10>20mm
Compatibility with folding pegs PE608A	YES
Reversed gear change lever:	NO



MODEL	YEAR	CODE	COLOR	€
FZ6/FZ6 FAZER	04>	PE108B	●	

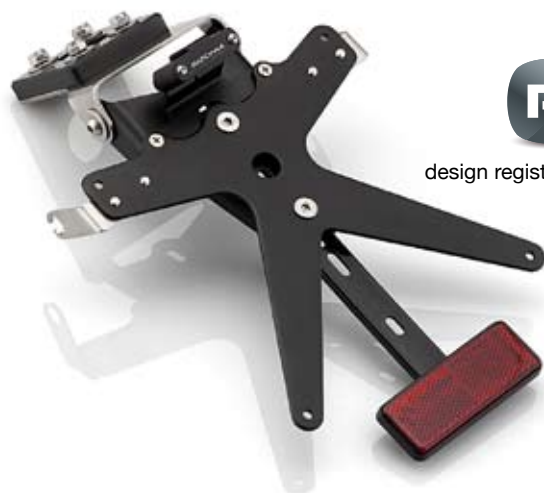

design registration # 524939

LICENSE PLATE SUPPORT "FOX"

MODEL	YEAR	CODE	COLOR	€
FZ6/FZ6 FAZER	04>	PT202B	●	

FAIRING GUARD

MODEL	YEAR	CODE	COLOR	€ (PAIR)
FZ6/FZ6 FAZER	04>	PM202B	●	



YAMAHA® MT-01



intense impression



info

RIZOMA® accessories for mt-01 are exclusively distributed by Yamaha® through its official dealers.





into the *spotlight*

APPLICATION LIST

HANDLEBAR AND INSTRUMENT HOLDER KIT	234
TRIPLE TREE KIT	234
HEADLIGHT PROTECTION	234
CHAIN GUARD	235
FRONT PULLEY COVER	235
FRONT PULLEY GUARD	235
PULLEY 72 TEETH	236
SHOCK ABSORBER COVERS (PAIR)	236
REAR SET CONTROL KIT	237
CONTROL KIT	237
LICENSE PLATE SUPPORT	238
HORN KIT	238
FRONT INDICATOR LIGHT ADAPTERS (PAIR)	238
MIRRORS	10
GRIPS	246
RISERS	247



MA204A



 design registration



HANDLEBAR AND INSTRUMENT HOLDER KIT

MODEL	YEAR	○	●	€
VRSCDX/VRSCD/VRSCX/VRSCAW/VRSCA/VRSCB	ALL	MA204A	MA204B	



TRIPLE TREE KIT

MODEL	YEAR	○	●	€
VRSCDX/VRSCD/VRSCX	ALL	PA370A	PA370B	
VRSCAW/VRSCA/VRSCB	ALL	PA370A	PA370B	

STOCK RAKE

MODEL	YEAR	○	€
VRSCDX/VRSCD/VRSCX	ALL	ZHD062AL	
VRSCAW/VRSCA/VRSCB	ALL	ZHD062AL	



HEADLIGHT PROTECTION



BELT GUARD

MODEL	YEAR	○	●	€
VRSCDX/VRSCD/VRSCX	ALL	ZHD067A	ZHD067B	
VRSCAW/VRSCA/VRSCB	ALL	ZHD067A	ZHD067B	



FRONT PULLEY COVER



MODEL	YEAR	○	●	●	€
VRSCDX/VRSCD/VRSCX/VRSCAW/VRSCA/VRSCB	ALL	ZHD061A	ZHD061B	ZHD061E	



FRONT PULLEY GUARD

MODEL	YEAR	○	●	€
VRSCDX/VRSCD/VRSCX/VRSCAW/VRSCA/VRSCB	ALL	ZHD063A	ZHD063B	



PULLEY 72 TEETH

MODEL	YEAR	○	●	€
VRSCDX/VRSCD/VRSCX/VRSCAW	ALL	ZHD065A	ZHD065B	

FITS ONLY 240 TIRE MODELS



SHOCK ABSORBER COVERS (PAIR)

MODEL	YEAR	●	€ (PAIR)
VRSCDX	06>	ZHD064B	

info

Technical Information for PE259B

Upward adjustment	10>20 mm
Backward adjustment	10>20 mm
Diagonal adjustment	10>20 mm



- master cylinder and fluid tank included



REAR SET CONTROL KIT

MODEL	YEAR	●	€
VRSCDX	06>	PE259B	
VRSCD*/VRSCX*	ALL	PE259B	
VRSCAW*/VRSCA*/VRSCB*	ALL	PE259B	

* DOESN'T FIT WITH OEM EXSHAUST SYSTEM



CONTROL KIT



MODEL	YEAR	●	●	€
VRSCDX/VRSCD/VRSCX	ALL	PE254B	PE254L	
VRSCAW/VRSCA/VRSCB	ALL	PE254B	PE254L	

PASSENGER PEGS:

PE601B, ●

PE601L, POLISHED

Adapters PE730A required



design registration # 524939

LICENSE PLATE SUPPORT "FOX"

MODEL	YEAR	●	€
VRSCDX/VRSCD/VRSCX/VRSCAW	07>	PT552B	
VRSCA	02>06	PT551B	
VRSCB	04>05	PT551B	

MODEL	YEAR	●	○	€
VRSCA	02>06	PT550B	PT550L	
VRSCB	04>05	PT550B	PT550L	

COMPLETE WITH LICENSE PLATE LIGHT AND REFLECTOR KIT

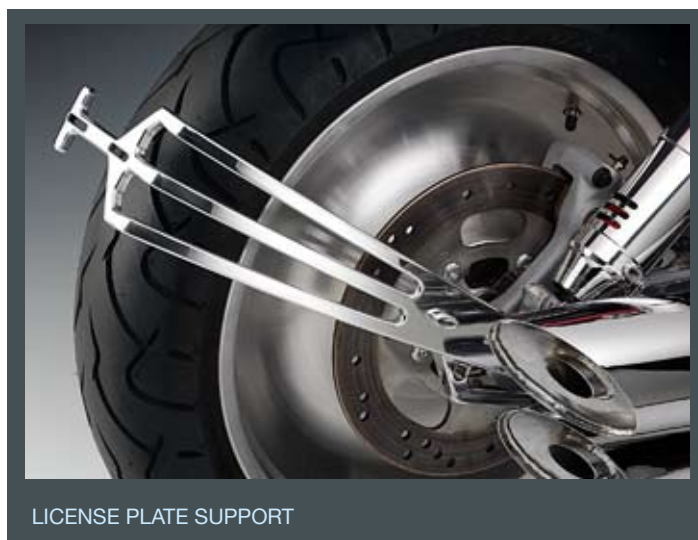

LICENSE PLATE SUPPORT

HORN KIT

MODEL	YEAR	●	€
VRSCDX/VRSCD/VRSCX/VRSCAW/VRSCA/VRSCB	ALL	ZHD066B	



FRONT INDICATOR LIGHT ADAPTERS (PAIR)

MODEL	YEAR	●	€
VRSCDX/VRSCD/VRSCX/VRSCAW/VRSCA/VRSCB	ALL	FR413B	



HARLEY-DAVIDSON® SPORTSTER®



sport addiction

APPLICATION LIST

HANDLEBAR AND INSTRUMENT HOLDER KIT	242
TRIPLE TREE KIT	242
FRONT INDICATOR LIGHT ADAPTERS	242
HEADLIGHT PROTECTION	243
CONTROL KIT	243
AIR FILTER KIT	243
DERBY COVER	244
FRONT PULLEY COVER	244
FRONT PULLEY GUARD	244
GAS CAP	245
CHAIN GUARD	245
WIRING COVER	245
MIRRORS	10
GRIPS	246





HANDLEBAR AND INSTRUMENT HOLDER KIT

MODEL	YEAR	○	●	€
XL883/XL883C/XL883L/XL883R	04>	MA205A	MA205B	
XL1200C/XL1200L/XL1200N/XL1200R	04>	MA205A	MA205B	



TRIPLE TREE KIT

MODEL	YEAR	○	●	€
XL883/XL883C/XL883L/XL883R	04>	PA380A	PA380B	
XL1200C/XL1200L/XL1200N/XL1200R	04>	PA380A	PA380B	

- Center to center distance 200mm
- Stock rake



FRONT INDICATOR LIGHT ADAPTERS

MODEL	YEAR	●	€ (PAIR)
XL883/XL883C/XL883L/XL883R	04>	FR413B	
XL1200C/XL1200L/XL1200N/XL1200R	04>	FR413B	





HEADLIGHT PROTECTION

MODEL	YEAR	●	€
XL883/XL883L/XL883R	04>	ZHD069AL	
XL1200L/XL1200N/XL1200R	04>	ZHD069AL	



CONTROL KIT



MODEL	YEAR	●	€
XL883/XL883L/XL883R	06>	PE260B	
XL1200L/XL1200N/XL1200R	06>	PE260B	



AIR FILTER KIT

MODEL	YEAR	●	€
XL883/XL883C/XL883L/XL883R	04>	ZHD070B	
XL1200C/XL1200L/XL1200N/XL1200R	04>	ZHD070B	

HI-FLOW FILTER ELEMENT INCLUDED



MODEL	YEAR	●	€
XL883/XL883C/XL883L/XL883R	04>	ZHD068B	
XL1200C/XL1200L/XL1200N/XL1200R	04>	ZHD068B	

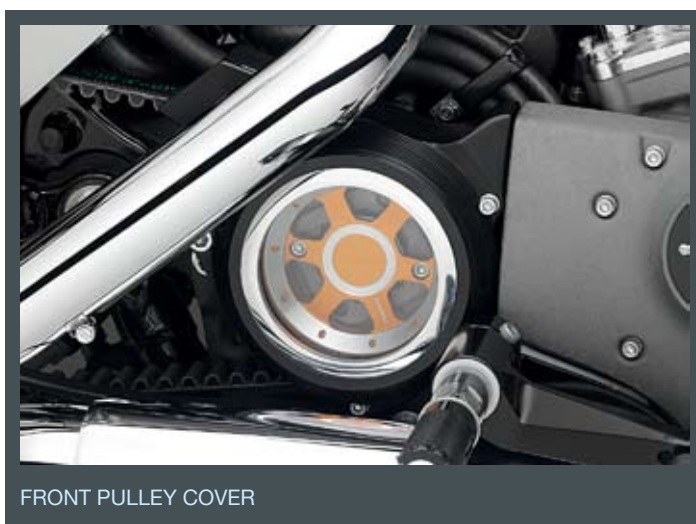

MODEL	YEAR	○	●	●	€
XL883/XL883C/XL883L/XL883R	04>	ZHD073A	ZHD073B	ZHD073E	
XL1200C/XL1200L/XL1200N/XL1200R	04>	ZHD073A	ZHD073B	ZHD073E	



FRONT PULLEY GUARD

MODEL	YEAR	○	●	€
XL883/XL883C/XL883L/XL883R	04>	ZHD074A	ZHD074B	
XL1200C/XL1200L/XL1200N/XL1200R	04>	ZHD074A	ZHD074B	



GAS CAP

MODEL	YEAR	○	€
XL883/XL883L/XL883R	04>	ZHD075A	
XL1200L/XL1200N/XL1200R	04>	ZHD075A	



CHAIN GUARD

MODEL	YEAR	○	●	€
XL883/XL883C	04>	ZHD071A	ZHD071B	
XL883L/XL883R	04>	ZHD071A	ZHD071B	
XL1200C/XL1200L	04>	ZHD071A	ZHD071B	
XL1200N/XL1200R	04>	ZHD071A	ZHD071B	



WIRING COVER

MODEL	YEAR	●	€
XL 1200N	07>	ZHD072B	

ACCESSORIES FOR CUSTOM ONLY

GRIPS CAN BE MOUNTED ON HANDLEBAR DIAMETER of 25.4mm (1 INCH)

design registration



GRIPS "CONTACT"

CODE	COLOR	€ (PAIR)
GR214A	○	

The grip with a more sporting aspect, thanks to the rubber inserts on the initial part especially studied for a better grip



design registration

GRIPS "CONTACT"

CODE	COLOR	€ (PAIR)
GR214B	●	

The grip with a more sporting aspect, thanks to the rubber inserts on the initial part especially studied for a better grip



design registration



GRIPS "BLACK PROFILE"

CODE	COLOR	€ (PAIR)
GR215B	●	





PULLBACK RISER

CODE	HEIGHT (H)	COLOR	€ (PAIR)
AZ014B	60 mm	●	
AZ016B	100 mm	●	
AZ018B	140 mm	●	

info

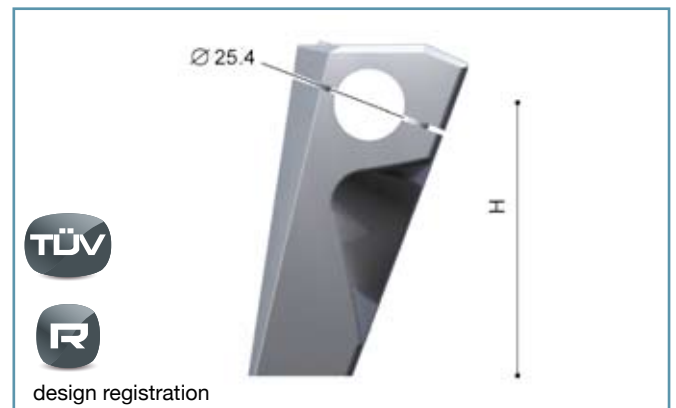

PULLBACK RISER

CODE	HEIGHT (H)	COLOR	€ (PAIR)
AZ014L	60 mm	●	
AZ016L	100 mm	●	
AZ018L	140 mm	●	

info

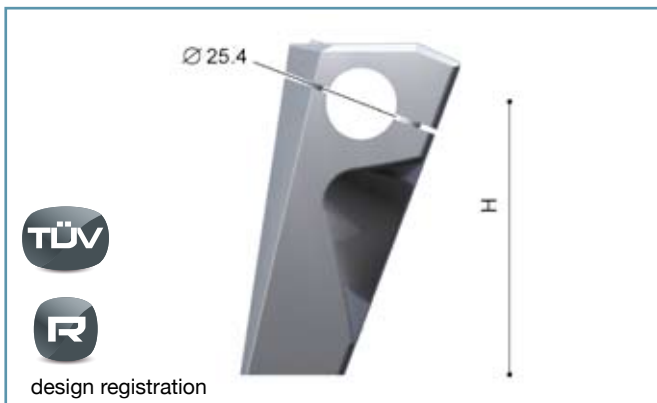

SYMBOLS KEYS



Products which have a TÜV-Approval included



Products which have a "E-Homologation" included



Accessories with design registration



Mirrors equipped with High-Quality "Blue Style" Mirror-Glasses, "amber" Mirror-Glass or convex mirror glass

CERTIFICATION & OMOLOGATION

The certification and homologation granted to a large number of our accessories constitute an essential phase of the production process: a certificate of conformity is a statement that assures the high level functionality and performance of a product.

An additional aesthetic type of approval certifies the unique and original design of our products and distinguishes even more our brand-name.

LEGAL NOTICE

Our products are assured as regards quality, resistance and durability. However, they are not approved for the road circulation in the countries where homologation is required.

Thus RIZOMA® srl declines any responsibility for a different use of its products and kindly asks all the dealers to inform their customers about these restrictions.

RIZOMA® srl has nothing to do with HONDA®, YAMAHA®, SUZUKI®, KAWASAKI®, KTM®, MV AGUSTA®, DUCATI®, HARLEY-DAVIDSON®, BUELL®, BMW®, TRIUMPH® trademarks or their dealers.

All the products with trademarks or motorcycle identification names are to be considered exclusively as references for the use of our accessories.